

WEST MOOR FARM, ARMTHORPE

Agricultural Land Classification

Agricultural Land			
Agricultural Grades		Agricultural Land Quality	Area within the site (ha.)
Grade 1		Excellent	Nil
Grade 2		Very Good	14.4
Grade 3		Good	35.9
	Sub-Grade 3a		
Grade 4		Moderate	Nil
	Sub-Grade 3b		
Grade 5		Poor	Nil
Grade 5		Very Poor	Nil

Land in Other Categories		
		Area within the site (ha.)
Urban <i>Including housing industry, commerce, derelict land, sports facilities, transport.</i>		Nil
Non-agricultural <i>Including golf courses, parks, sports fields, allotments, airfields.</i>		Nil
Woodland <i>Farm woodland</i>		Nil
	<i>Commercial woodland</i>	
Agricultural buildings <i>Including glasshouses</i>		0.5
Open water		Nil
Land not surveyed		Nil

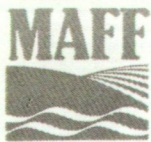
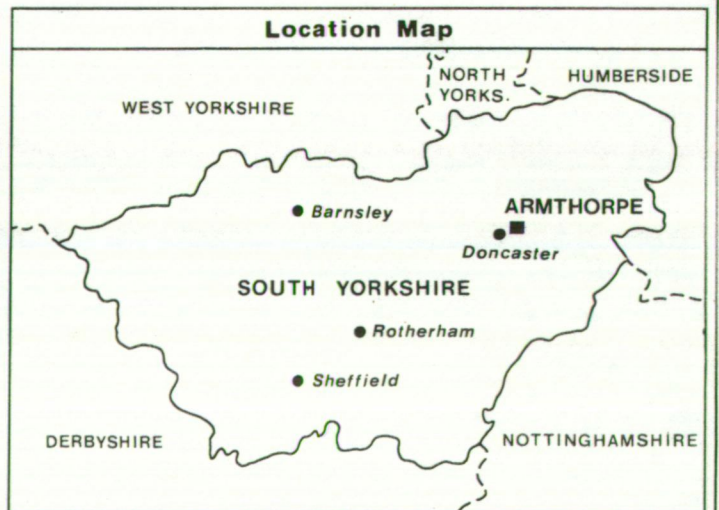
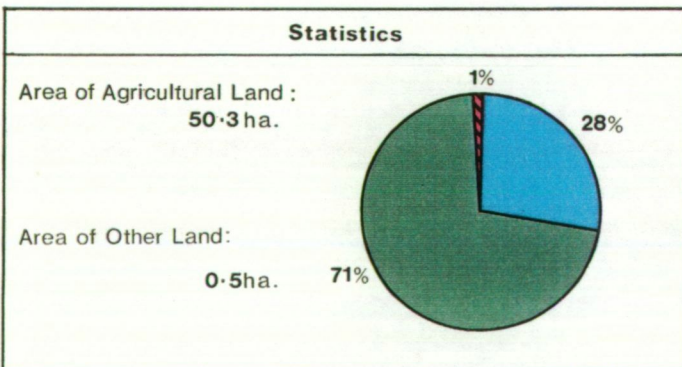

Ministry of Agriculture,
Fisheries and Food.

SCALE-1:10,000

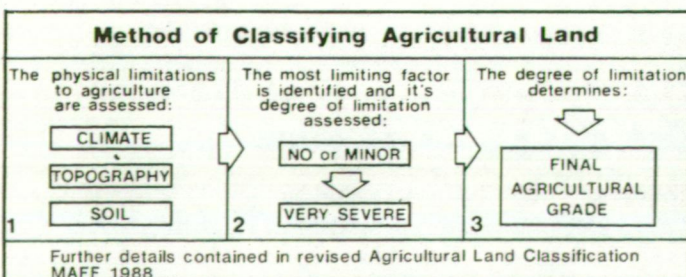
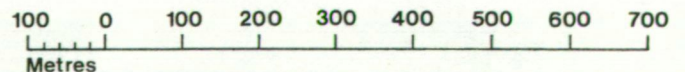

Information compiled by Resource Planning Group, Farm and Countryside Service, Leeds R.O.
Map produced by Resource Planning Cartographic Unit.
Project Number 44/90

Ordnance Survey maps reproduced with the permission of the Controller, H.M.S.O.

© Crown Copyright Reserved 1990

SOURCE MAPS

1:10,000
SE 60 NW SE 60 NE

W e s t M o o r

WEST MOOR FARM
ARMTHORPE 44/90
1:5,000 SE 60 NW
(+NE?)
1b. per ha.

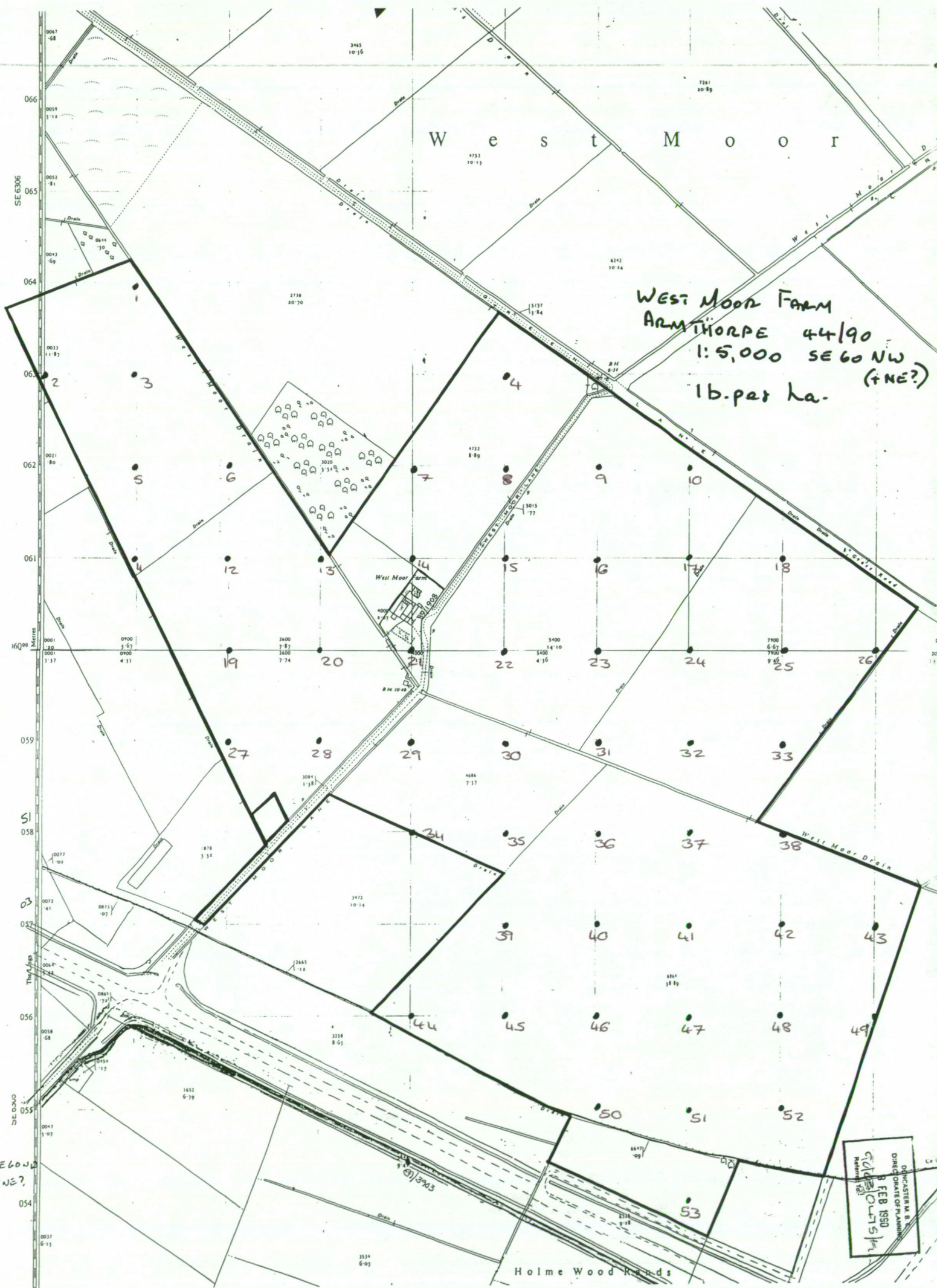

DUNCAN M. B.
DIRECTORATE OF PLANNING
FEB 1950
Scales
1:5,000
1:10,000
1:25,000
1:50,000

Holme Wood Roads

SE 60 NW
& NE?