

NEWSHAM GRANGE

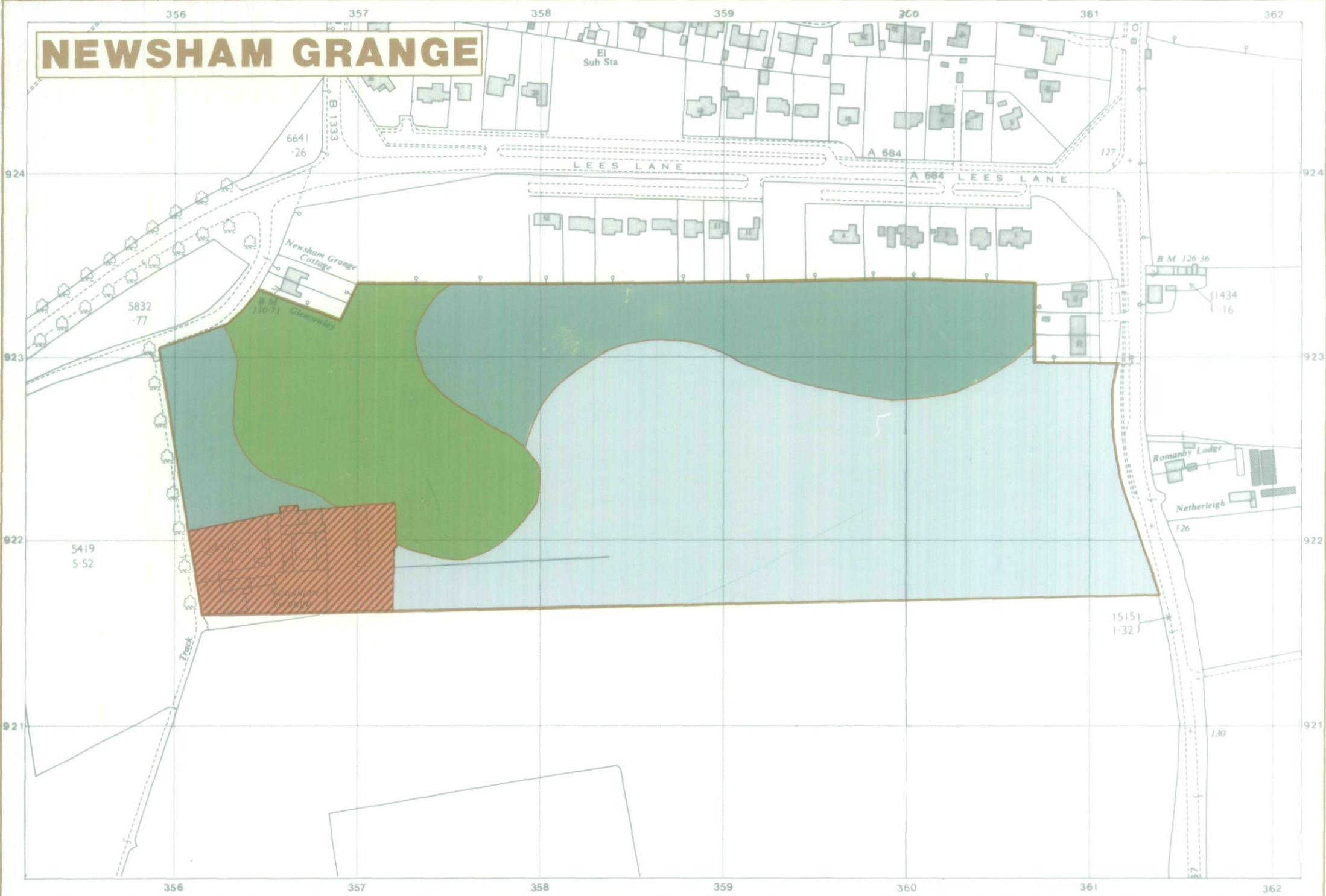

356

357

358

359

360

361

362

El Sub Sta

LEES LANE

A 684 LEES LANE

Newsham Grange Cottage

Romanby Lodge

Netherleigh

5832
·77

B.M. 110-71
Glencaulry

B.M. 126-36

(1434
·16

5419
5-52

1515
1-32

356

357

358

359

360

361

362

924

924

923

923

922

922

921

921

Track

130

NEWSHAM GRANGE Agricultural Land Classification

ROMANBY

Proposed Residential Development

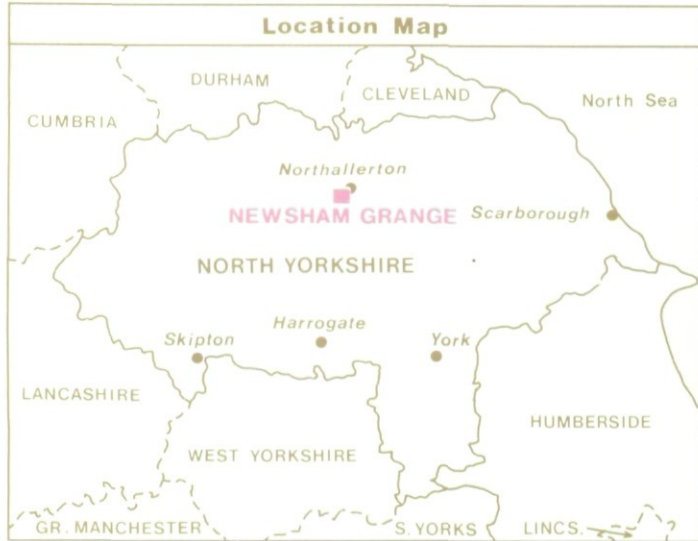

Ministry of Agriculture,
Fisheries and Food.

Agricultural Land			
Agricultural Grades		Agricultural Land Quality	Area within the site (ha.)
Grade 1		Excellent	Nil
Grade 2		Very Good	4.4
Grade 3		Good	2.4
	Sub-Grade 3a		
Grade 3		Moderate	1.8
	Sub-Grade 3b		
Grade 4		Poor	Nil
Grade 5		Very Poor	Nil

Land in Other Categories		
		Area within the site (ha.)
Urban <i>Including housing industry, commerce, derelict land, sports facilities, transport.</i>		Nil
Non-agricultural <i>Including golf courses, parks, sports fields, allotments, airfields.</i>		Nil
Woodland <i>Farm woodland</i>		Nil
	<i>Commercial woodland</i>	
Agricultural buildings <i>Including glasshouses</i>		0.6
Open water		Nil
Land not surveyed		Nil

SCALE - 1:2,500

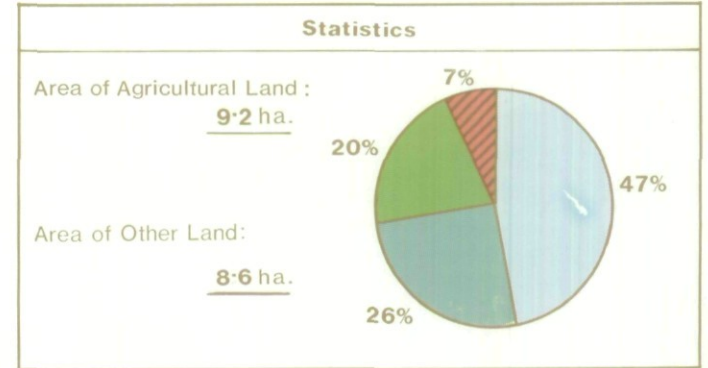
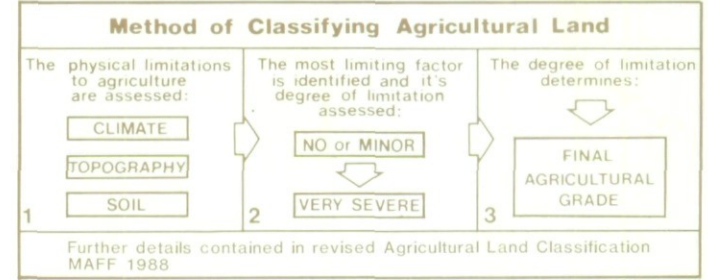

Information compiled by Resource Planning Group, Farm and Countryside Service, Leeds R.O.
Map produced by Resource Planning Cartographic Unit
Project Number 52/89
Ordnance Survey maps reproduced with the permission of the Controller, H.M.S.O.
© Crown Copyright Reserved 1989

SOURCE MAPS

1:2,500
SE 3492-3592

1:2,500
SE 3692-3792

NEWSHAM GRANGE

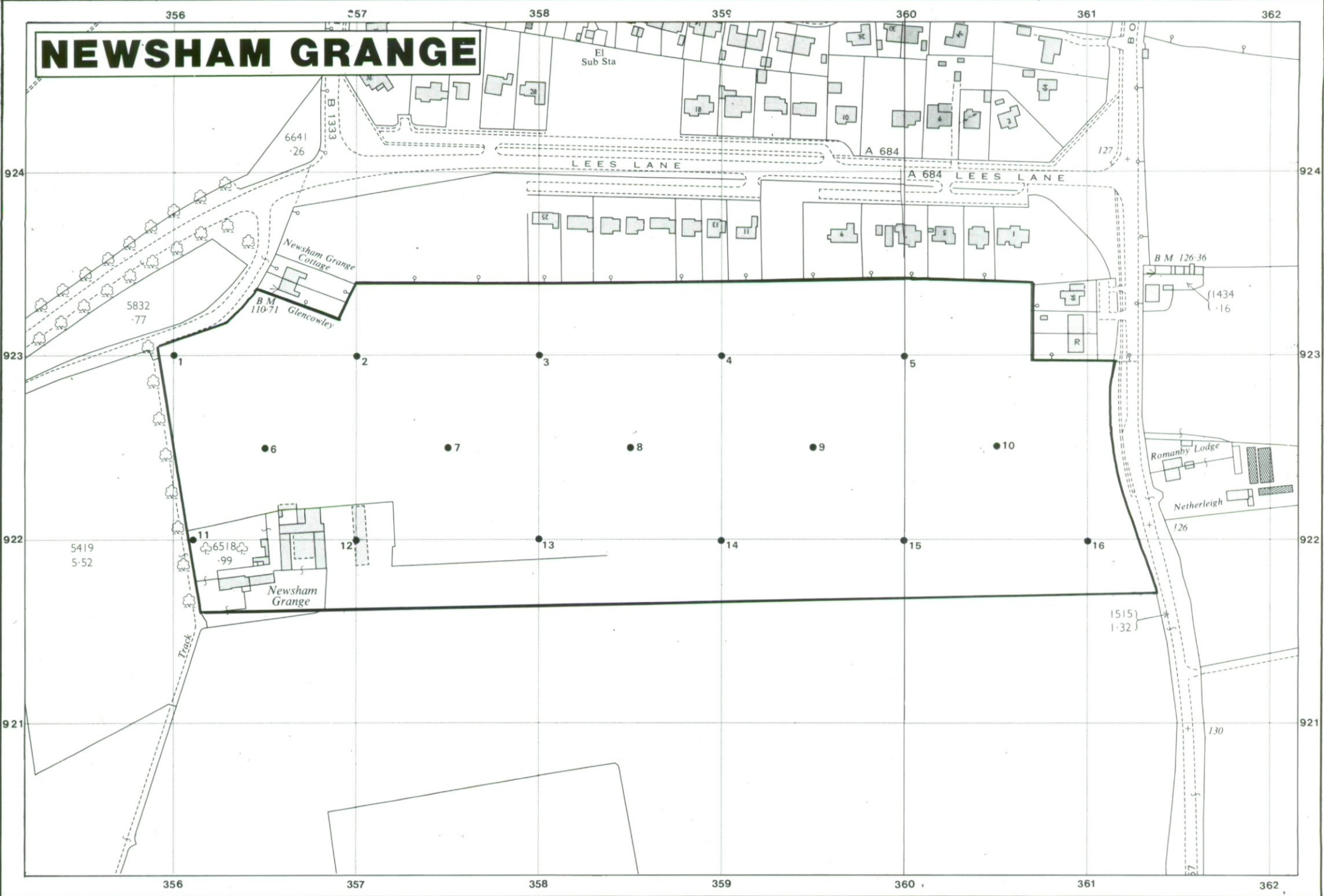

356

357

358

359

360

361

362

El Sub Sta

LEES LANE

A 684 LEES LANE

Newsham Grange Cottage

B.M. 110.71
Glencowley

B.M. 126.36

1434.16

Romanby Lodge

Netherleigh

Newsham Grange

1515.132

130

356

357

358

359

360

361

362

924

924

923

923

922

922

921

921

NEWSHAM GRANGE ROMANBY

Proposed Residential Development

Agricultural Land Classification

Location of Soil Auger Borings

Soil Auger Borings •

SCALE - 1:2,500

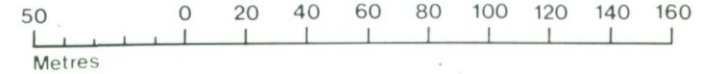

Location Map

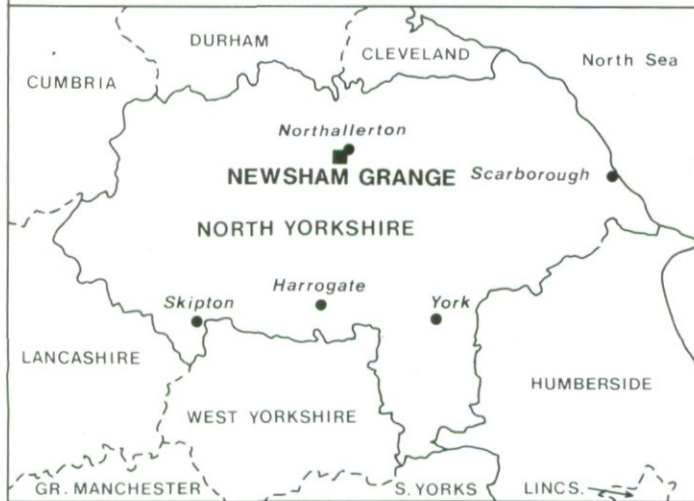

Ministry of Agriculture,
Fisheries and Food.

Information compiled by Resource Planning Group,
Farm and Countryside Service, Leeds R.O.
Map produced by Resource Planning Cartographic Unit.
Project Number 52/89
Ordnance Survey maps reproduced with the
permission of the Controller, H.M.S.O.
© Crown Copyright Reserved 1989

SOURCE MAPS

1:2,500
SE 3492-3592

1:2,500
SE 3692-3792