

Agricultural Land Classification

EAST YORKSHIRE BOROUGH WIDE LOCAL PLAN







Driffield Site 4 & Additional Area

GREAT DRIFFIELD

Agricultural Land

Grade	Quality	Area (ha)
1	Excellent	NIL
2	Very Good	7.3
3a	Good	7.4
3b	Moderate	3.4
4	Poor	NIL
5	Very Poor	NIL

Other Land Categories

	Urban	Area (ha) 0.1
	Non-Agricultural	NIL
	Woodland	NIL
	Agricultural Buildings	NIL
	Open Water	NIL
	Not Surveyed	NIL

Total agricultural land area 18.1
Total survey area 18.2

* Grade/category not present within survey area

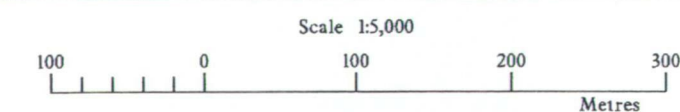

Further details contained in MAFF (1988) Agricultural Land Classification of England and Wales - Revised guidelines and criteria for grading the quality of agricultural land. MAFF (Publications), London SE99 7TP.

The information is accurate at the base map scale but any enlargement would be misleading.

Reproduction in whole or in part by any means is prohibited without the prior permission of MAFF.

Surveyed and drawn by the Resource Planning Team, ADAS Statutory Unit Leeds
Based on the 1982 Ordnance Survey 1:10,000 map with the permission of the
Controller of Her Majesty's Stationery Office.
Source Map(s): TA05NW
Reference no. 041/94

© Crown Copyright Reserved 1993

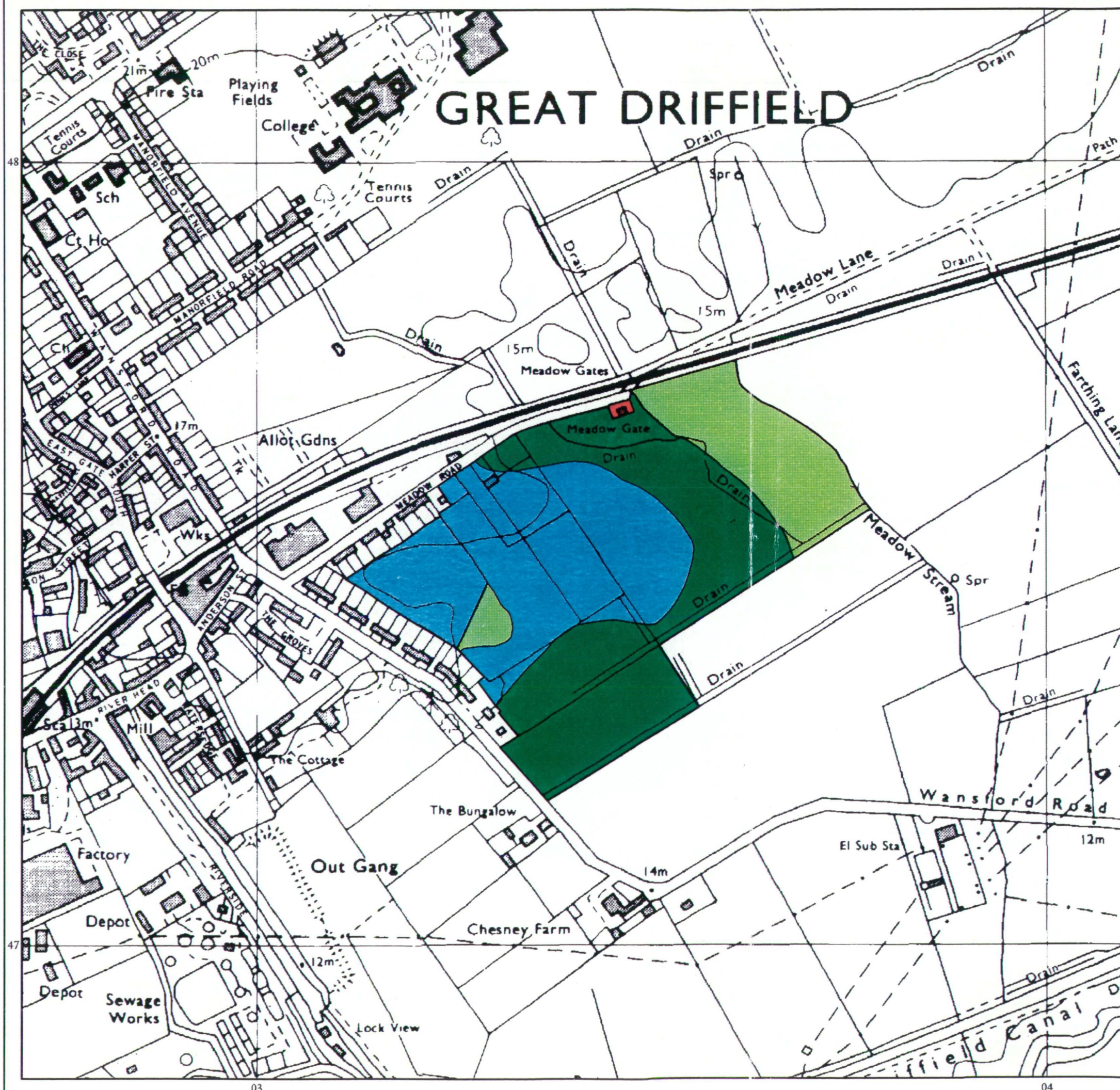

Site DRIFT plus additional area

Meadow Lane
Drain

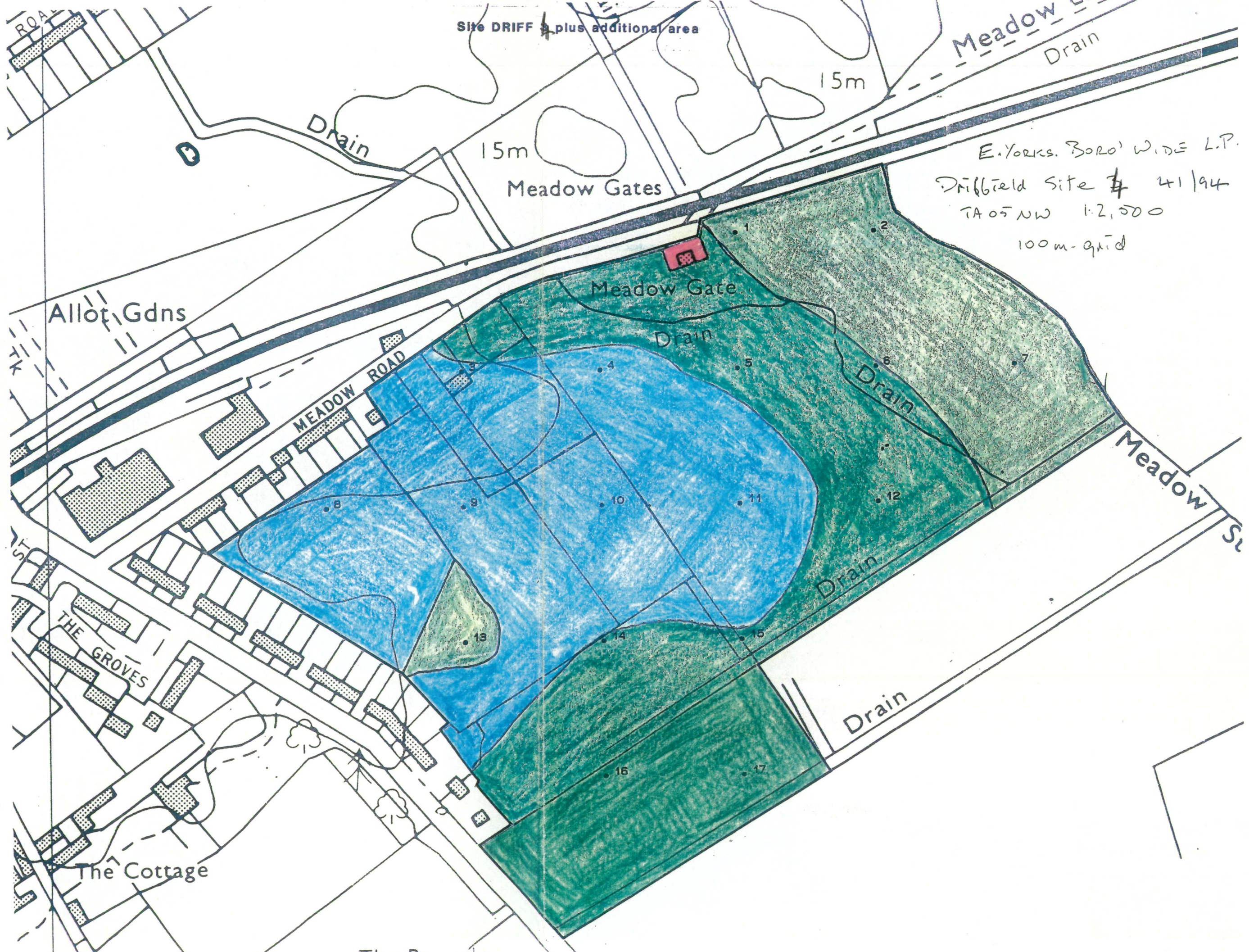

E. Yorks. Boro' Wide L.P.
 Driffild Site # 41/94
 TA 05 NW 1:2,500
 100m-grid

Allot Gdns

MEADOW ROAD

THE GROVES

The Cottage

15m
Meadow Gates

15m

Meadow Gate

Drain

Drain

Drain

Drain

Meadow St

The P...