

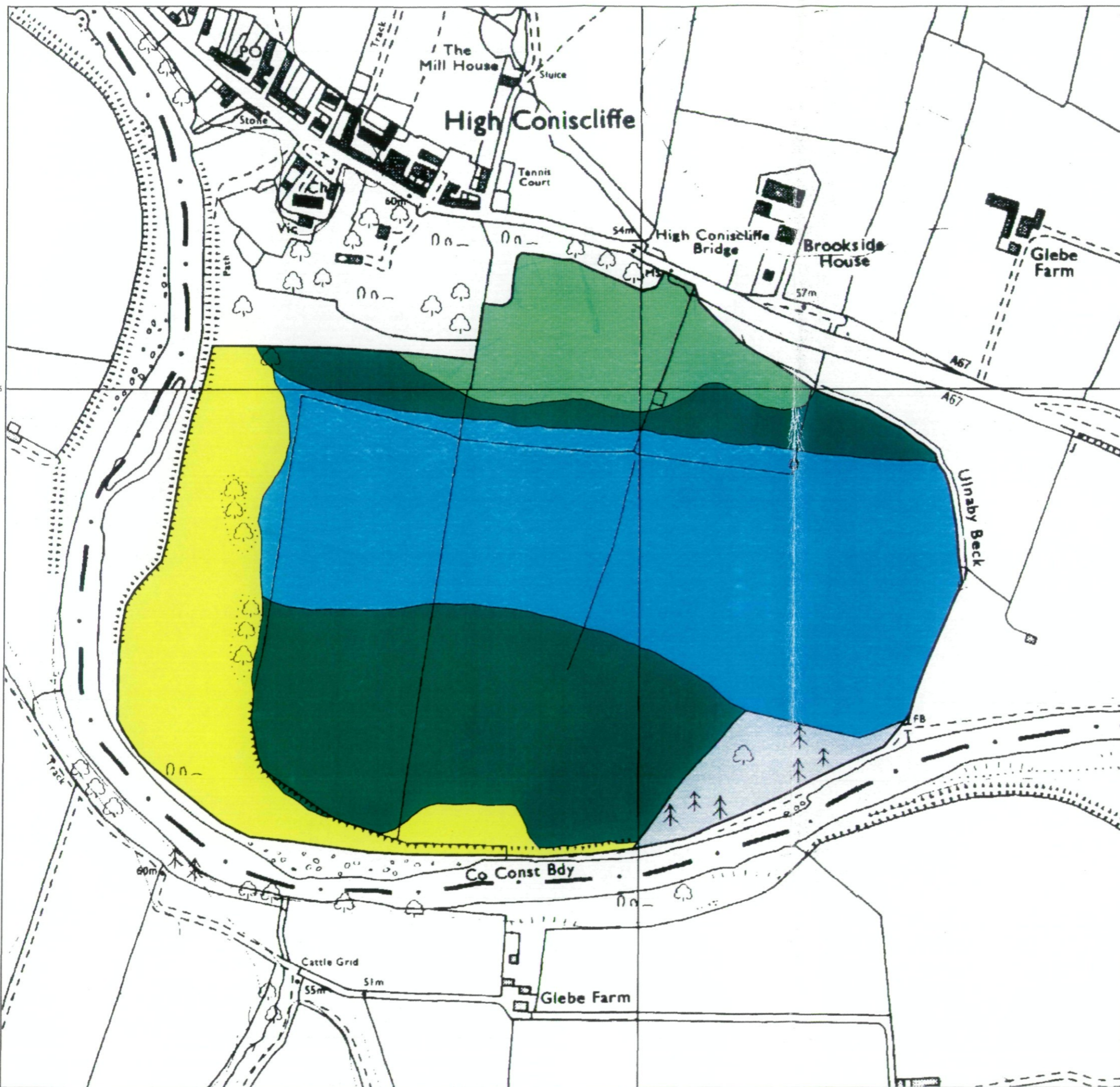



Agricultural Land Classification

COUNTY DURHAM M.L.P

High Coniscliffe

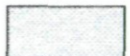

Legend

	Quality	Area (ha)
Grade 1	Excellent	Nil
Grade 2	Very Good	24.0
Grade 3a	Good	18.0
Grade 3b	Moderate	5.6
Grade 4	Poor	9.9
Grade 5	Very Poor	Nil
	Agricultural land not surveyed	Nil
	Other land	2.2
	Boundary of survey area	
Total agricultural land area		57.5
Total survey area		59.7
* Not present within survey area		

Scale 1:5,000

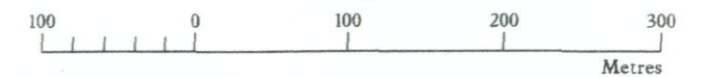

Further details contained in MAFF (1988) Agricultural Land Classification of England and Wales - Revised guidelines and criteria for grading the quality of agricultural land. MAFF(Publications), London SE99 7TP.

The information is accurate at the base map scale but any enlargement would be misleading.

Reproduction in whole or in part by any means is prohibited without the prior permission of MAFF.

Surveyed and drawn by the Resource Planning Team, FRCA Leeds.

Based on the 1976 Ordnance Survey 1:10,000 map with the permission of the Controller of Her Majesty's Stationery Office. Unauthorised reproduction infringes Crown copyright and may lead to prosecution or civil proceedings.
Source Map(s): NZZ1NW MAFF Licence No: GD272361
Reference no: 55/97 © Crown Copyright Reserved 1997

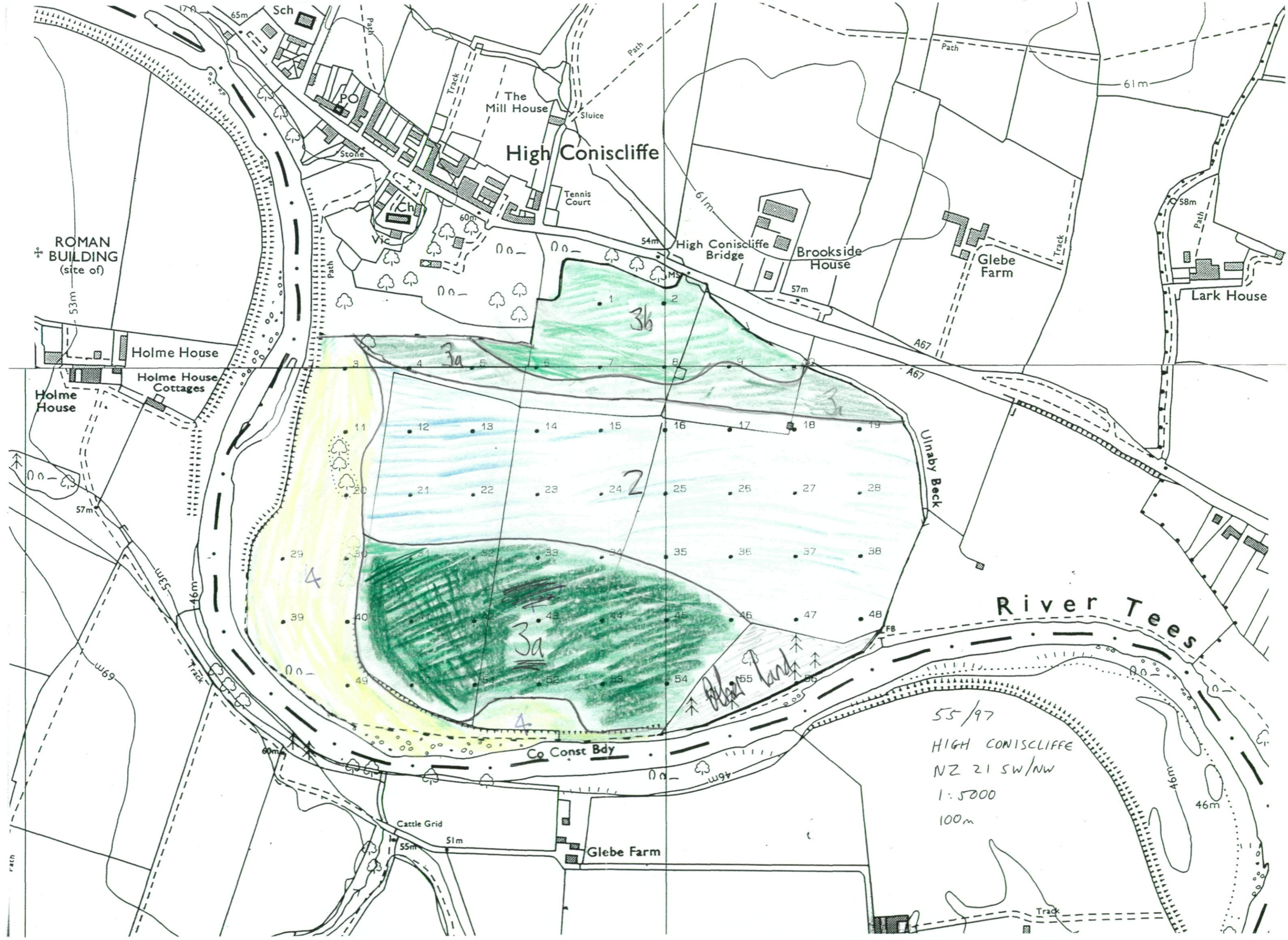

55/97
 HIGH CONISCLIFFE
 NZ 21 SW/NW
 1:5000
 100m

NORTH CP

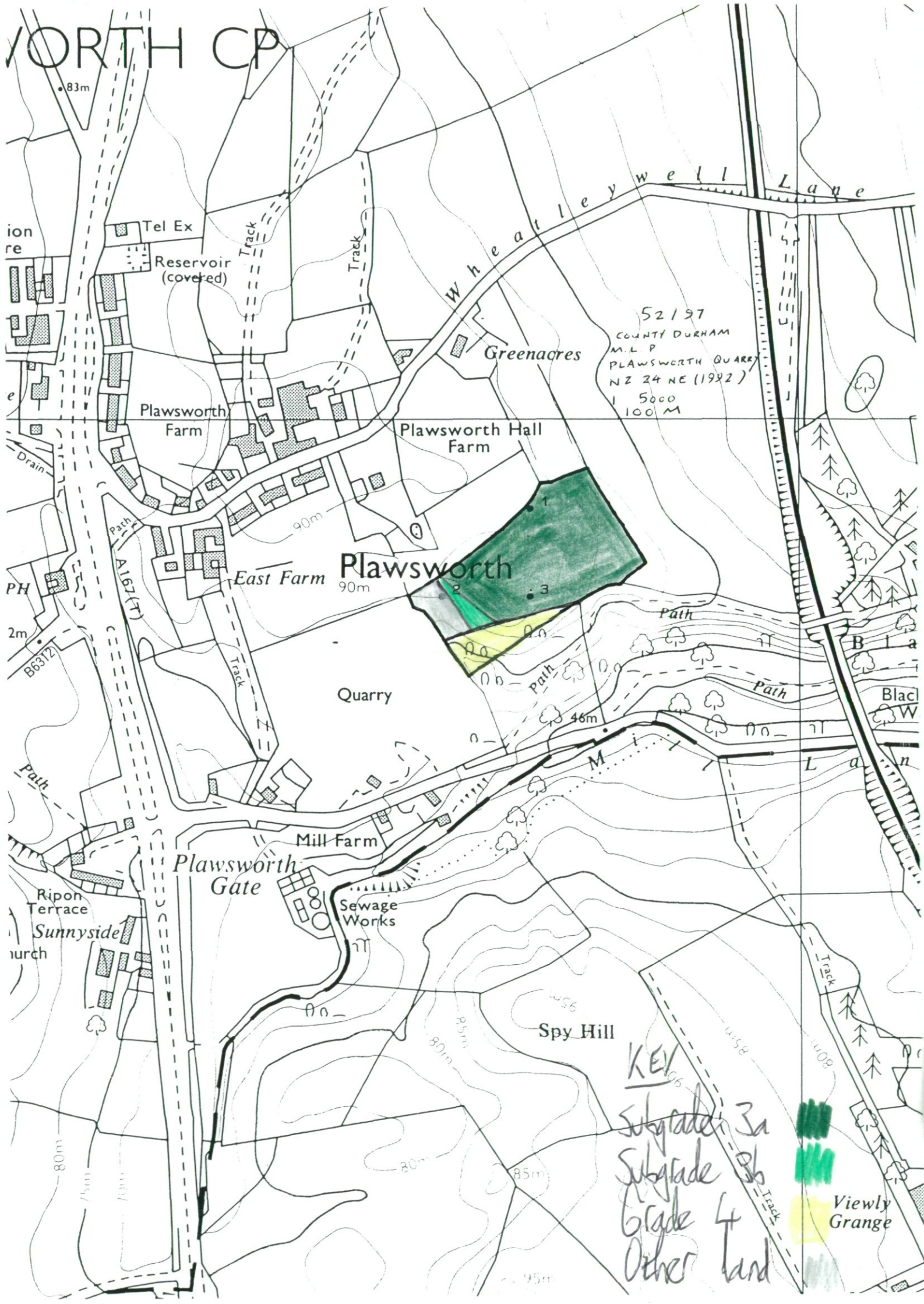

52197
 COUNTY DURHAM
 M.L.P.
 PLAWSWORTH QUARRY
 NZ 24 NE (1982)
 1:5000
 100 M

Plawsworth
 90m

KEY
 Subgrade 3a
 Subgrade 3b
 Grade 4
 Other land

Viewly Grange