

Agricultural Land Classification

BOLTON HOUSE FARM O.C.C.S.

GOLDTHORPE

Legend

	Quality	Area (ha)
Grade 1	Excellent	Nil
Grade 2	Very Good	Nil
Grade 3a	Good	Nil
Grade 3b	Moderate	0.6
Grade 4	Poor	Nil
Grade 5	Very Poor	Nil
	Agricultural land not surveyed	Nil
	Other land	0.6
	Boundary of survey area	
Total agricultural land area		0.6
Total survey area		1.2
* Not present within survey area		

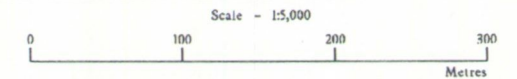

Further details contained in MAFF (1988) Agricultural Land Classification of England and Wales - Revised guidelines and criteria for grading the quality of agricultural land. Maff (publications), London SE99 7TP. The information is accurate at base map scale but any enlargement would be misleading.

Reproduction in whole or in part by any means is prohibited without the prior permission of MAFF.

Surveyed and drawn by the Resource Planning Team, ADAS Statutory Unit, Leeds.
Based on the 1988 Ordnance Survey 1:10,000 map with the permission of the Controller of Her Majesty's Stationery Office. Unauthorised reproduction infringes Crown copyright and may lead to prosecution or civil proceedings. MAFF Licence No: GD272361
Source map(s): SE 40 SE/SW
Reference no: A93/96 © Crown Copyright Reserved 1996

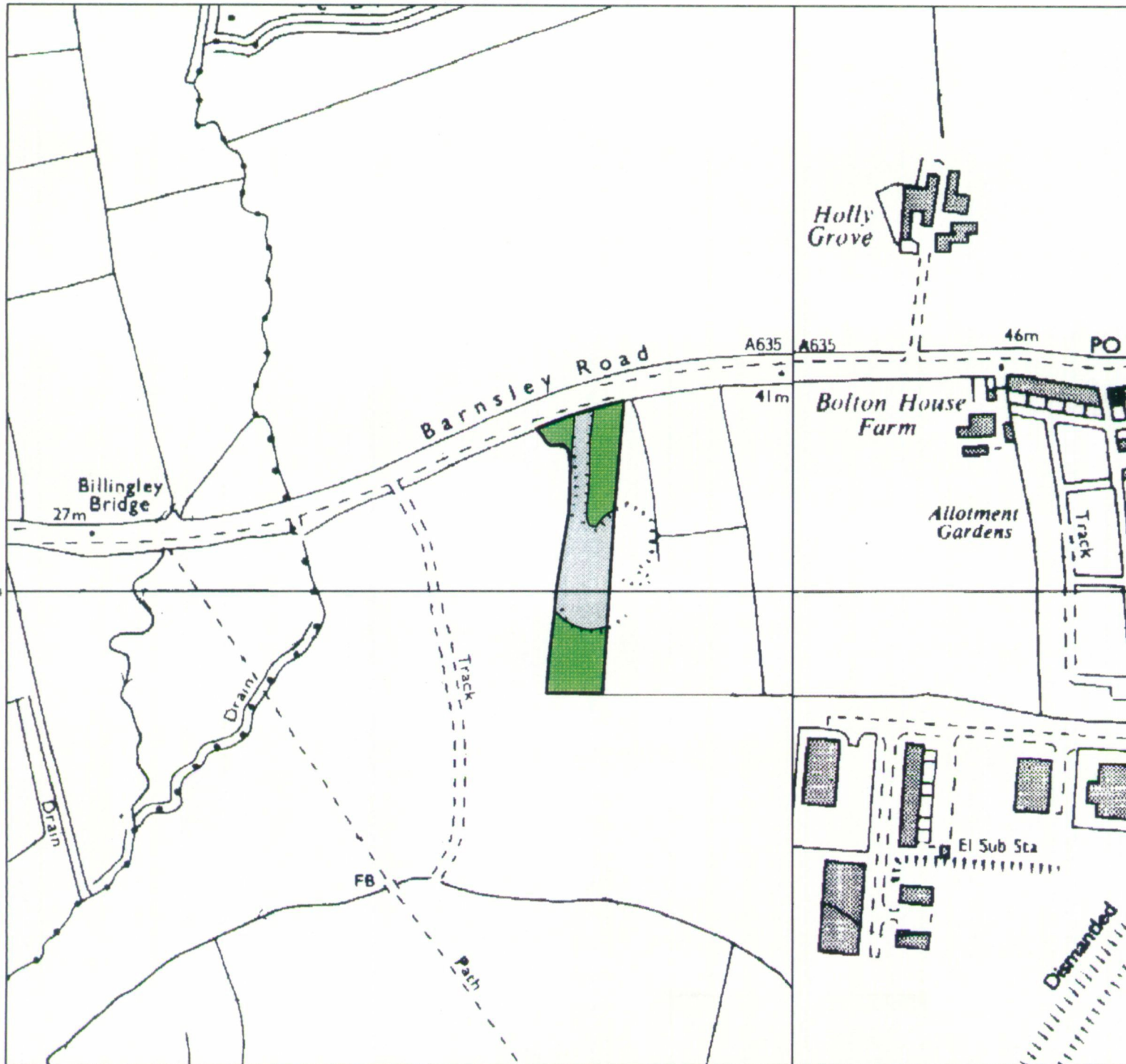

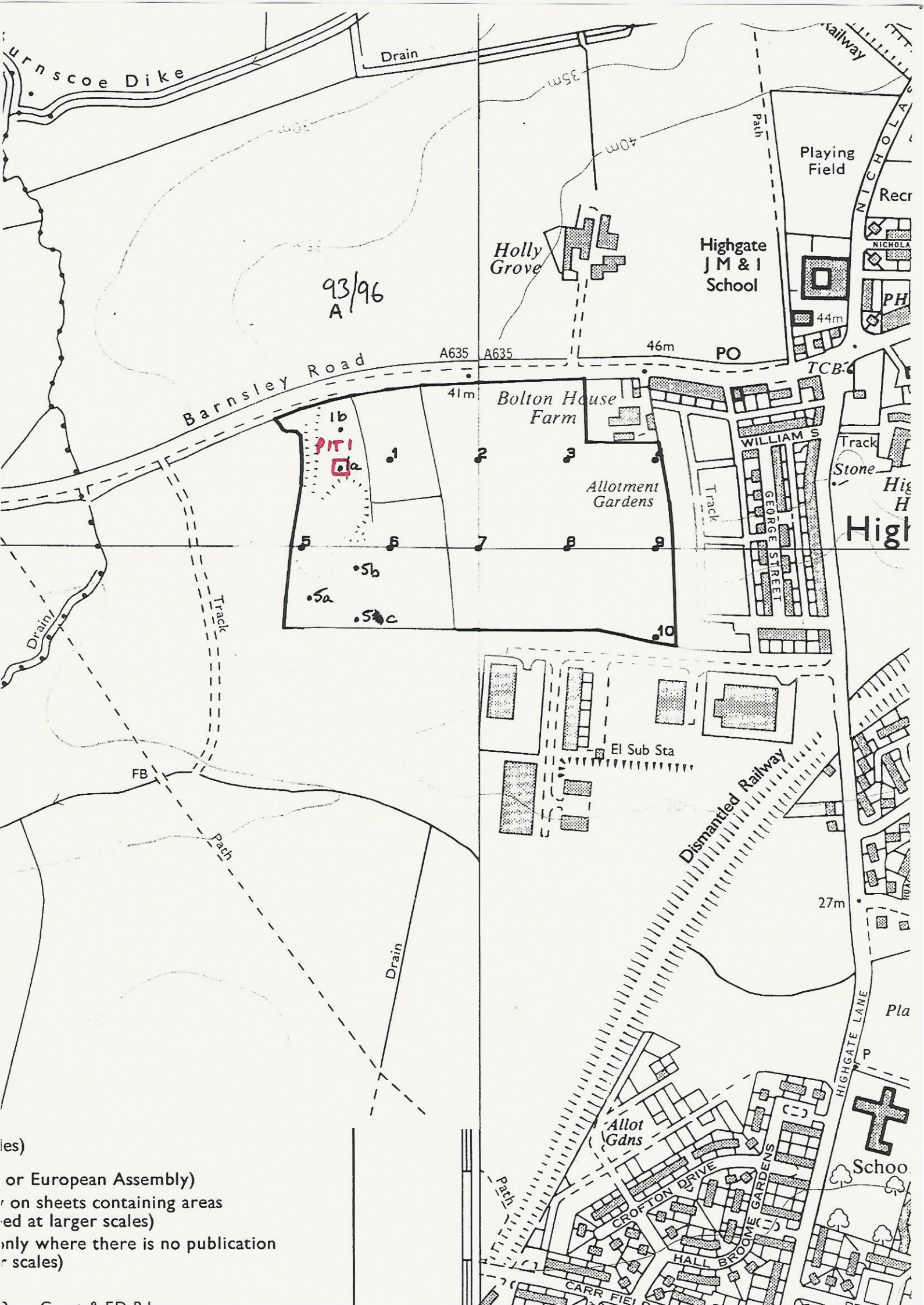

(les)
 or European Assembly)
 on sheets containing areas
 ed at larger scales)
 only where there is no publication
 r scales)

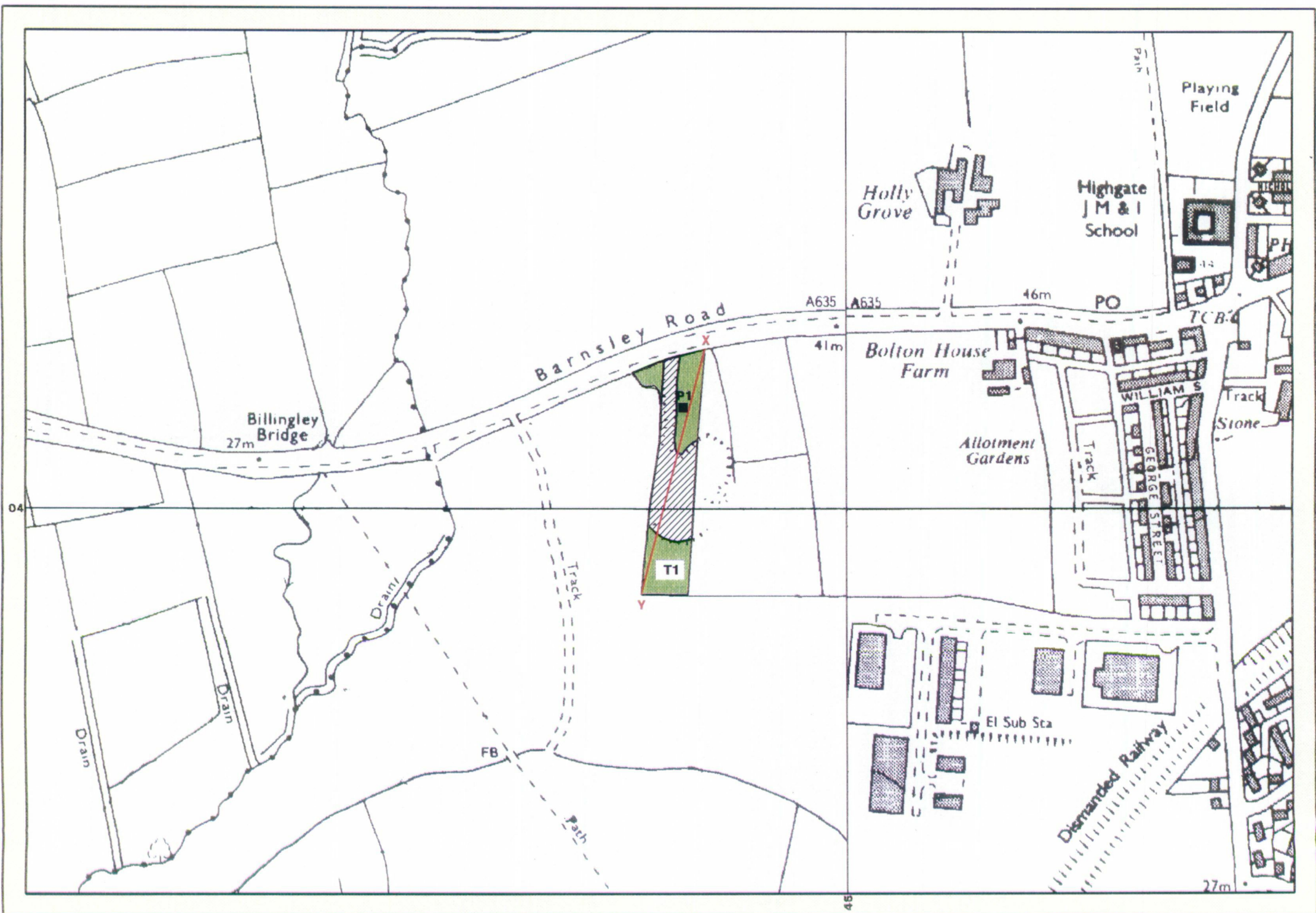

BOLTON HOUSE FARM O.C.C.S. GOLDTHORPE

Topsoil Resource Map

Unit	Soil Texture	Soil Thickness(cm.)			Area (ha)	Volume* (000m ³)
		Min	Mean	Max		
T1	Medium (disturbed)	0	30	35	0.6	1.8

* Volume at Mean Soil Thickness.

No Soil Resources

Soil Pits P1

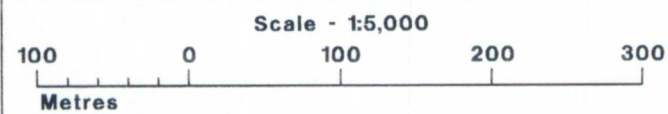

**Ministry of Agriculture,
Fisheries and Food.**

Based upon the 1988 1:10,000 Ordnance Survey maps SE 40 SE\SW with the permission of the Controller of Her Majesty's Stationary Office.
Project Number: A93\96
Information compiled by ADAS Resource Planning Team, Leeds Statutory Centre.
Map produced by ADAS Resource Planning Team Cartographic Unit, Leeds Statutory Centre
Unauthorised reproduction infringes Crown Copyright and may lead to civil proceedings.
© Crown copyright. MAFF Licence GD272361.

Diagrammatic Section across Site

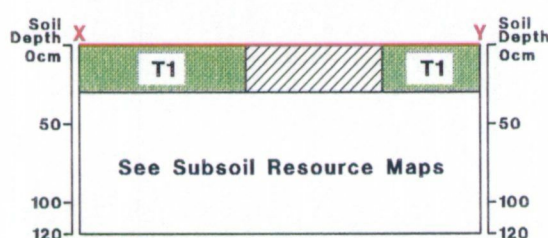

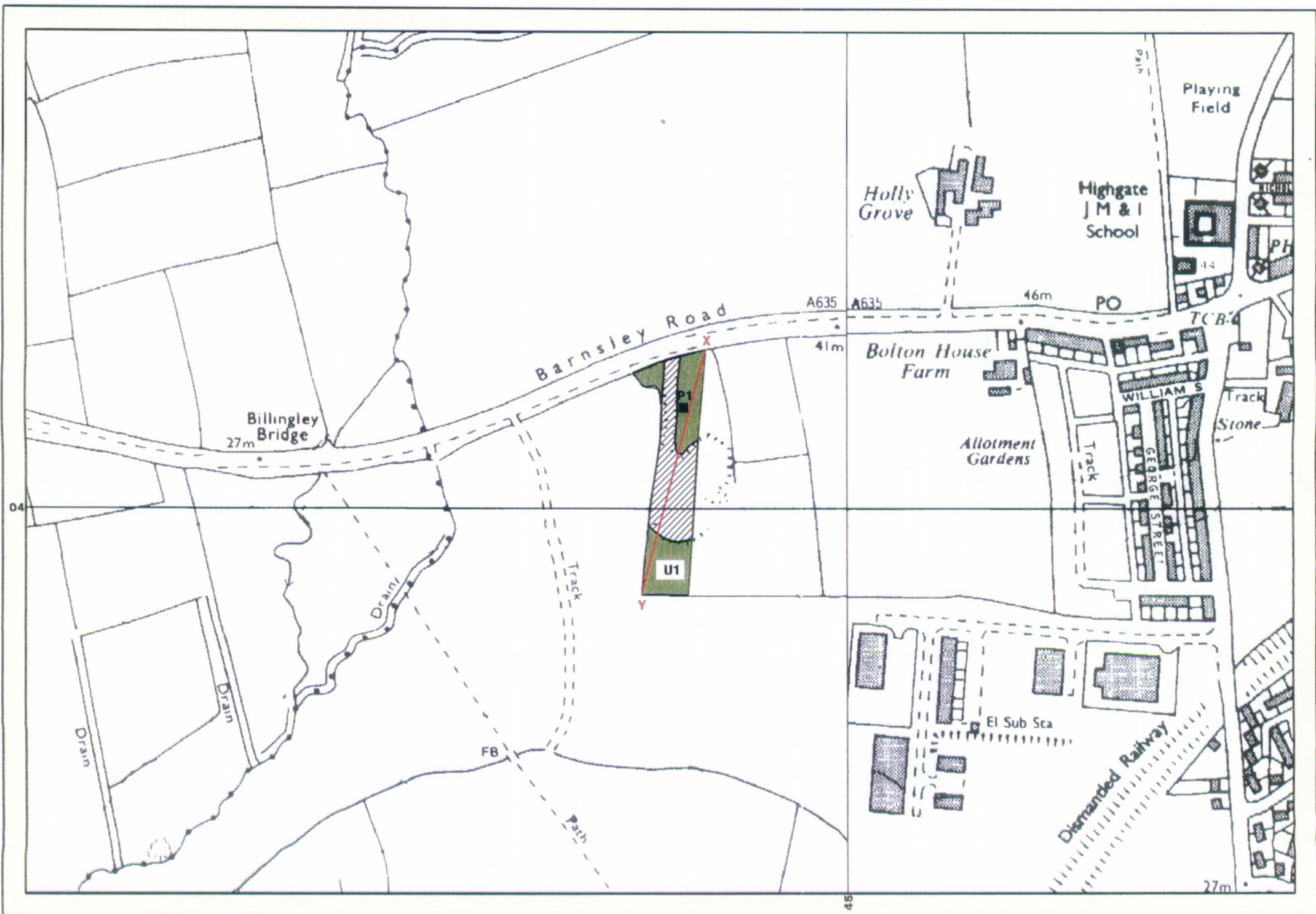

BOLTON HOUSE FARM O.C.C.S. GOLDTHORPE

Upper Subsoil Resource Map

Unit	Soil Texture	Mean Soil Thickness(cm.)	Area (ha)	Volume* (000m ³)
U1	Medium (disturbed)	25	0.6	1.5

No Soil Resources

Soil Pits P1

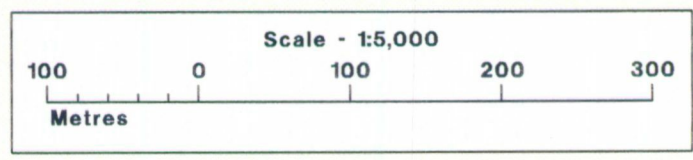

**Ministry of Agriculture,
Fisheries and Food.**

Based upon the 1988 1:10,000 Ordnance Survey maps SE 40 SE\SW with the permission of the Controller of Her Majesty's Stationery Office.
Project Number: A93\96
Information compiled by ADAS Resource Planning Team, Leeds Statutory Centre.
Map produced by ADAS Resource Planning Team Cartographic Unit, Leeds Statutory Centre
Unauthorised reproduction infringes Crown Copyright and may lead to civil proceedings.
© Crown copyright. MAFF Licence GD272361.

Diagrammatic Section across Site

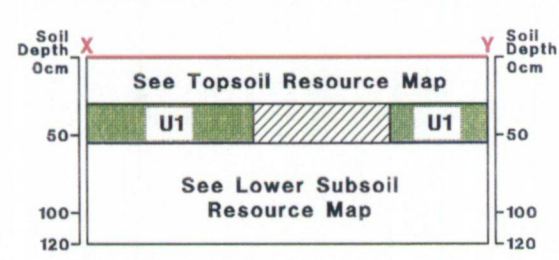

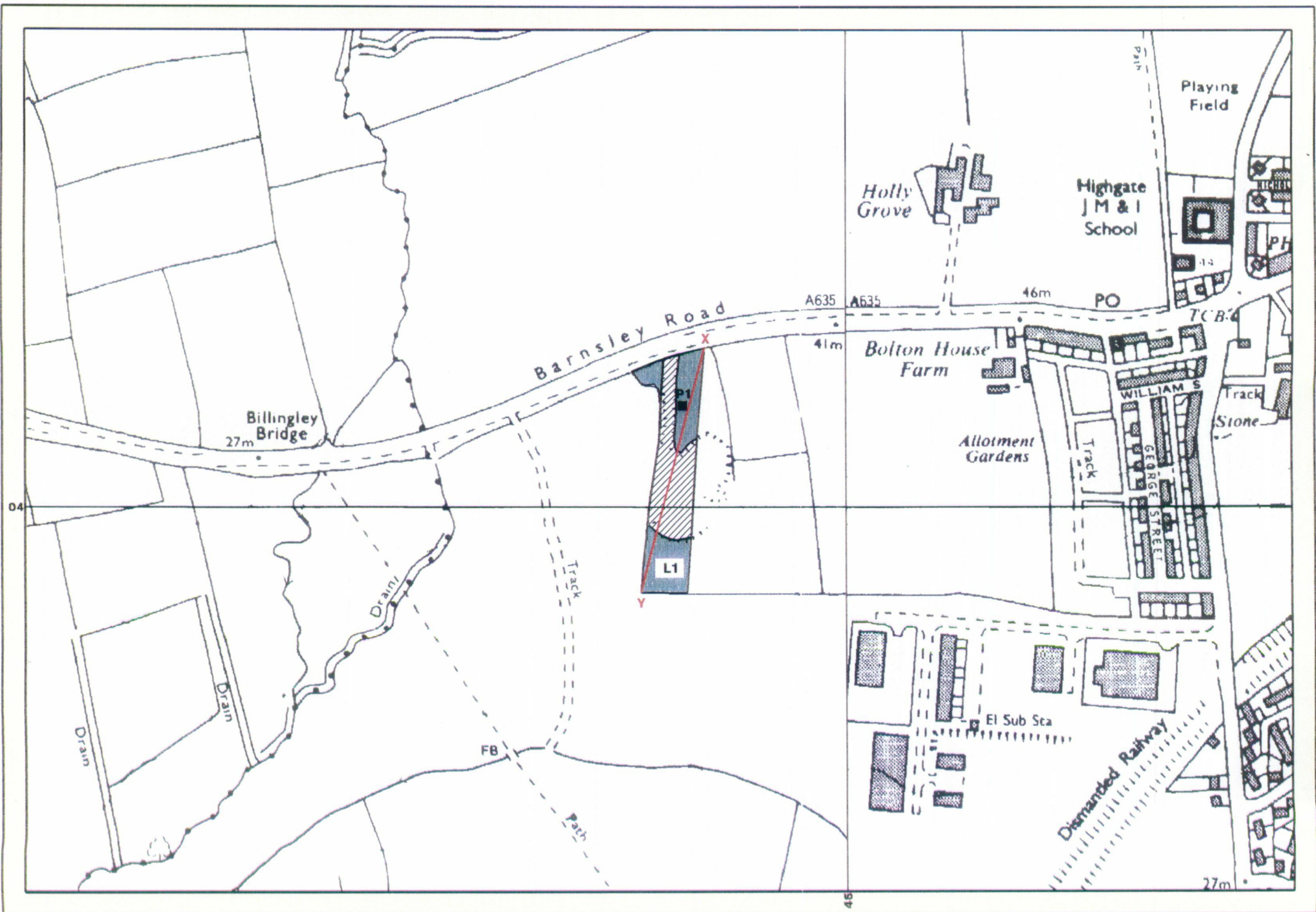

BOLTON HOUSE FARM O.C.C.S. GOLDTHORPE

Lower Subsoil Resource Map

Unit	Soil Texture	Mean Soil Thickness(cm.)	Area (ha)	Volume* (000m ³)
L1	Heavy (disturbed)	65	0.6	3.9

No Soil Resources

Soil Pits P1

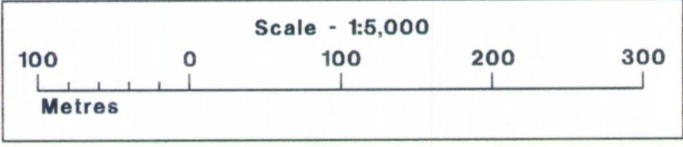

MAFF
Ministry of Agriculture,
Fisheries and Food.

Based upon the 1988 1:10,000 Ordnance Survey maps SE 40 SE\SW with the permission of the Controller of Her Majesty's Stationery Office.
Project Number: A93\96
Information compiled by ADAS Resource Planning Team, Leeds Statutory Centre.
Map produced by ADAS Resource Planning Team Cartographic Unit, Leeds Statutory Centre
Unauthorised reproduction infringes Crown Copyright and may lead to civil proceedings.
© Crown copyright. MAFF Licence GD272361.

Diagrammatic Section across Site

