

MAP 1 - LOCATION PLAN
 BODSEY BRIDGE
 EXTENSION

HUNTINGDONSHIRE DISTRICT
 COUNCIL
 PLANNING DEPARTMENT
 26 JUN 1991
 RECEIVED

Best & Most
 versatile

Reconnaissance Survey

Andrew J. Campbell Associates
 Planning and Development Consultants

Stable Court, Ferrars Road.
 Huntingdon,
 Cambs. PE18 6DH.
 Telephone (0480) 52044

Scale 1:5000	Date JUNE 91
Drawn	Checked
Drawing No.	ASC/87/107

JUN 20 1991

MAP 1 - LOCATION PLAN

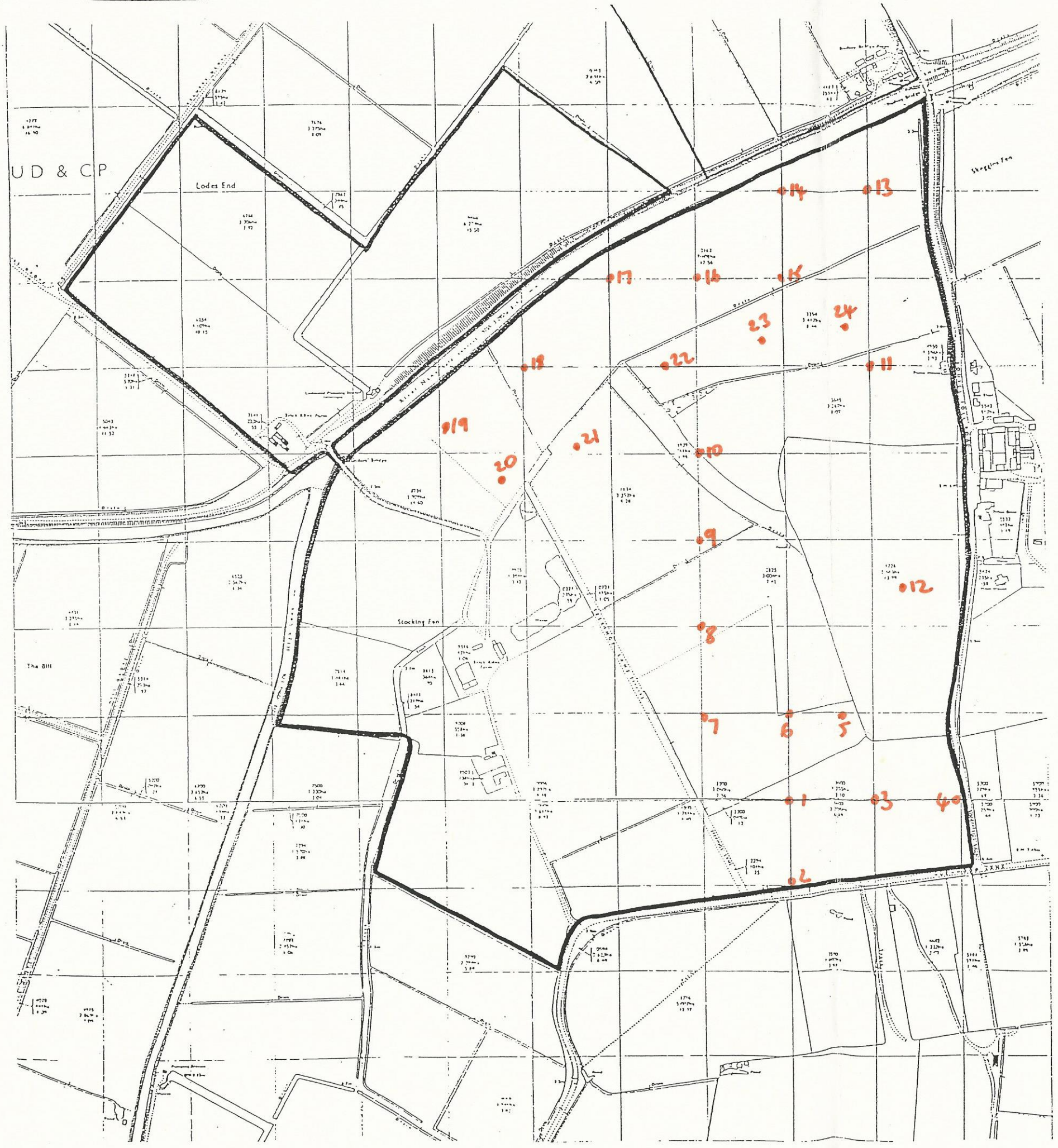

HUNTINGDONSHIRE DISTRICT
 COUNCIL
 PLANNING DEPARTMENT
 26 JUN 1991
 RECEIVED

54/91
NB
Recon survey

Andrew J. Campbell Associates
 Planning and Development Consultants
 Stable Court, Ferrars Road.
 Huntingdon.
 Cambs. PE18 6DH.
 Telephone (0480) 52044

Scale 1:5000	Date JUNE 91
Drawn	Checked
Drawing No.	ASC/ 87/107