

Agricultural Land Classification

Portly Ford Farm, Welford, Northants

AGRICULTURAL LAND

Agricultural Grades (Irrigated)

- Grade 1 *
- Grade 2
- Grade 3 a
- Grade 3 b
- Grade 4 *
- Grade 5 *

Agricultural Land Quality

Very high



Very low

Disturbed *

Agricultural Buildings *

Unsurveyed *

NON AGRICULTURAL LAND

Land predominantly in urban use *

Other land primarily in non-agricultural use *

* Land in this category does not occur on this map

SOURCE MAPS Base maps taken from the O.S. 1:10000 Sheet no. SP 67 NE/NW

This map is accurate only at the scale shown. Any enlargement could be misleading

Scale 1:10 000

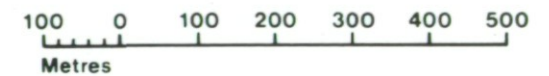

Drawn by the Cartographic Unit, Farm & Countryside Service Cambridge, Ref 02 92

Ordnance Survey maps reproduced with the permission of the Controller, H.M.S.O. © Crown Copyright reserved 1992

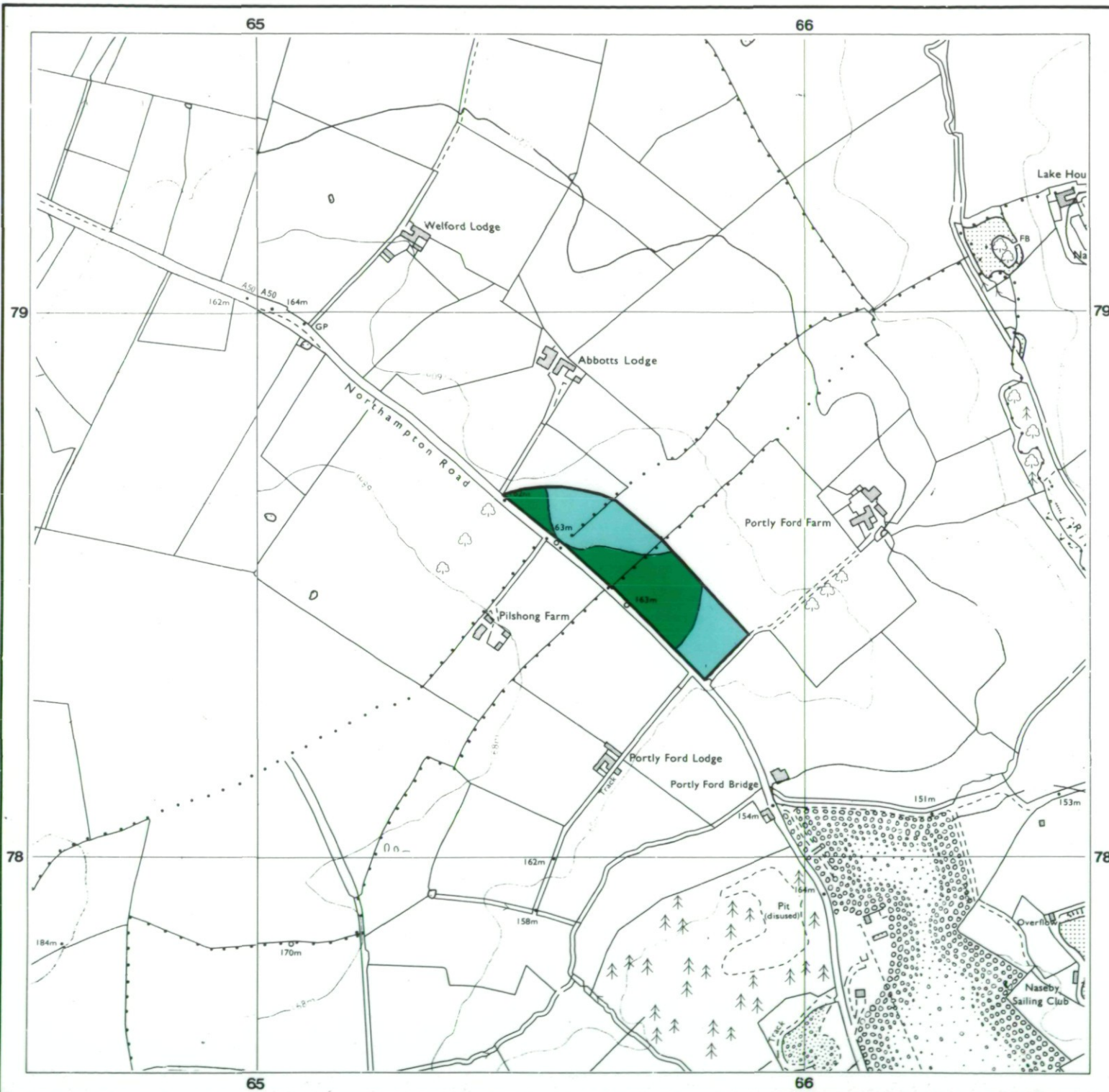

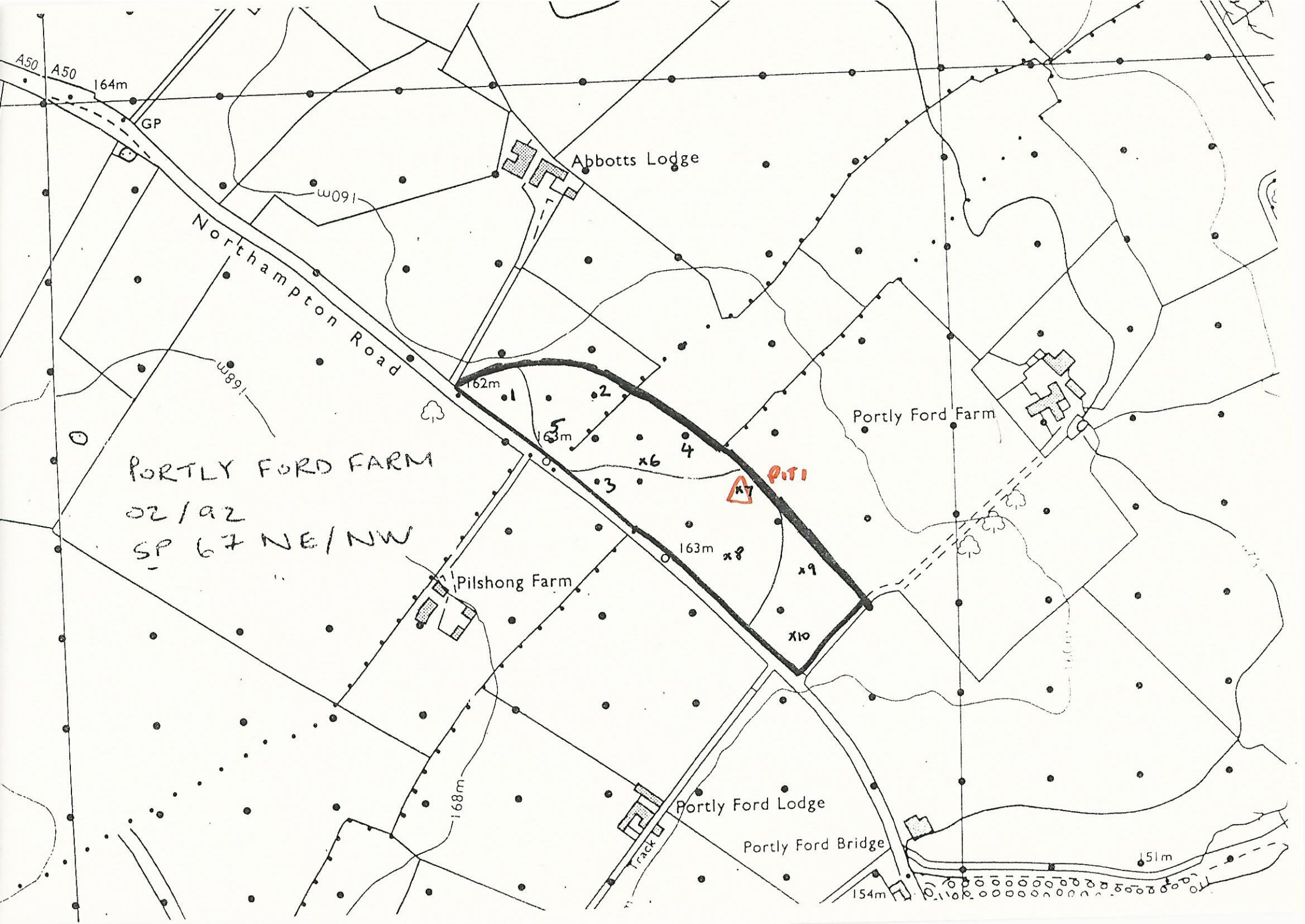



PORTLY FORD FARM
02/92
SP 67 NE/NW

PITI

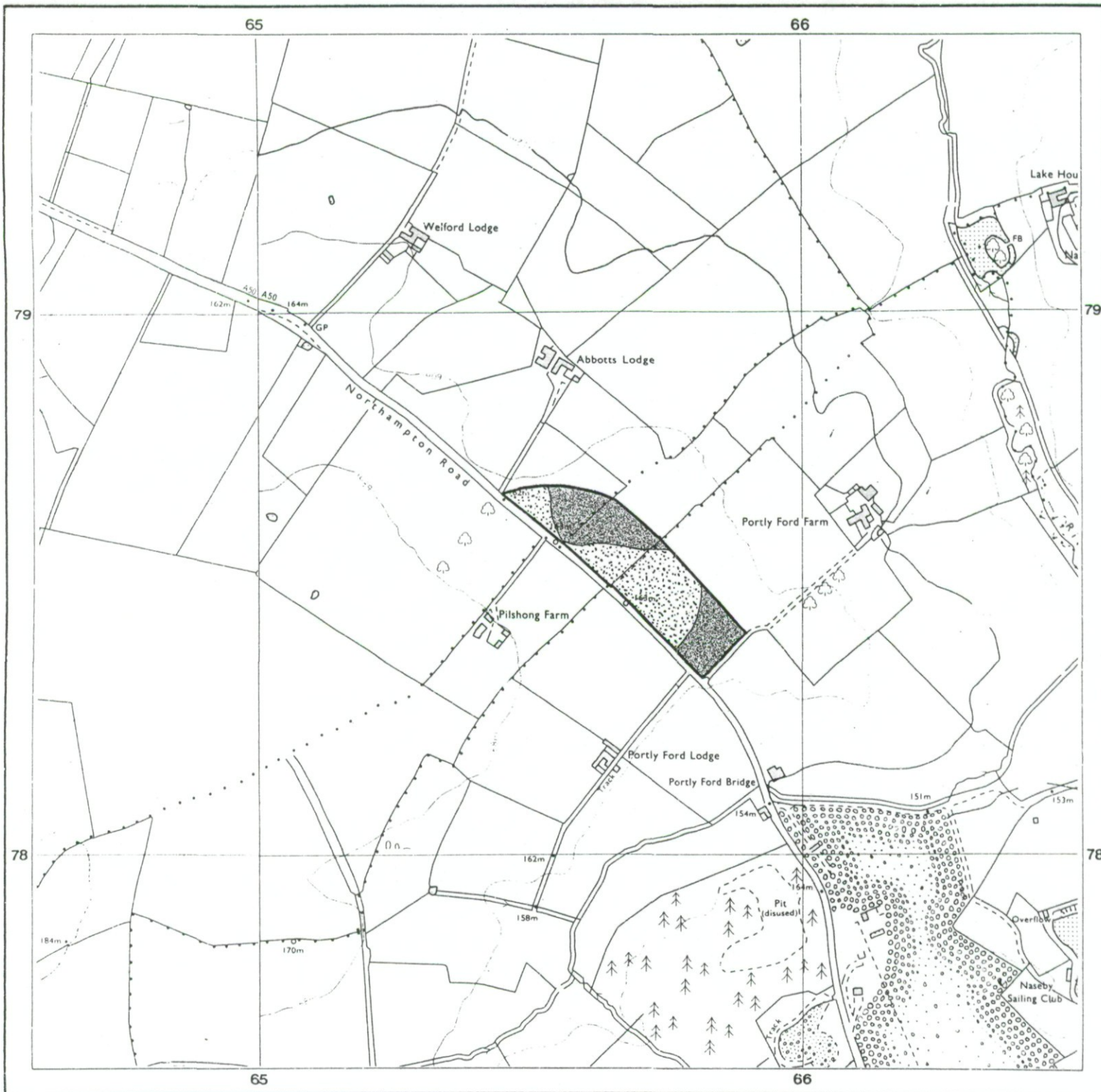
- 1
- 2
- 3
- 4
- 5
- 6
- 7
- 8
- 9
- 10

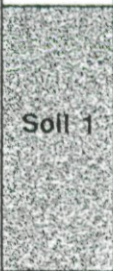

Portly Ford Farm, Welford, Northants

SOIL TYPES	Topsoll 0-30/35cm	Upper Subsoil 30/35- 50/60cm	Lower Subsoil 50/60- 120cm
 Soil 1	MCL	Sil stony SCL	mod stony SCL
 Soil 2	MCL	V. sil stony HCL or SC	C

SOURCE MAPS Base maps taken from the OS 1:10000
Sheet no. SP 67 NE/NW

This map is accurate only at the scale shown.
Any enlargement could be misleading

Scale 1:10 000

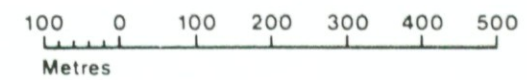

Drawn by the Cartographic Unit,
Farm & Countryside Service
Cambridge Ref 02 92
Ordnance Survey maps reproduced
with the permission of the Controller,
H.M.S.O
© Crown Copyright reserved 1992

