

Agricultural Land Classification

HUGDEN FARM

NORTON

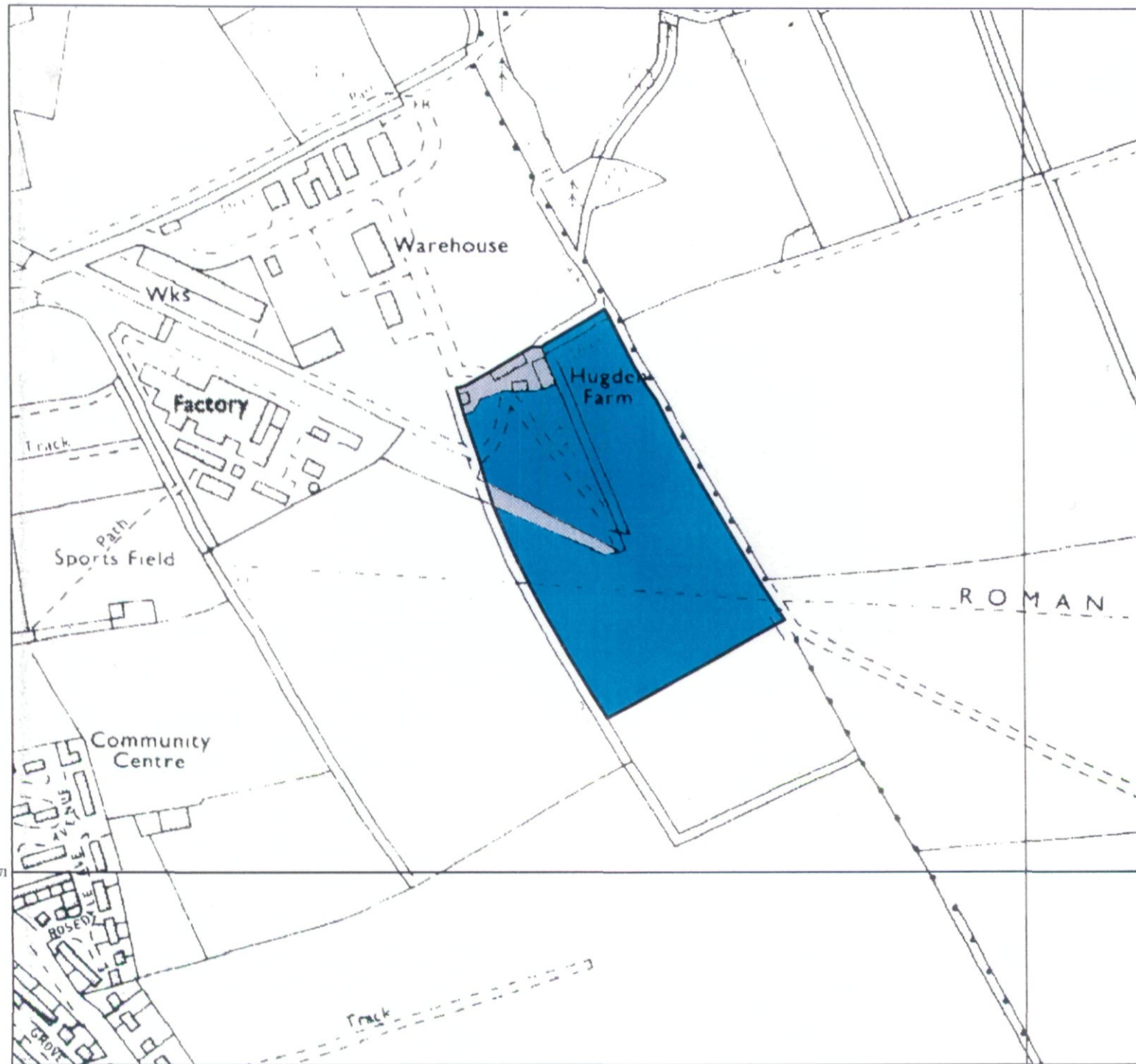

Legend

	Quality	Area (ha)
Grade 1	Excellent	Nil
Grade 2	Very Good	5.2
Grade 3a	Good	Nil
Grade 3b	Moderate	Nil
Grade 4	Poor	Nil
Grade 5	Very Poor	Nil
	Agricultural land not surveyed	Nil
	Other land	0.4
	Boundary of survey area	
Total agricultural land area		5.2
Total survey area		5.6
* Not present within survey area		

Scale - 1:5,000



Further details contained in MAFF (1988) Agricultural Land Classification of England and Wales - Revised guidelines and criteria for grading the quality of agricultural land. Maff (publications), London SE99 7TP. The information is accurate at base map scale but any enlargement would be misleading. Reproduction in whole or in part by any means is prohibited without the prior permission of MAFF.

Surveyed and drawn by the Resource Planning Team, FRCA, Leeds.

Based on the 1983 Ordnance Survey 1:10,000 map with the permission of the Controller of Her Majesty's Stationery Office. Unauthorised reproduction infringes Crown copyright and may lead to prosecution or civil proceedings. MAFF Licence No: GD272361
Source map(s): SE 87 SW
Reference no: 22/97 © Crown Copyright Reserved 1997

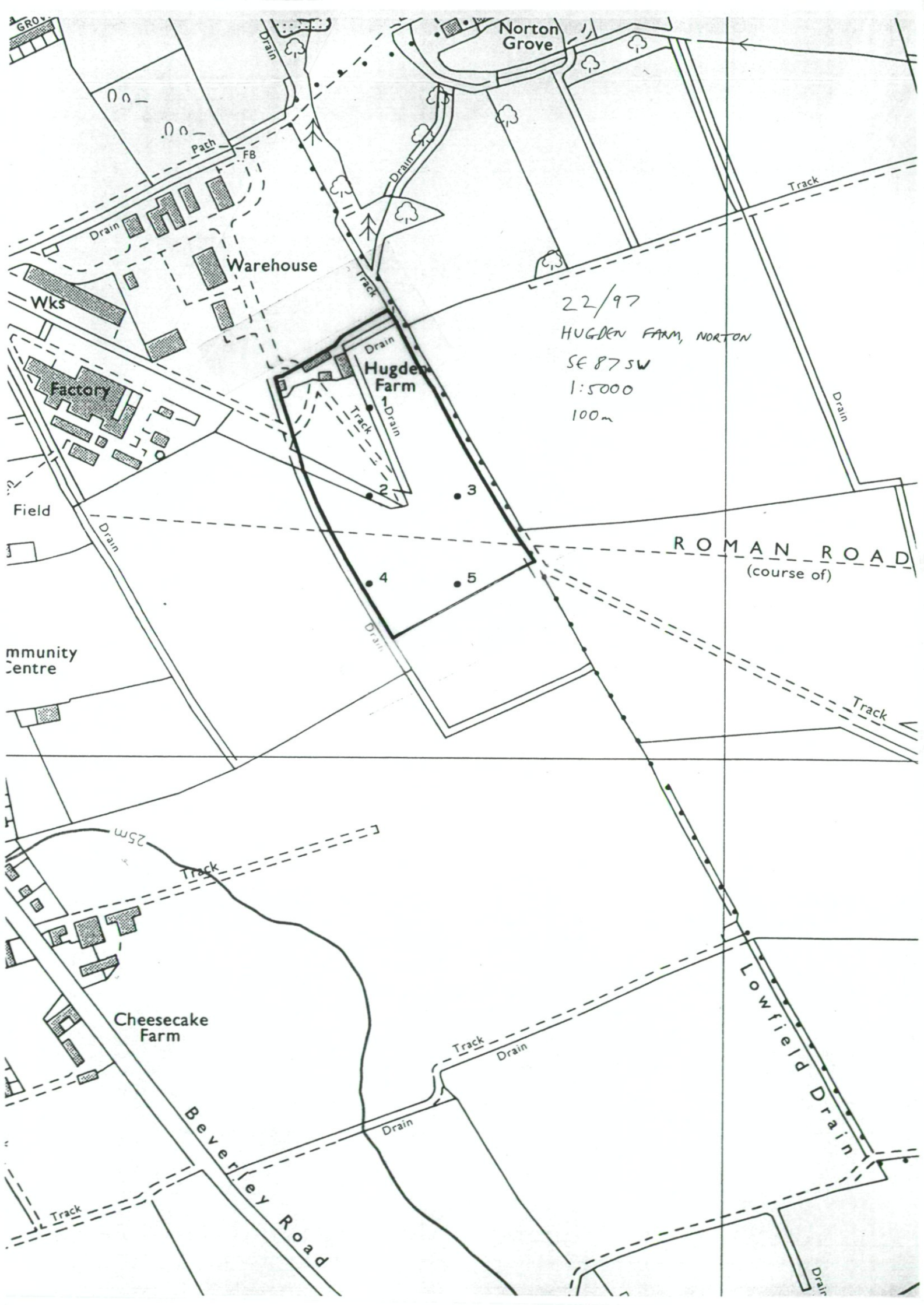

Norton Grove

Warehouse

Hugden Farm

Cheesecake Farm

Beverley Road

ROMAN ROAD
(course of)

22/97
HUGDEN FARM, NORTON
SE 87 SW
1:5000
100m

- 1
- 2
- 3
- 4
- 5

