

Land adjacent to A422/B526, Newport Pagnell.

Agricultural Land Classification



AGRICULTURAL LAND				
Grade	Quality	Area	% of Total	
Grade 1	Not present	excellent	ha	%
Grade 2	Very good	1.1 ha	33%	
Grade 3a	Not present	good	ha	%
Grade 3b	Moderate	2.2 ha	67%	
Grade 4	Not present	poor	ha	%
Grade 5	Not present	very poor	ha	%
Total area of agricultural land			ha	
Agricultural buildings			Not present	
Woodland			Not present	
Not surveyed			Not present	

NON-AGRICULTURAL LAND	
Land predominantly in urban use	Not present
Land in non-agricultural use	Not present
Total area of site	3.3 ha

For further information consult "Agricultural Land Classification of England and Wales (Revised guidelines and criteria for grading the quality of agricultural land)", M.A.F.F., 1988.

SOURCE MAPS
 SP 8842-8942
 8843-8943

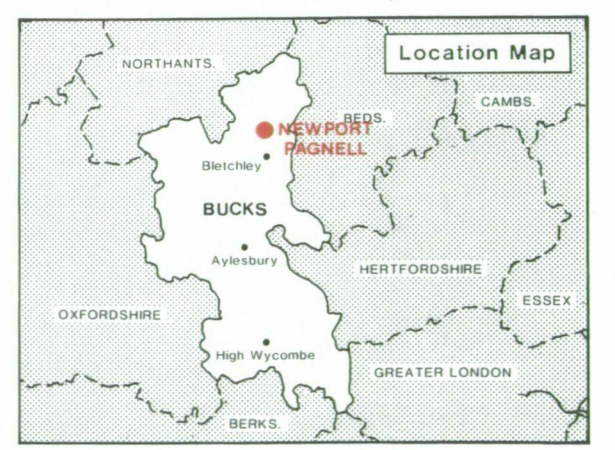

Surveyed by the Resource Planning Group 6/89
 Map compiled and produced by the Cartographic Unit,
 Farm and Countryside Service, South East Region, Reading.
 Reference no. 0304/021/89

Ordnance Survey information reproduced with the sanction of the Controller, H.M.S.O.

Reproduction of this map in whole or in part is prohibited without the prior permission of M.A.F.F.

This map is accurate only at the scale shown.



Land adjacent to A422/B526, Newport Pagnell.

Location of Auger Borings

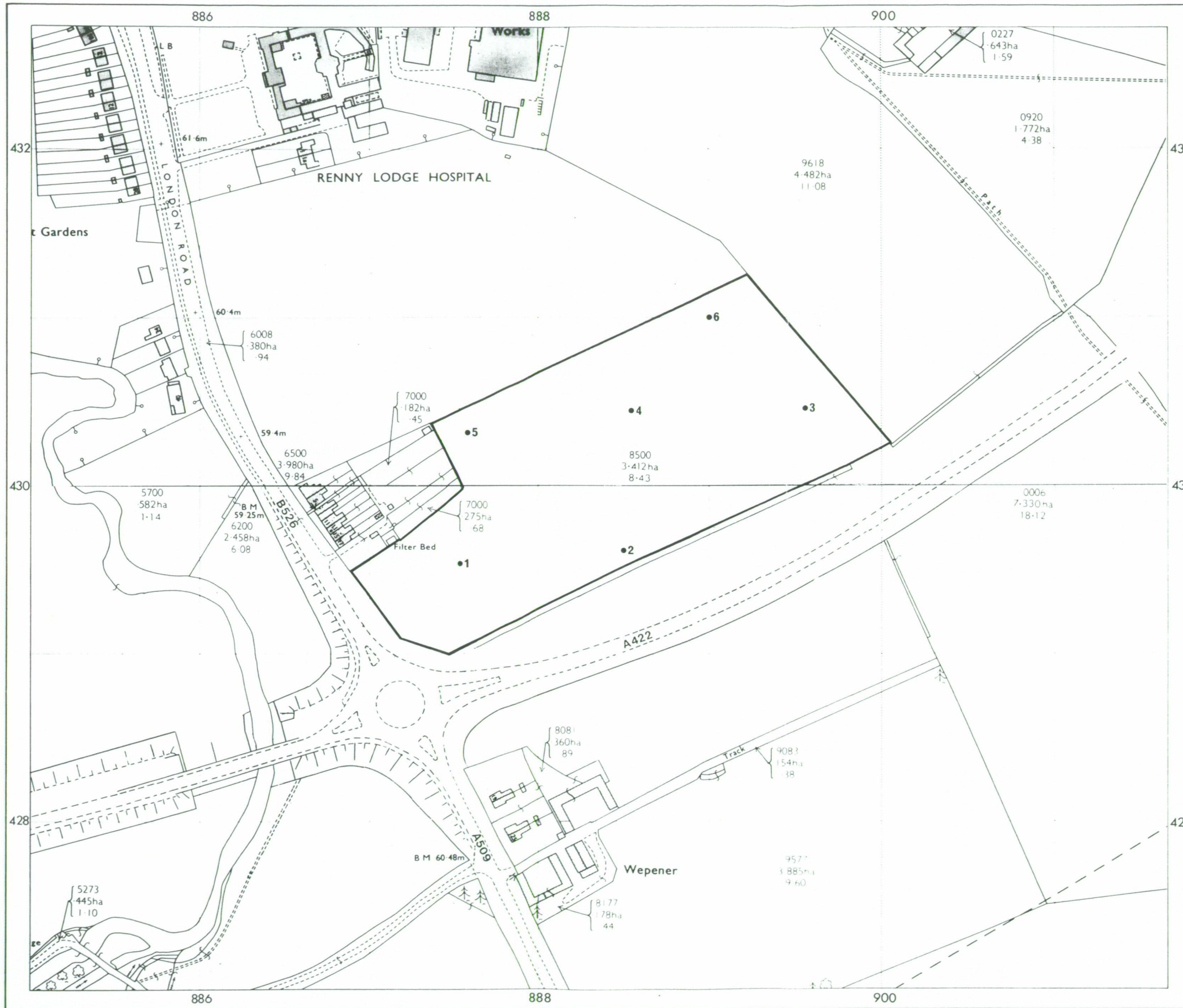

•5 Auger boring

Surveyed by the Resource Planning Group 6/89
 Map compiled and produced by the Cartographic Unit,
 Farm and Countryside Service, South East Region, Reading.

Reference no. 0304/021/89

SOURCE MAPS
 SP 8842-8942
 8843-8943

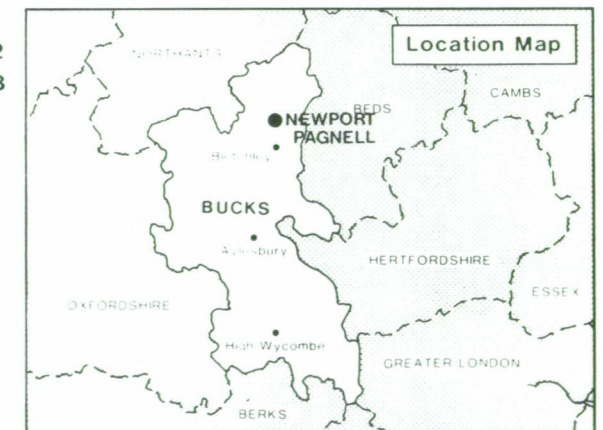

Ordnance Survey information reproduced with the sanction of
 the Controller, H.M.S.O.

Reproduction of this map in whole or in part is prohibited without
 the prior permission of M.A.F.F.

This map is accurate only at the scale shown.