

## Agricultural Land Classification

### GRIMSBY LOCAL PLAN

#### Land At Great Coates

Agricultural Land		
Grade	Quality	Area (ha)
1	Excellent	NIL
2	Very Good	1.5
3a	Good	NIL
3b	Moderate	NIL
4	Poor	NIL
5	Very Poor	NIL

Other Land Categories		
Symbol	Category	Area (ha)
<span style="color: red;">*</span>	Urban	NIL
<span style="color: orange;">*</span>	Non-Agricultural	NIL
<span style="color: brown;">*W</span>	Woodland	NIL
<span style="color: purple;">*</span>	Agricultural Buildings	NIL
<span style="border: 1px solid black; display: inline-block; width: 10px; height: 10px;"></span>	Open Water	NIL
<span style="border: 1px solid black; border-radius: 50%; display: inline-block; width: 10px; height: 10px;"></span>	Not Surveyed	NIL
Total agricultural land area		1.5
Total survey area		1.5

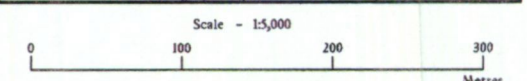

Further details contained in MAFF (1988) Agricultural Land Classification of England and Wales - Revised guidelines and criteria for grading the quality of agricultural land. MAFF (Publications), London SE99 7TP.

The information is accurate at the base map scale but any enlargement would be misleading.

Reproduction in whole or in part by any means is prohibited without the prior permission of MAFF.

Surveyed and drawn by the Resource Planning Team, ADAS Statutory Unit Leeds  
 Based on the 1984/85 Ordnance Survey 1:10,000 map with the permission of the Controller of Her Majesty's Stationery Office.  
 Source Map(s): T/A20NW /21SW  
 Reference no. 088 /94 © Crown Copyright Reserved 1994



88/94

GRIMSBY LOCAL PLAN: LAND AT GREAT COATES

TA20 N10.215W

1:2,500

100 M GRID TA233099

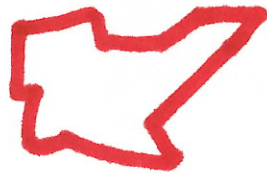

BOUNDARY OF SURVEY AREA

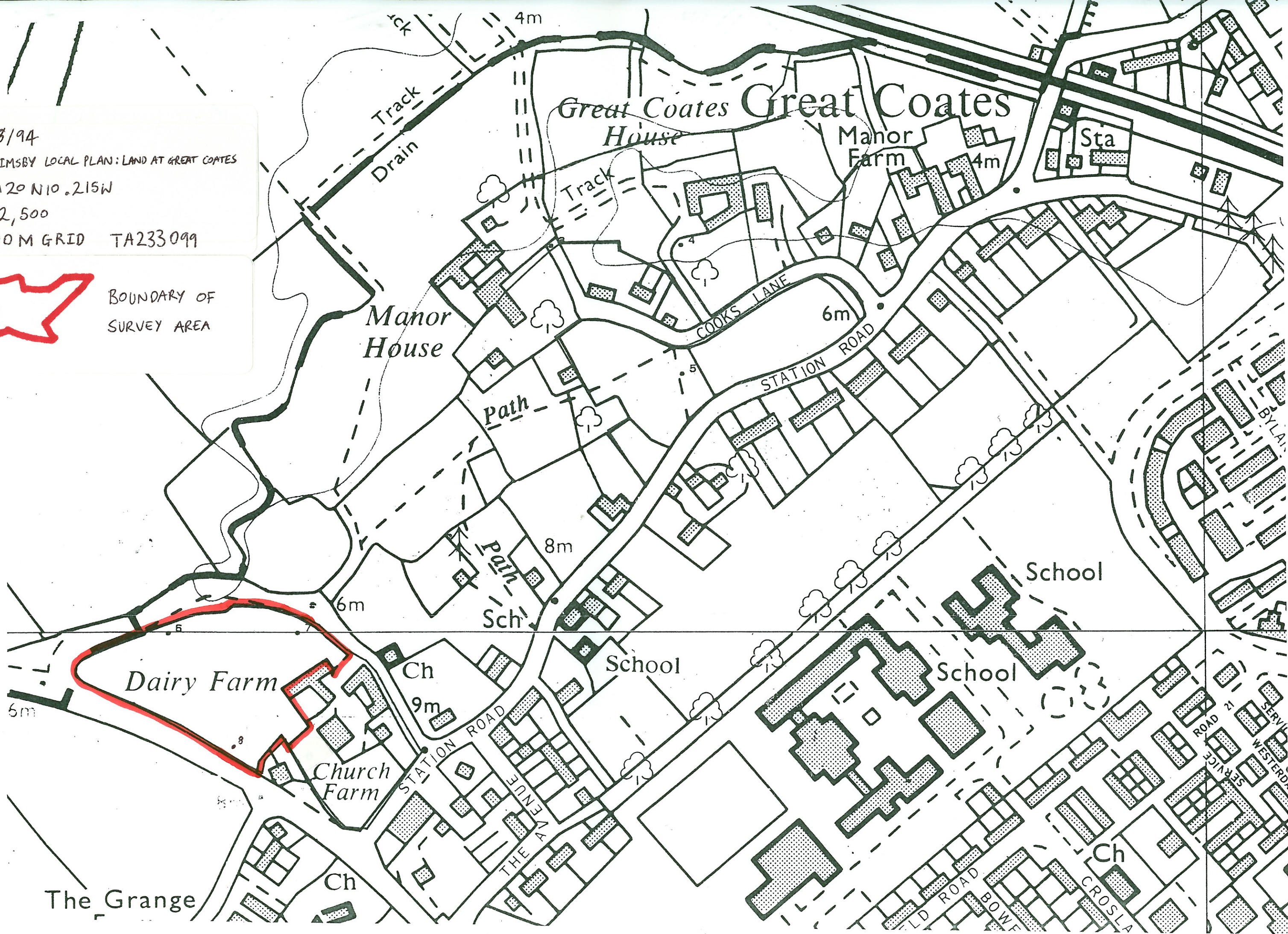

Great Coates House

Manor Farm

Sta

Manor House

COOKS LANE

STATION ROAD

Path

Path

School

Sch

School

School

Dairy Farm

Church Farm

The Grange

STATION ROAD

THE AVENUE

OLD ROAD

BOWE

CROSLA

SERVICE ROAD

WESTERD

BYLAN

SERVICE ROAD