



# AGRICULTURAL LAND CLASSIFICATION

## BILSTHORPE MOOR CLAY EXTRACTION SCHEME

GRADE	LAND QUALITY
1	EXCELLENT
2	
3a	
3b	MODERATE
4	
5	VERY POOR

NON-AGRICULTURAL LAND	
LAND PREDOMINANTLY IN URBAN USE	*
OTHER LAND PRIMARILY IN NON-AGRICULTURAL USE	*
WOODLAND	*
AGRICULTURAL BUILDINGS	*
OPEN WATER	*
LAND NOT SURVEYED	*

\* INDICATES GRADES NOT MAPPED WITHIN THIS SITE

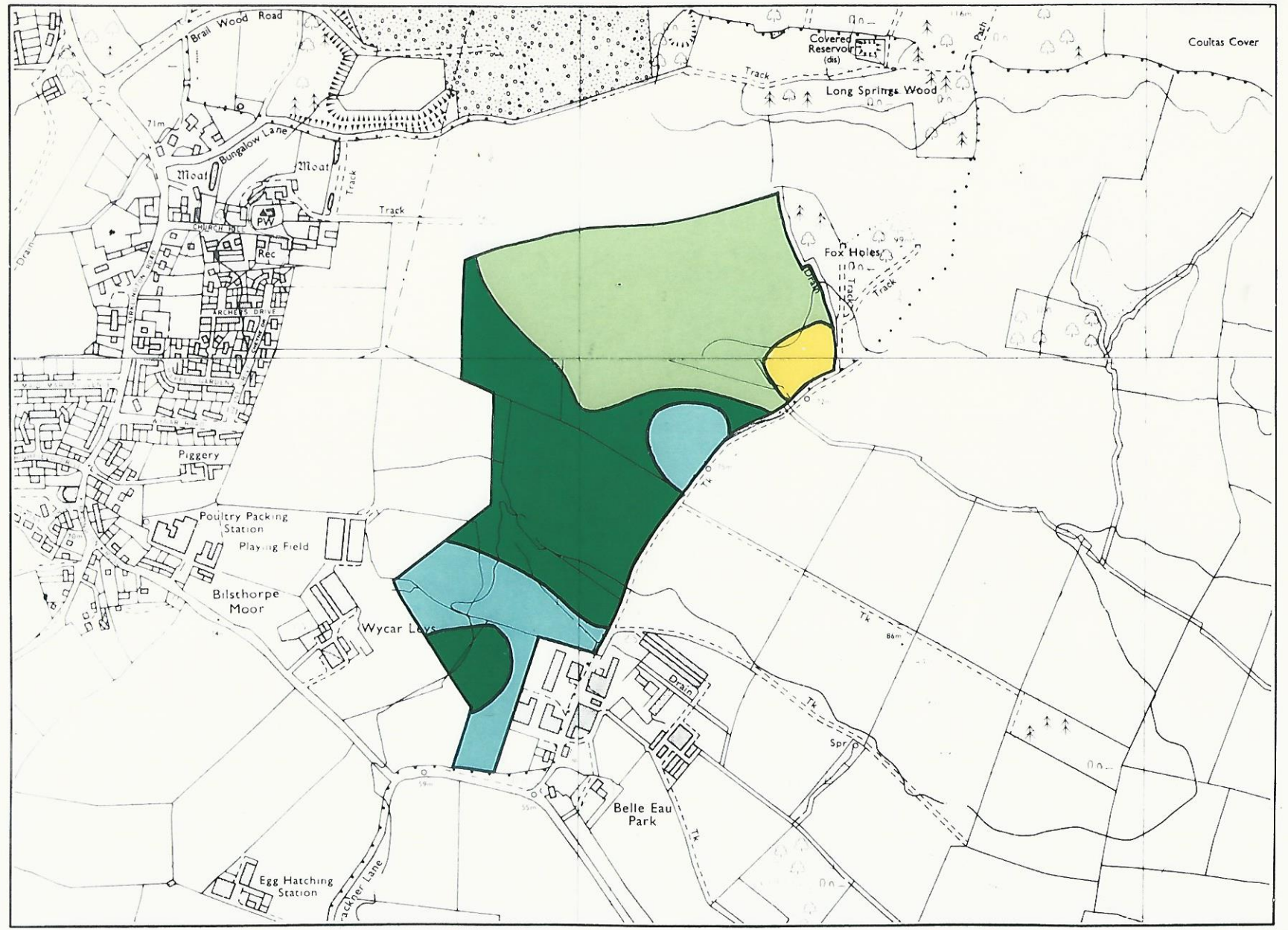
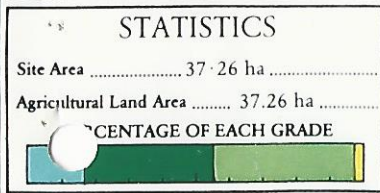
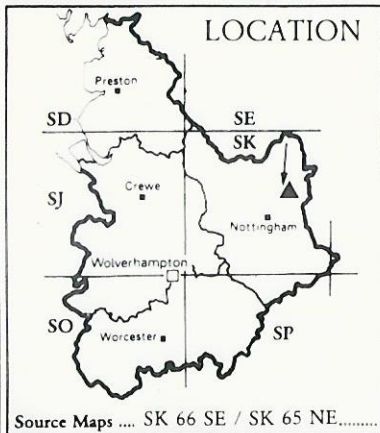

Surveyed by Resource Planning Group  
 Date: Jan 1991 Job No: 034 / 90

Map produced by the Cartographic Unit,  
 Farm and Countryside Service, Wolverhampton R.O.

SCALE 1 : 10000

0 200 400 metres

Ordnance Survey maps reproduced with the permission of the controller, HMSO. ©Crown Copyright Reserved 1990. This map is accurate only at base map scale. Any enlargement would be misleading.

# BILSTHORPE MOOR CLAY EXTRACTION SCHEME

## SOIL RESOURCE MAP

### Unit 1

MCL	25	
HCL/MCL	50-60	
C/HCL	100	

### Unit 2

SZL	35	
SZL/MCL	50	
SZL/SL/ wthr sdst/HCL	100	

### Unit 3

SL/SZL	45	
SL	70	
SL/wthr sdst/ HCL	100	

### LOCATION

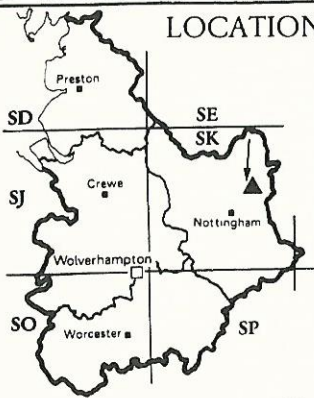

Source Maps ... SK 66 SE / SK 65 NE.....

### STATISTICS

Site Area ..... 37.26 ha .....

Agricultural Land Area ..... 37.26 ha .....

PERCENTAGE OF EACH GRADE

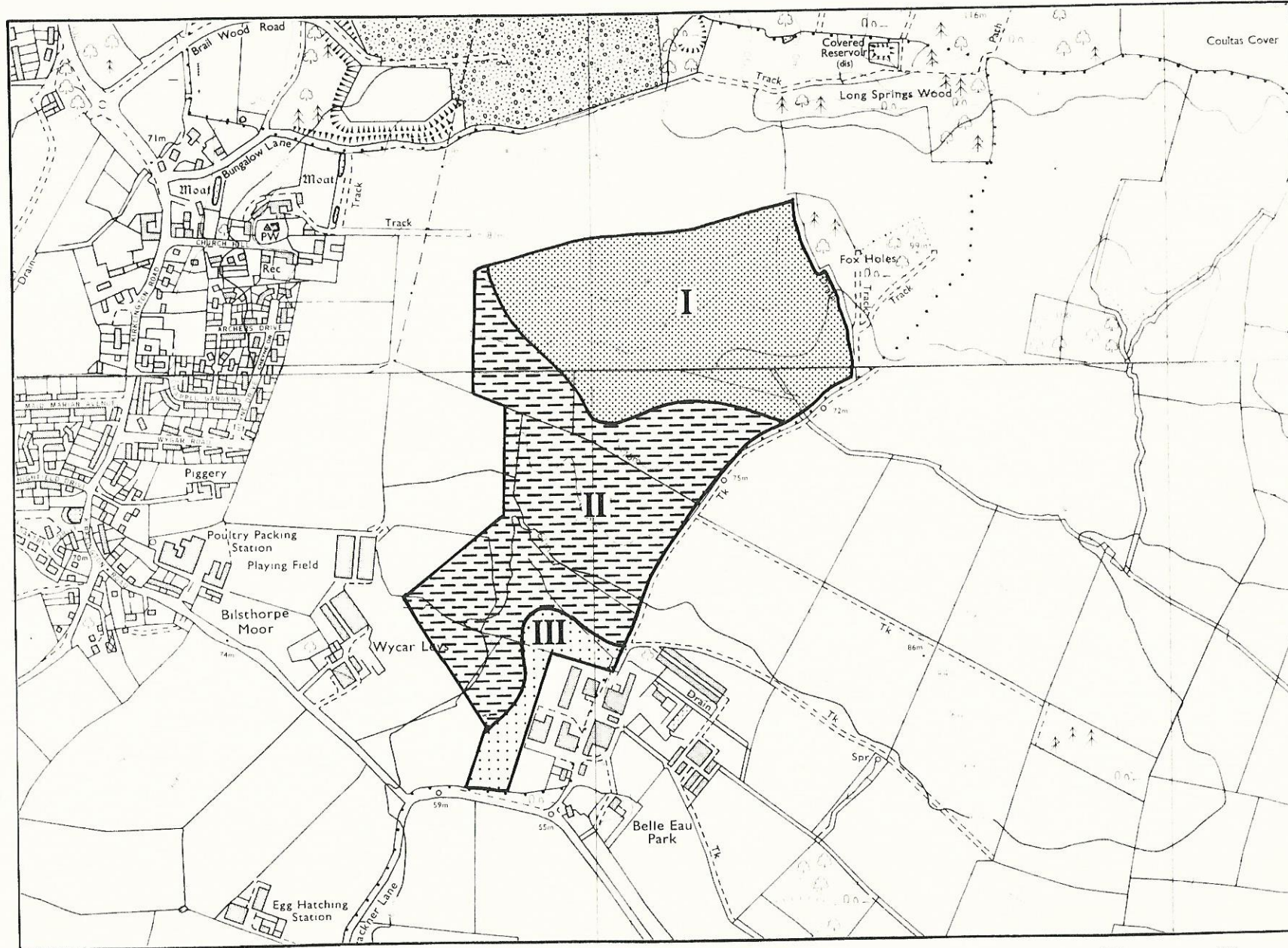

Surveyed by Resource Planning Group

Map produced by the Cartographic Unit,

SCALE 1 : 10000



Date .... Jan 1991 ..... Job No. .... 034 / 90 .....

Farm and Countryside Service, Wolverhampton R.O.

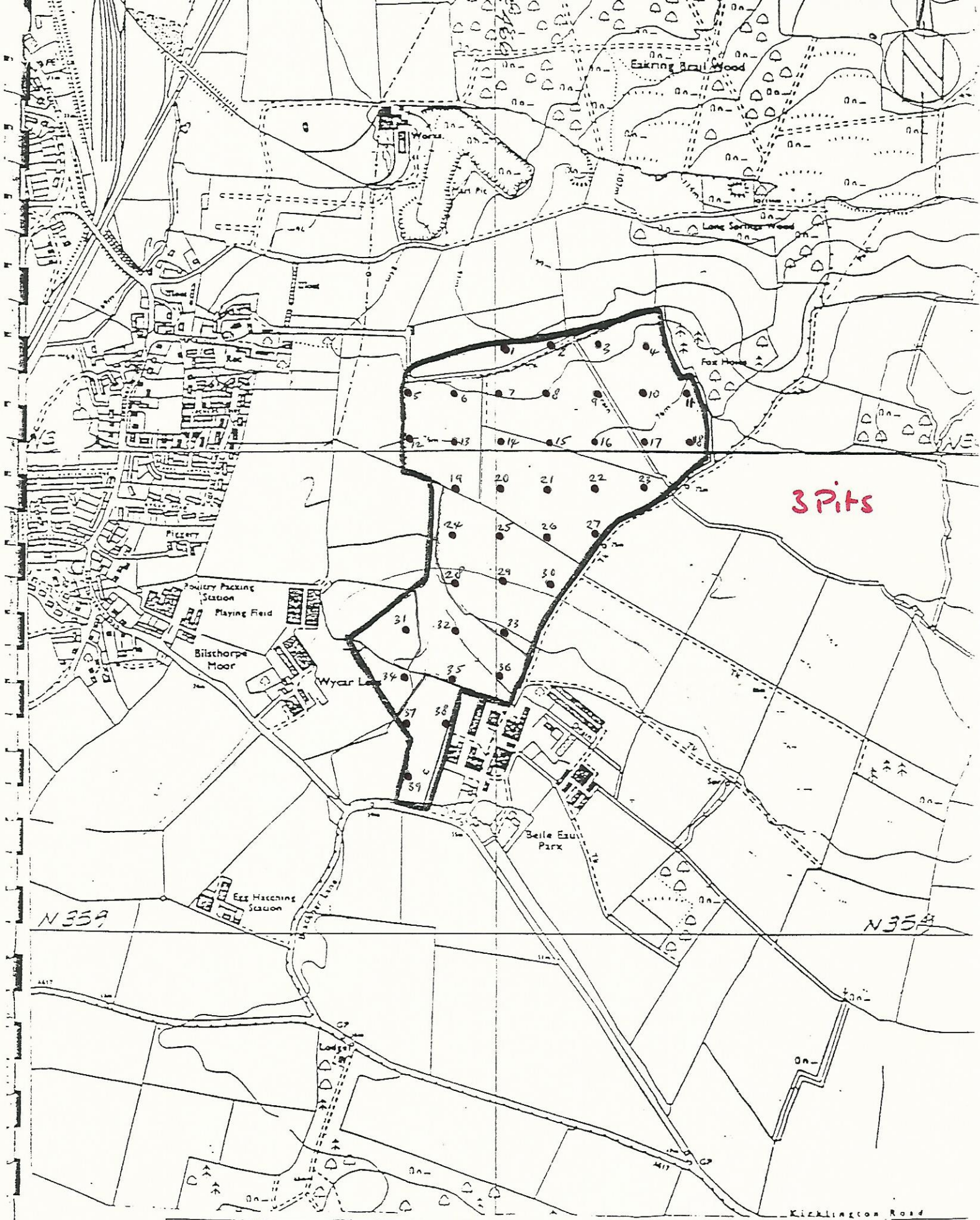

FIGURE 1.1 - Location plan.

Proposed site for new brick factory  
and associated clay extraction scheme.

Salvesen Brick Ltd. - August 1990