

Agricultural Land Classification

Little Langford, Steeple Langford

Legend		
	Quality	Area (ha)
Grade 1	Excellent	0.0
Grade 2	Very Good	0.0
Grade 3a	Good	0.0
Grade 3b	Moderate	19.3
Grade 4	Poor	0.0
Grade 5	Very Poor	0.0
	Agricultural land not surveyed	0.0
	Other land	0.0
	Boundary of survey area	
Total agricultural land area		19.3
Total survey area		19.3
* Not present within survey area		

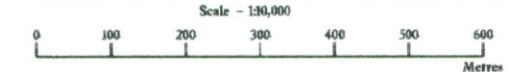



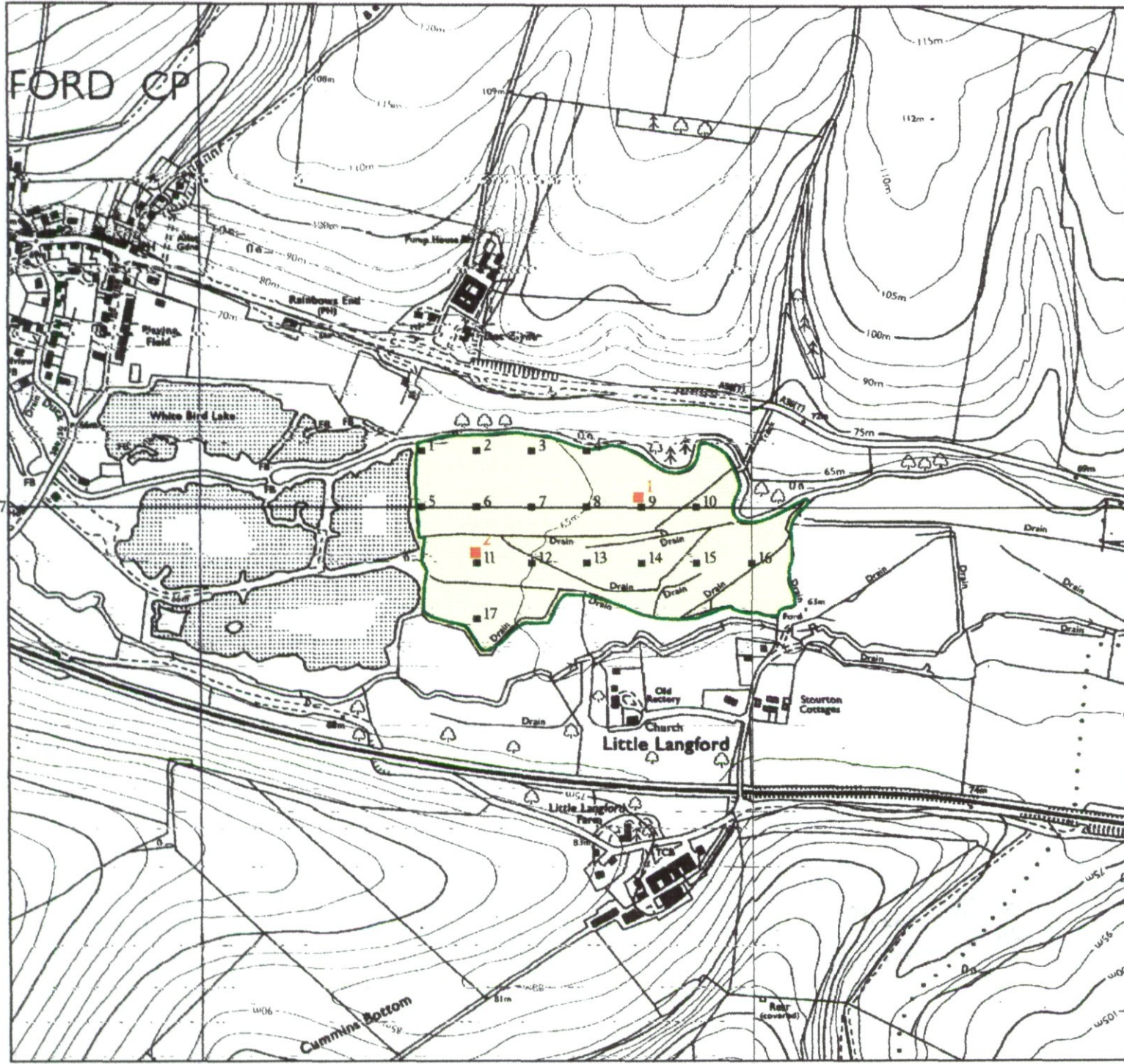

Further details contained in MAFF (1988) Agricultural Land Classification of England and Wales - Revised guidelines and criteria for grading the quality of agricultural land. MAFF (publications), London SE99 7TP. The information is accurate at base map scale but any enlargement would be misleading. Reproduction in whole or in part by any means is prohibited without the prior permission of MAFF.

Surveyed and drawn by the Resource Planning Team, FRCA Western Region.
 Based on the 1985 Ordnance Survey 1:10,000 map with the permission of the Controller of Her Majesty's Stationery Office. Unauthorised reproduction infringes Crown copyright and may lead to prosecution or civil proceedings. MAFF Licence No: GD272361
 Source map(s): SU03NW, NE
 Reference no: 03/98 © Crown Copyright Reserved 1998



Agricultural Land Classification
Little Langford,
Steeple Langford
Sample Point Map

Legend

-  Location of soil pit
-  Location of auger sample point
-  Boundary of survey area
-  Agricultural land not surveyed
-  Other land

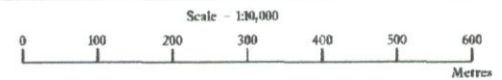

Further details contained in MAFF (1988) Agricultural Land Classification of England and Wales - Revised guidelines and criteria for grading the quality of agricultural land. MAFF (publications), London SE99 7TP. The information is accurate at base map scale but any enlargement would be misleading. Reproduction in whole or in part by any means is prohibited without the prior permission of MAFF.

Surveyed and drawn by the Resource Planning Team, FRCA Western Region. Based on the 1985 Ordnance Survey 1:10,000 map with the permission of the Controller of Her Majesty's Stationery Office. Unauthorised reproduction infringes Crown copyright and may lead to prosecution or civil proceedings. MAFF Licence No: GD272361 Source map(s): SU03NW, NE Reference no: 03/98 © Crown Copyright Reserved 1998

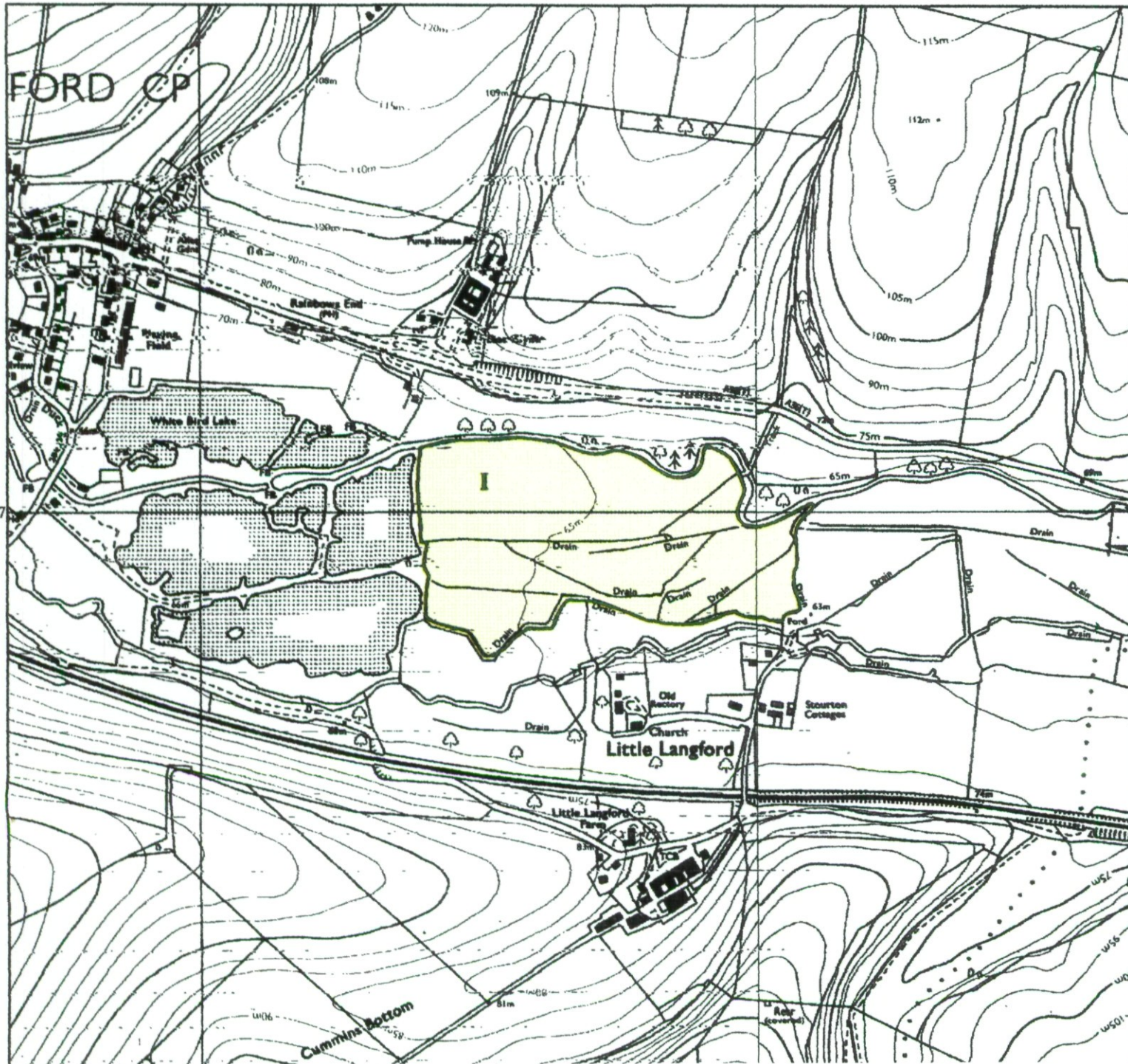



Agricultural Land Classification
Little Langford,
Steeple Langford
Soil Resources Map

Legend

Refer to separate schedule for details of soil map units

Soil Unit	Area (ha)
I	19.30

	Agricultural land not surveyed	0.0
	Other land	0.0

Further details contained in MAFF (1988) Agricultural Land Classification of England and Wales - Revised guidelines and criteria for grading the quality of agricultural land. Maff (publications), London SE99 7TP. The information is accurate at base map scale but any enlargement would be misleading. Reproduction in whole or in part by any means is prohibited without the prior permission of MAFF.

Surveyed and drawn by the Resource Planning Team, FRCA Western Region. Based on the 1985 Ordnance Survey 1:10,000 map with the permission of the Controller of Her Majesty's Stationery Office. Unauthorised reproduction infringes Crown copyright and may lead to prosecution or civil proceedings. MAFF Licence No: GD272361 Source map(s): SU03NW, NE Reference no: 03/98 © Crown Copyright Reserved 1998