

Agricultural Land Classification

Land at Thorpe Hall
Thorpe-Le-Soken, Essex

Legend

	Quality	Area (ha)
Grade 1	Excellent	nil
Grade 2	Very Good	nil
Grade 3a	Good	22.0
Grade 3b	Moderate	18.4
Grade 4	Poor	nil
Grade 5	Very Poor	nil
	Agricultural land not surveyed	nil
	Other land	8.6
	Boundary of survey area	

Total agricultural land area 40.4

Total survey area 49.0

* Not present within survey area

Scale - 1:40,000

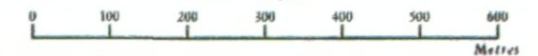

Further details contained in MAFF (1988) Agricultural Land Classification of England and Wales - Revised guidelines and criteria for grading the quality of agricultural land. MAFF (publications), London SE99 7TP.

The information is accurate at base map scale but any enlargement would be misleading.

Reproduction in whole or in part by any means is prohibited without the prior permission of MAFF.

Surveyed and drawn by the Resource Planning Team, ADAS Statutory Unit, Huntingdon.

Based on the 1979 Ordnance Survey 10000 map with the permission of the Controller of Her Majesty's Stationery Office. Unauthorised reproduction infringes Crown copyright and may lead to prosecution or civil proceedings.

MAFF Licence No: GD272361

Source map(s): TM12SE

Reference no: 20/96

© Crown Copyright Reserved 1996

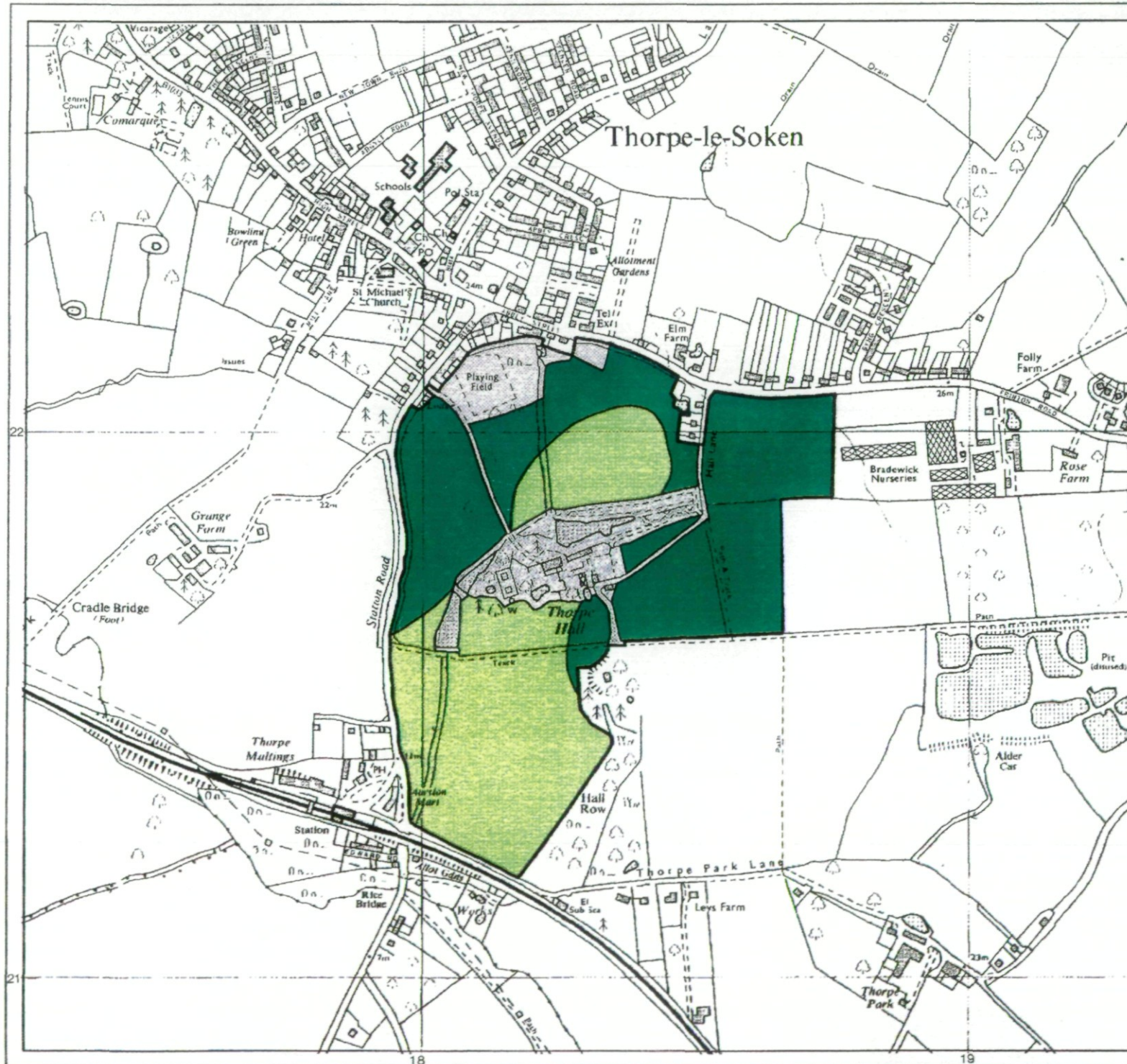

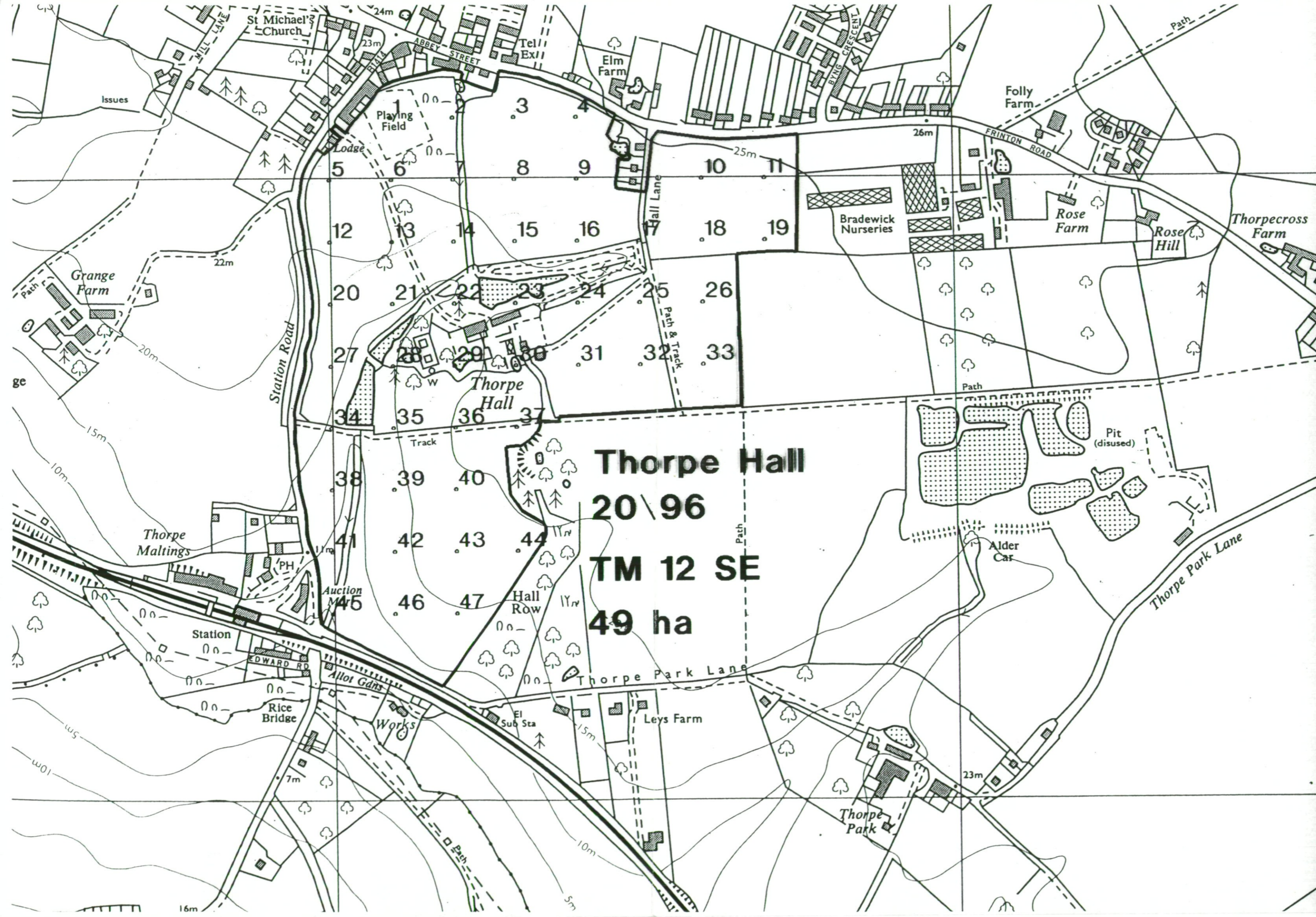

Thorpe Hall
20 \ 96
TM 12 SE
49 ha

St Michael's Church

Folly Farm

FRINTON ROAD

Rose Farm

Rose Hill

Thorpecross Farm

Bradewick Nurseries

Grange Farm

Thorpe Hall

Pit (disused)

Thorpe Maltings

Alder Car

Station

Auction

Thorpe Park Lane

Leys Farm

Thorpe Park

Rice Bridge

Works

Sub Sta

EDWARD RD

Allot Gdns

Issues

Hall Row

Playing Field

Lodge

Elm Farm

Tel Ex

ABBEY STREET

BING CRESCENT

Station Road

Hall Lane

Path & Track

Thorpe Park Lane

7m

10m

5m

23m

5m

10m

10m

15m

20m

22m

24m

23m

25m

26m

16m

ge

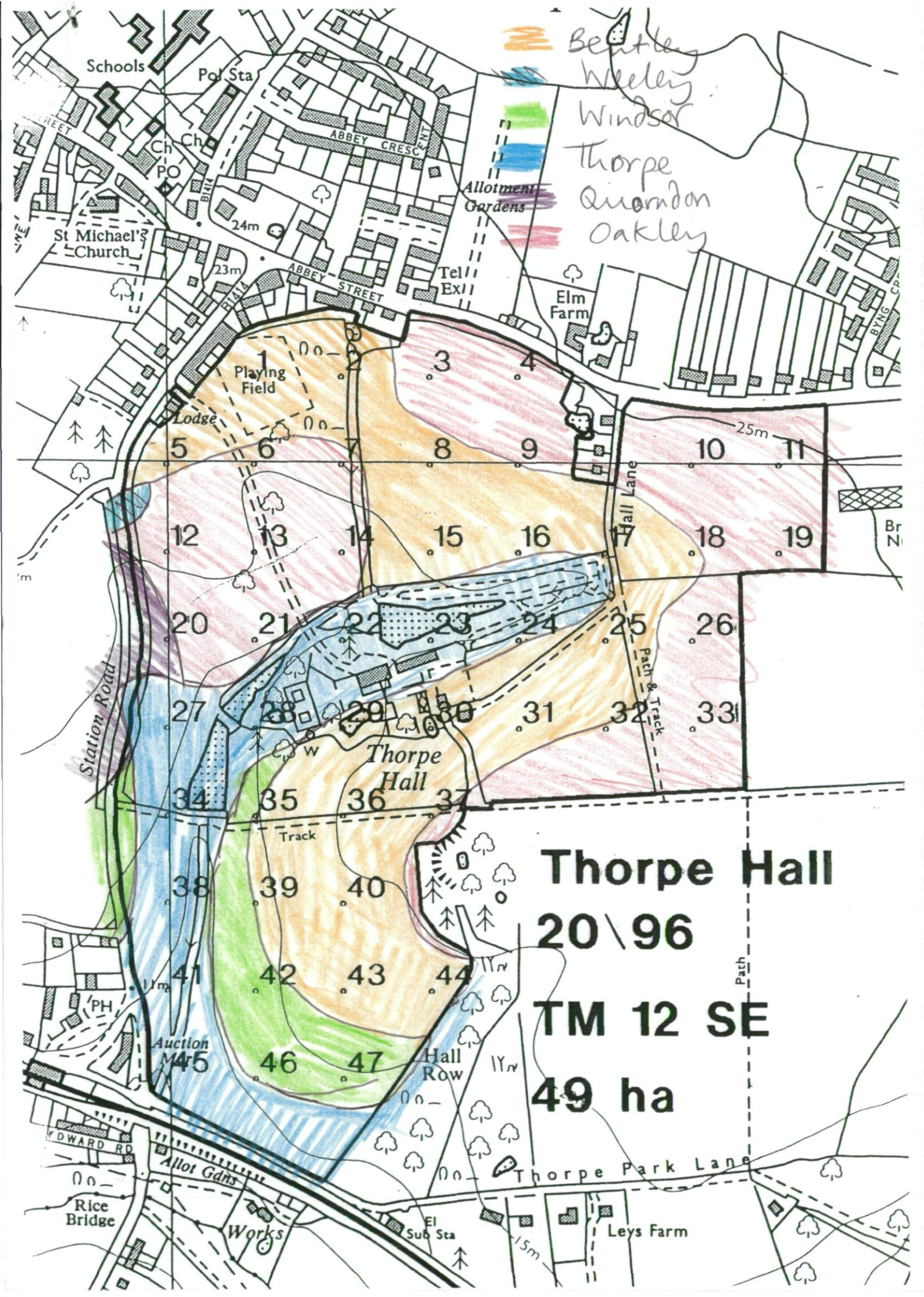

 Beattley
 Wreley
 Windsor
 Thorpe
 Quorndon
 Oakley

Thorpe Hall
20 \ 96
TM 12 SE
49 ha