

SANDS TOP QUARRY

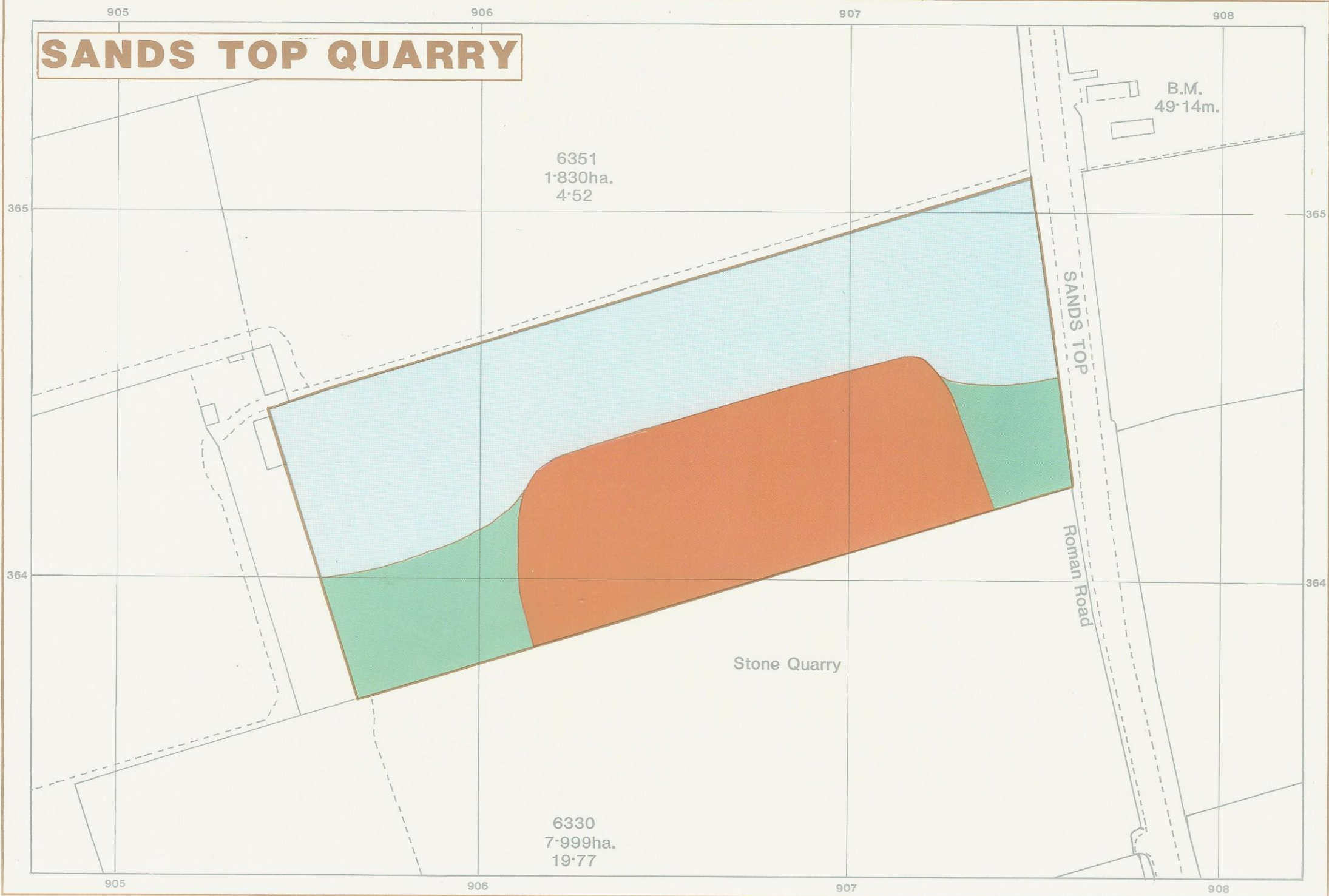

SANDS TOP QUARRY NORTH NEWBALD

Proposed
Limestone Extraction Site

Agricultural Land Classification

SCALE 1:1,250



Agricultural Land		
Agricultural Grades	Agricultural Land Quality	Area within the site (ha.)
Grade 1	Excellent	Nil
Grade 2	Very Good	0.9
Grade 3	Good	0.2
Sub-Grade 3a	Moderate	Nil
Sub-Grade 3b	Poor	Nil
Grade 4	Poor	Nil
Grade 5	Very Poor	Nil

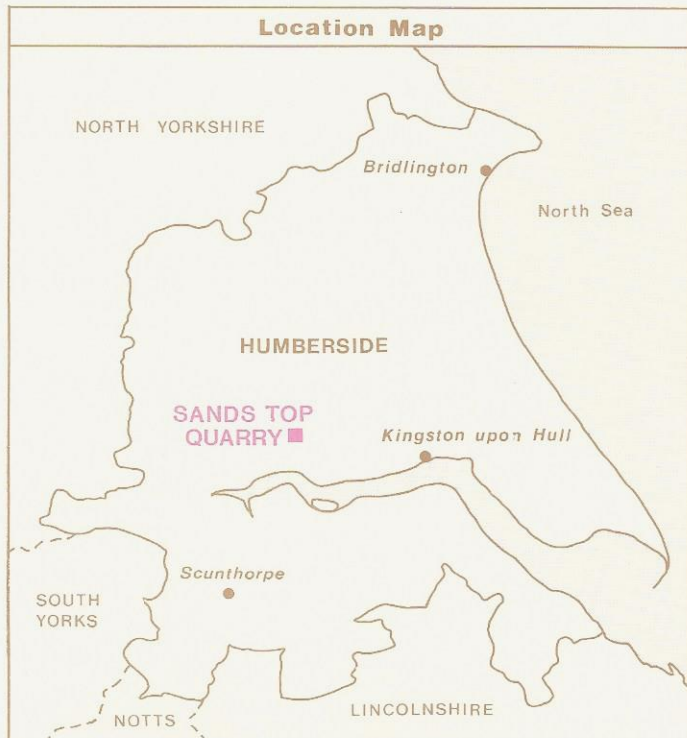
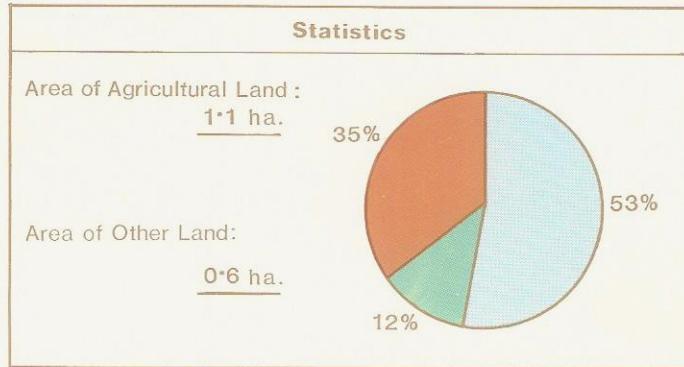

Land in Other Categories		Area within the site (ha.)
Urban <i>Including housing, industry, commerce, derelict land, sports facilities, transport.</i>		0.6
Non-agricultural <i>Including golf courses, parks, sports fields, allotments, airfields.</i>		Nil
Woodland <i>Farm woodland</i>		Nil
<i>Commercial woodland</i>		Nil
Agricultural buildings <i>Including glasshouses</i>		Nil
Open water		Nil
Land not surveyed		Nil

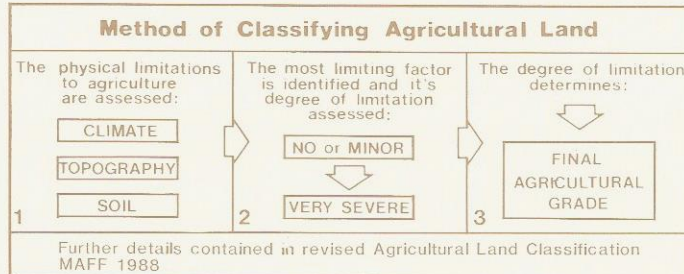

Ministry of Agriculture,
Fisheries and Food.

Information compiled by Resource Planning Group, Farm and Countryside Service, Leeds R.O.
Map produced by Resource Planning Cartographic Unit, Project Number 74/89
Ordnance Survey maps reproduced with the permission of the Controller, H.M.S.O.
© Crown Copyright Reserved 1989

SOURCE MAPS
1:2,500
SE 9036-9136

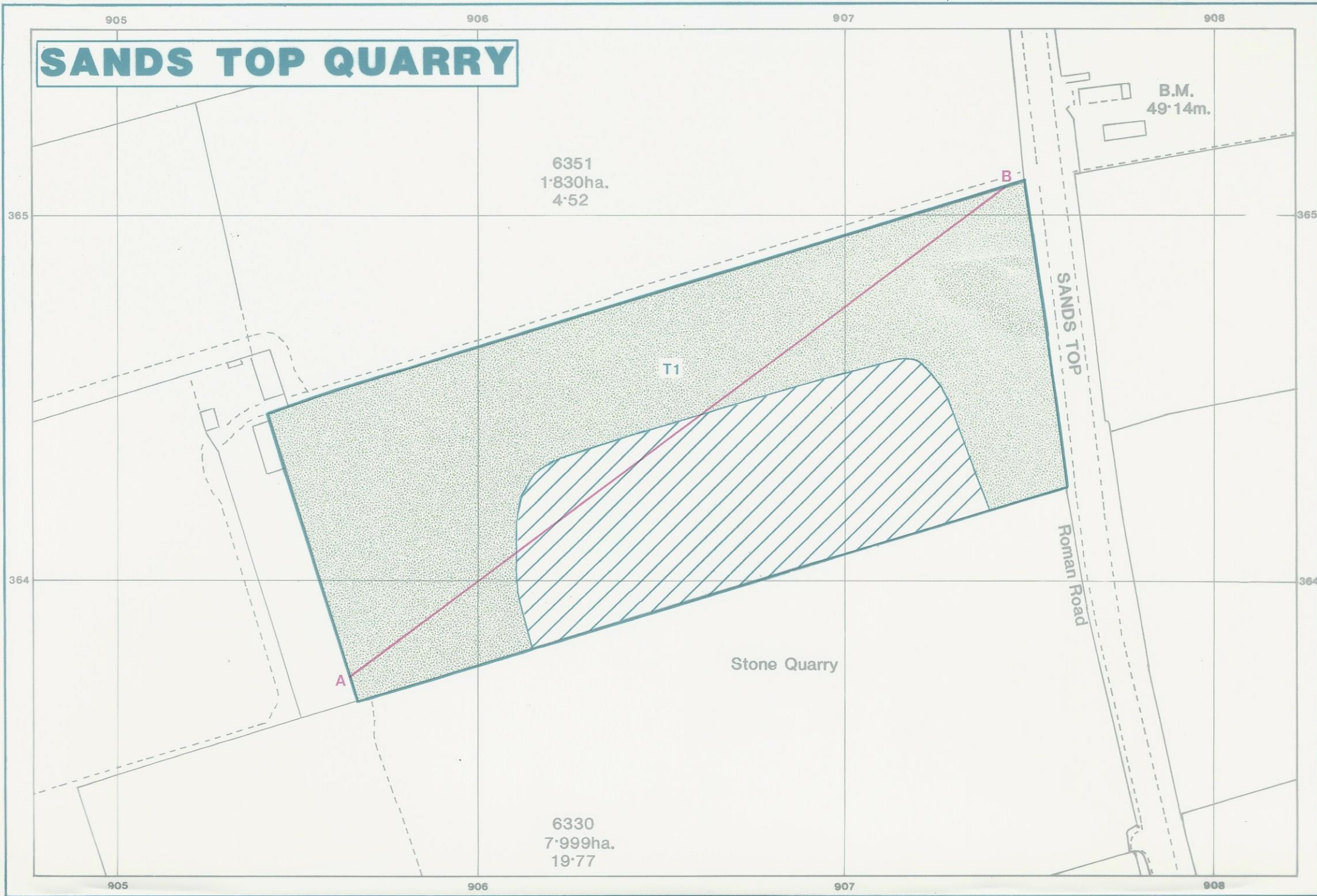

SANDS TOP QUARRY

NORTH NEWBALD

Proposed Limestone Extraction Site

Topsoil Resource Map

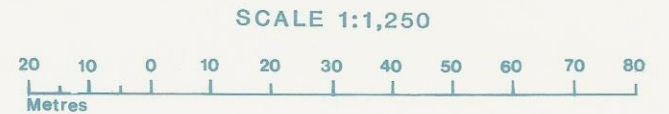

Unit	Soil Texture	Soil Thickness(cm.)			Area (ha.)	Volume* (000m ³)
		Min.	Mean	Max.		
T1	Light	20	25	30	1·1	2·75

* Volume at mean soil depth.

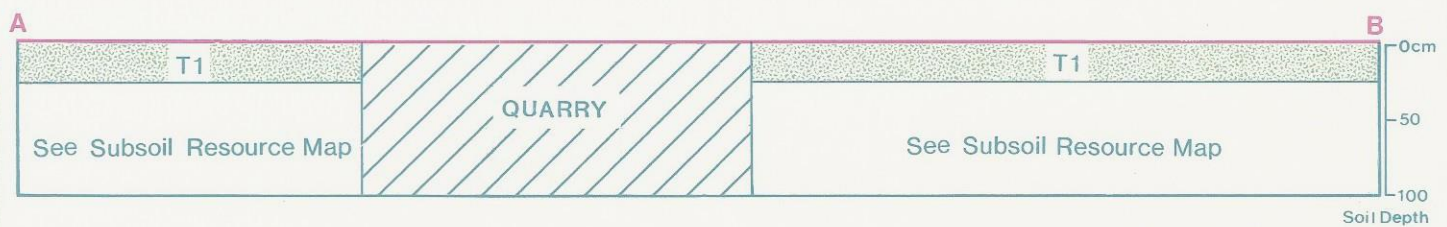

Ministry of Agriculture,
Fisheries and Food.

Information compiled by Resource Planning Group,
Farm and Countryside Service, Leeds R.O.
Map produced by Resource Planning Cartographic Unit,
Project Number 74/89
Ordnance Survey maps reproduced with the
permission of the Controller, H.M.S.O.
© Crown Copyright Reserved 1989

SOURCE MAPS

1:2,500
SE 9036-9136

SANDS TOP QUARRY

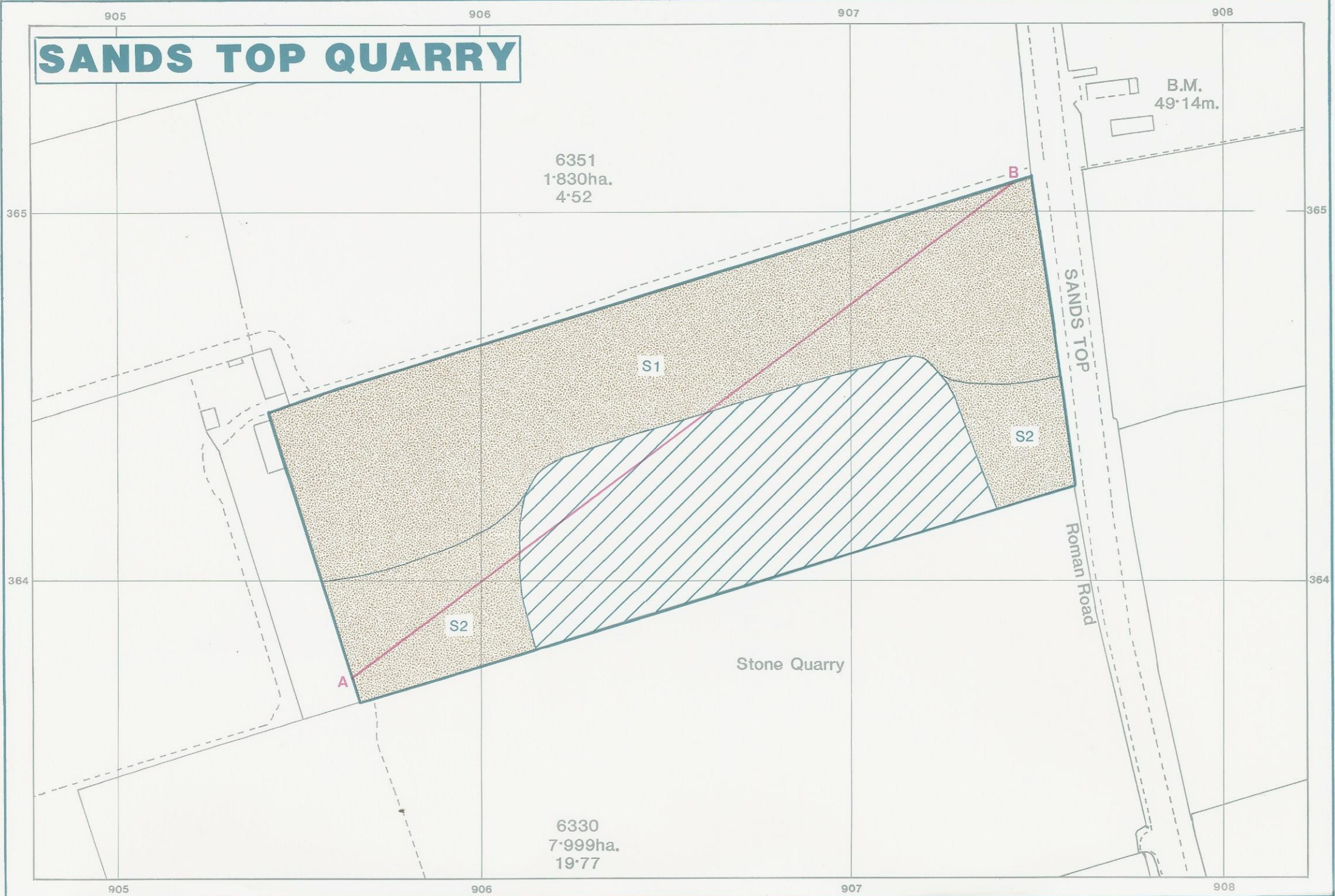

SANDS TOP QUARRY NORTH NEWBALD

Proposed
Limestone Extraction Site

Subsoil Resource Map

SCALE 1:1,250



Unit	Soil Texture	Mean Soil Thickness(cm)	Area (ha)	Volume (000m ³)
S1	Light	75	0.9	6.75
S2	Light/ Very Light	45	0.2	0.90

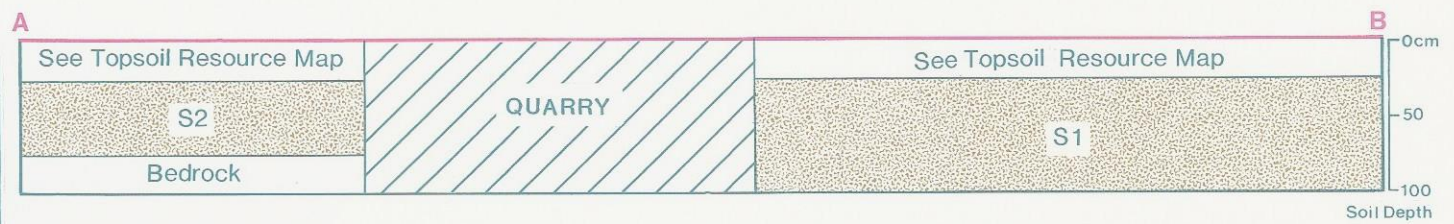
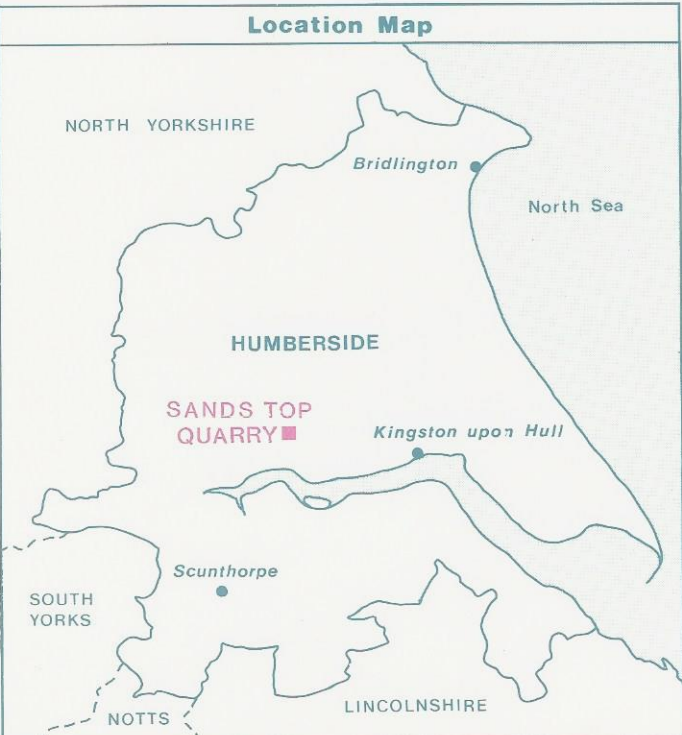

Ministry of Agriculture,
Fisheries and Food.

Information compiled by Resource Planning Group,
Farm and Countryside Service, Leeds R.O.
Map produced by Resource Planning Cartographic Unit,
Project Number 74/89
Ordnance Survey maps reproduced with the
permission of the Controller, H.M.S.O.
© Crown Copyright Reserved 1989

SOURCE MAPS

1:2,500
SE 9036-9136

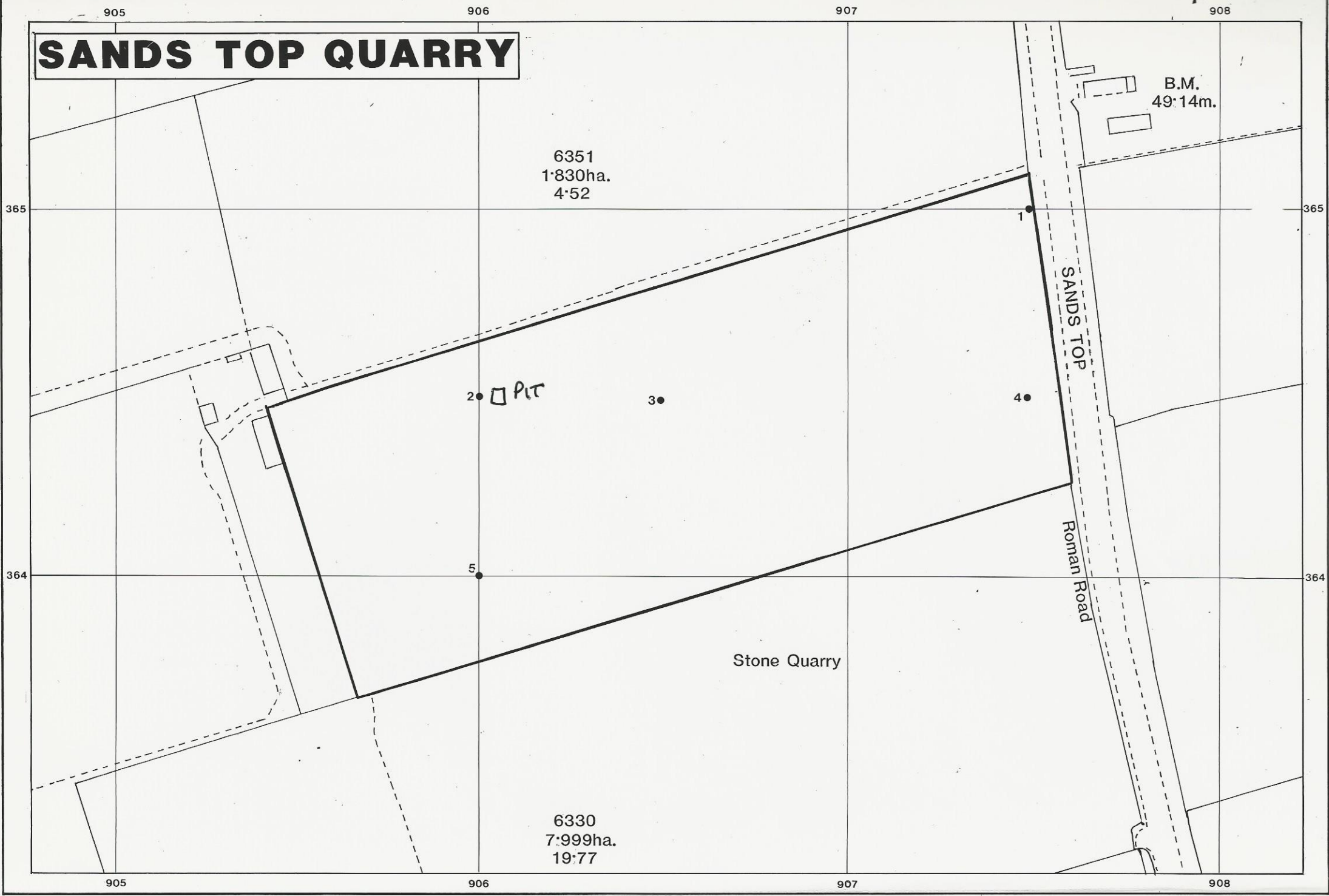

SANDS TOP QUARRY

NORTH NEWBALD

Proposed Limestone Extraction Site

Agricultural Land Classification

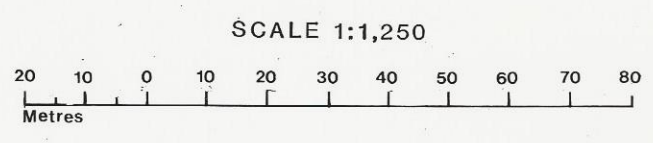

Location of Soil Auger Borings

Soil Auger Borings •

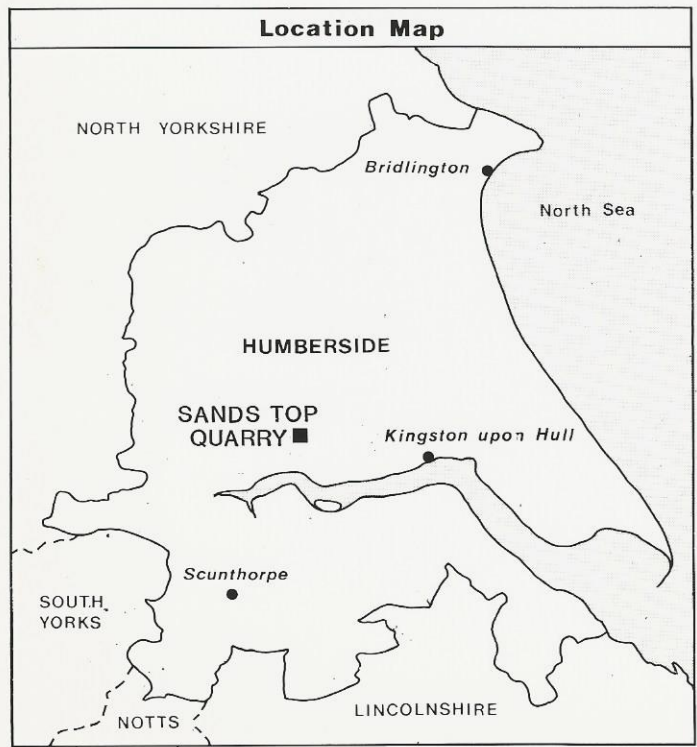

MAFF Ministry of Agriculture, Fisheries and Food.

Information compiled by Resource Planning Group, Farm and Countryside Service, Leeds R.O.
 Map produced by Resource Planning Cartographic Unit, Project Number 74/89
 Ordnance Survey maps reproduced with the permission of the Controller, H.M.S.O.
 © Crown Copyright Reserved 1989

SOURCE MAPS
 SE 9036-9136