

AGRICULTURAL LAND CLASSIFICATION

LAND SOUTH OF MANSFIELD

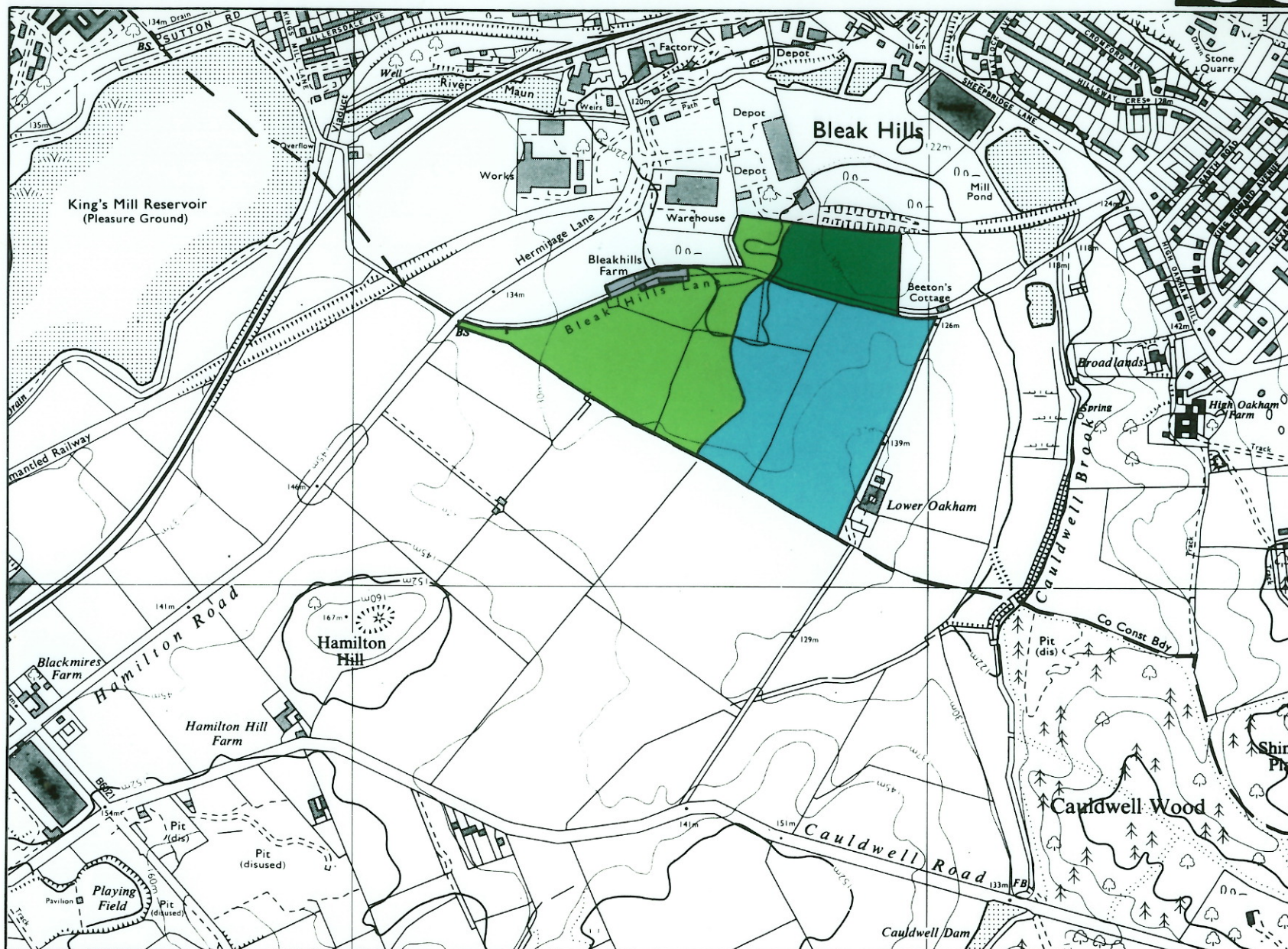

AGRICULTURAL LAND GRADE	LAND QUALITY
1	EXCELLENT
2	
3a	
3b	MODERATE
4	
5	VERY POOR

NON-AGRICULTURAL LAND	
LAND PREDOMINANTLY IN URBAN USE	*
OTHER LAND PRIMARILY IN NON-AGRICULTURAL USE	*
WOODLAND	*
AGRICULTURAL BUILDINGS	
OPEN WATER	*
LAND NOT SURVEYED	*

* INDICATES GRADES NOT MAPPED WITHIN THIS SITE

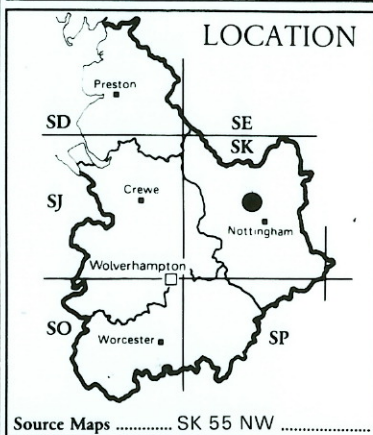

STATISTICS

Site Area 33.76 ha

Agricultural Land Area 33.16 ha

PERCENTAGE OF EACH GRADE

Grade	Percentage
1	~10%
2	~15%
3a	~10%
3b	~15%
4	~10%
5	~10%

Surveyed by Resource Planning Group
 Date... Jun 1990 Job No..... 013 / 90

Map produced by the Cartographic Unit,
 Farm and Countryside Service, Wolverhampton R.O.
 4FCS RPG 6823

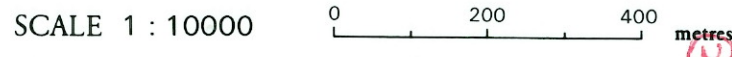

Ordnance Survey maps reproduced with the permission of the controller, HMSO. ©Crown Copyright Reserved 1990. This map is accurate only at base map scale. Any enlargement would be misleading.