

AGRICULTURAL LAND CLASSIFICATION

ANKER OCC

| AGRICULTURAL LAND GRADE | LAND QUALITY |
|-------------------------|--------------|
| 1 | EXCELLENT |
| 2 | |
| 3a | |
| 3b | MODERATE |
| 4 | |
| 5 | VERY POOR |

| NON-AGRICULTURAL LAND | Symbol |
|--|------------|
| LAND PREDOMINANTLY IN URBAN USE | * |
| OTHER LAND PRIMARILY IN NON-AGRICULTURAL USE | Orange box |
| WOODLAND | W |
| AGRICULTURAL BUILDINGS | * |
| OPEN WATER | * |
| LAND NOT SURVEYED | * |

* INDICATES GRADES NOT MAPPED WITHIN THIS SITE

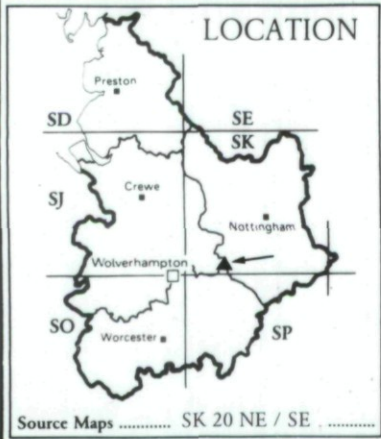

STATISTICS

Site Area 143.9 ha

Agricultural Land Area 138.7 ha

PERCENTAGE OF EACH GRADE

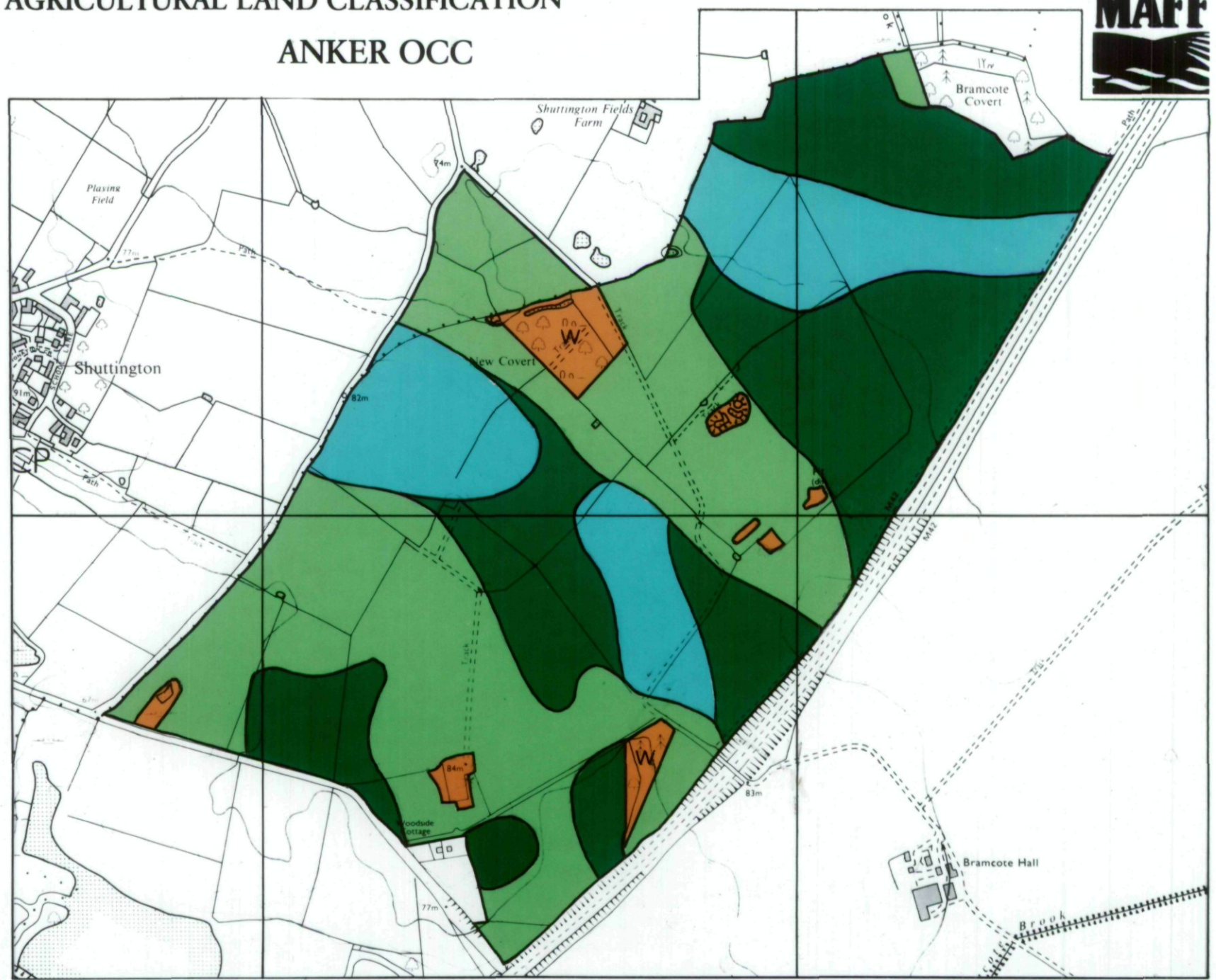

SOIL RESOURCE MAP

ANKER OCC



| | | |
|-----------------------------|-----------|--|
| CL/SCL SCL-CL(h) CL-C | 1a | |
| Organic topsoil | 1b | |
| SL-SZL SL-CL | 2 | |
| SL LS-SCL C | 3 | |
| CL/SCL CL(h) C/ZC | 4a | |
| Organic topsoil | 4b | |
| SL LS Sst | 5 | |
| No soil | 6 | |

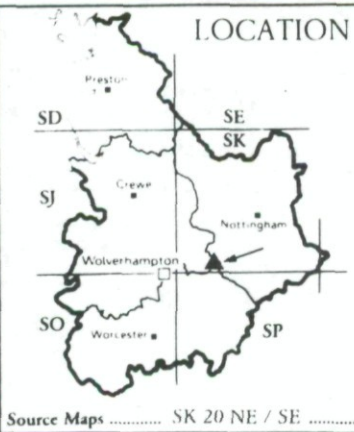

STATISTICS

Site Area 143.9 ha

Agricultural Land Area 138.7 ha

PERCENTAGE OF EACH GRADE

| | | | | | | | |
|----|----|---|---|----|----|---|---|
| 1a | 1b | 2 | 3 | 4a | 4b | 5 | 6 |
| | | | | | | | |

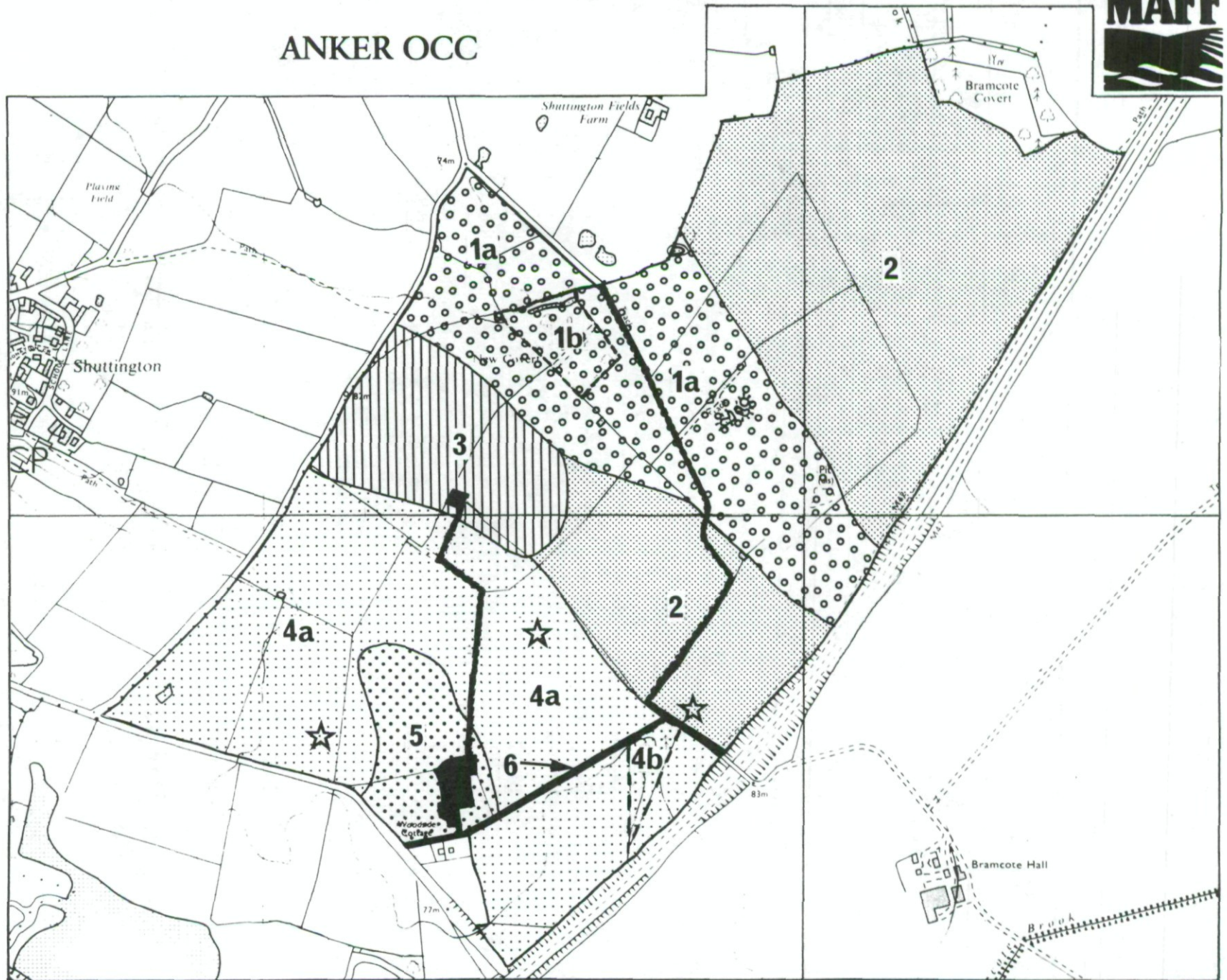

Surveyed by Resource Planning Group
 Date Jan 1991 Job No. 010 / 90
 4FCS RPG 6768

Map produced by the Cartographic Unit,
 Farm and Countryside Service, Wolverhampton R.O.

SCALE 1 : 10000

0 200 400 metres

Ordnance Survey maps reproduced with the permission of the controller, HMSO. ©Crown Copyright Reserved 1990. This map is accurate only at base map scale. Any enlargement would be misleading.

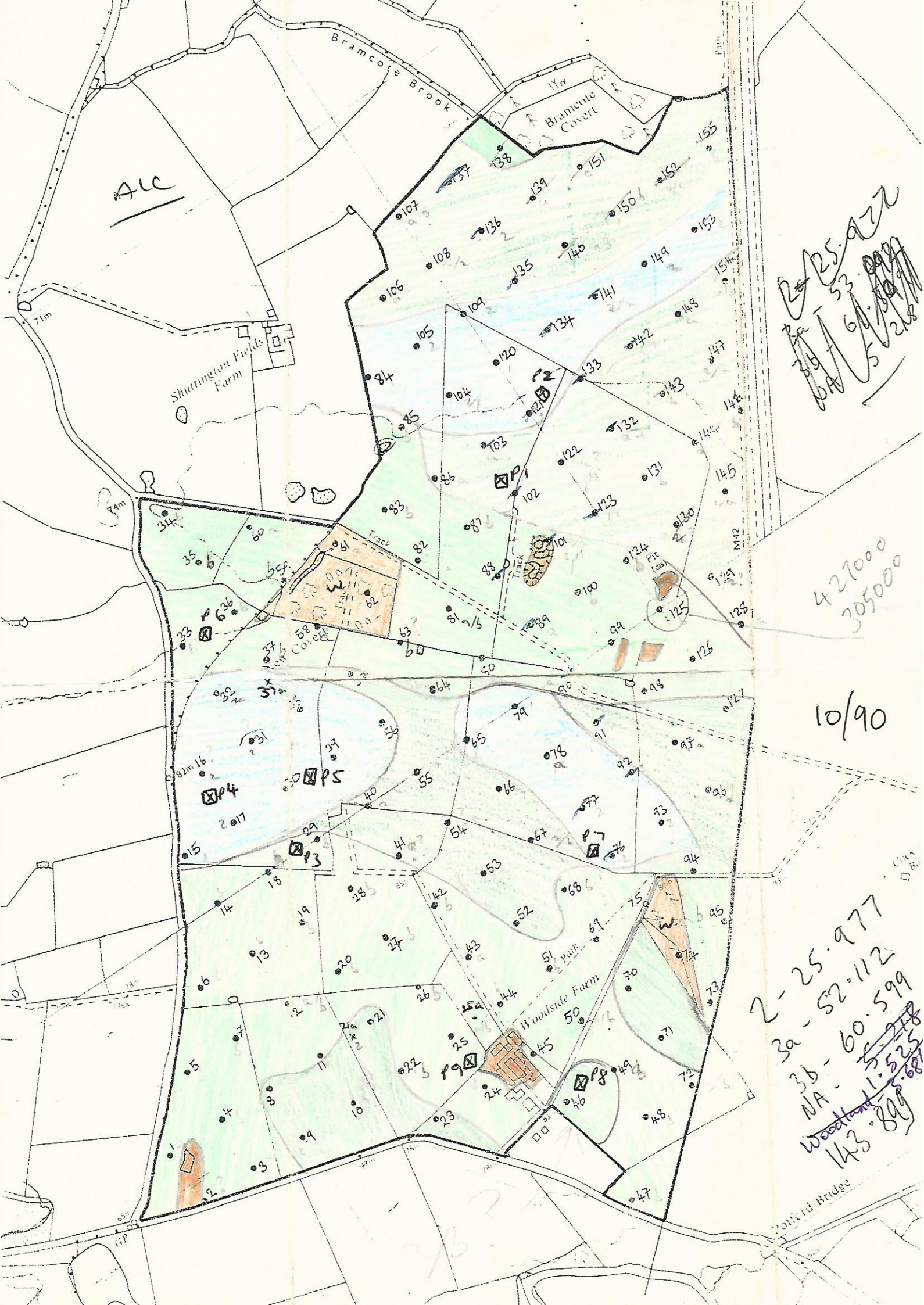

ALC

Shuttington Fields Farm

Bramcote Brook

Bramcote Covert

Tract

Woodside Farm

25.977
53
60
61
62
63
64
65
66
67
68
69
70
71
72
73
74
75
76
77
78
79
80
81
82
83
84
85
86
87
88
89
90
91
92
93
94
95
96
97
98
99
100
101
102
103
104
105
106
107
108
109
110
111
112
113
114
115
116
117
118
119
120
121
122
123
124
125
126
127
128
129
130
131
132
133
134
135
136
137
138
139
140
141
142
143
144
145
146
147
148
149
150
151
152
153
154
155

427000
305000

10/90

P4

P5

P3

P7

P7

P9

P8

2-25.977
3a-52-112
3b-60.599
NA-
Woodland 1.525
143-89

Potterford Bridge