

Agricultural Land Classification

SELBY LOCAL PLAN

Objectors Site SHB IV

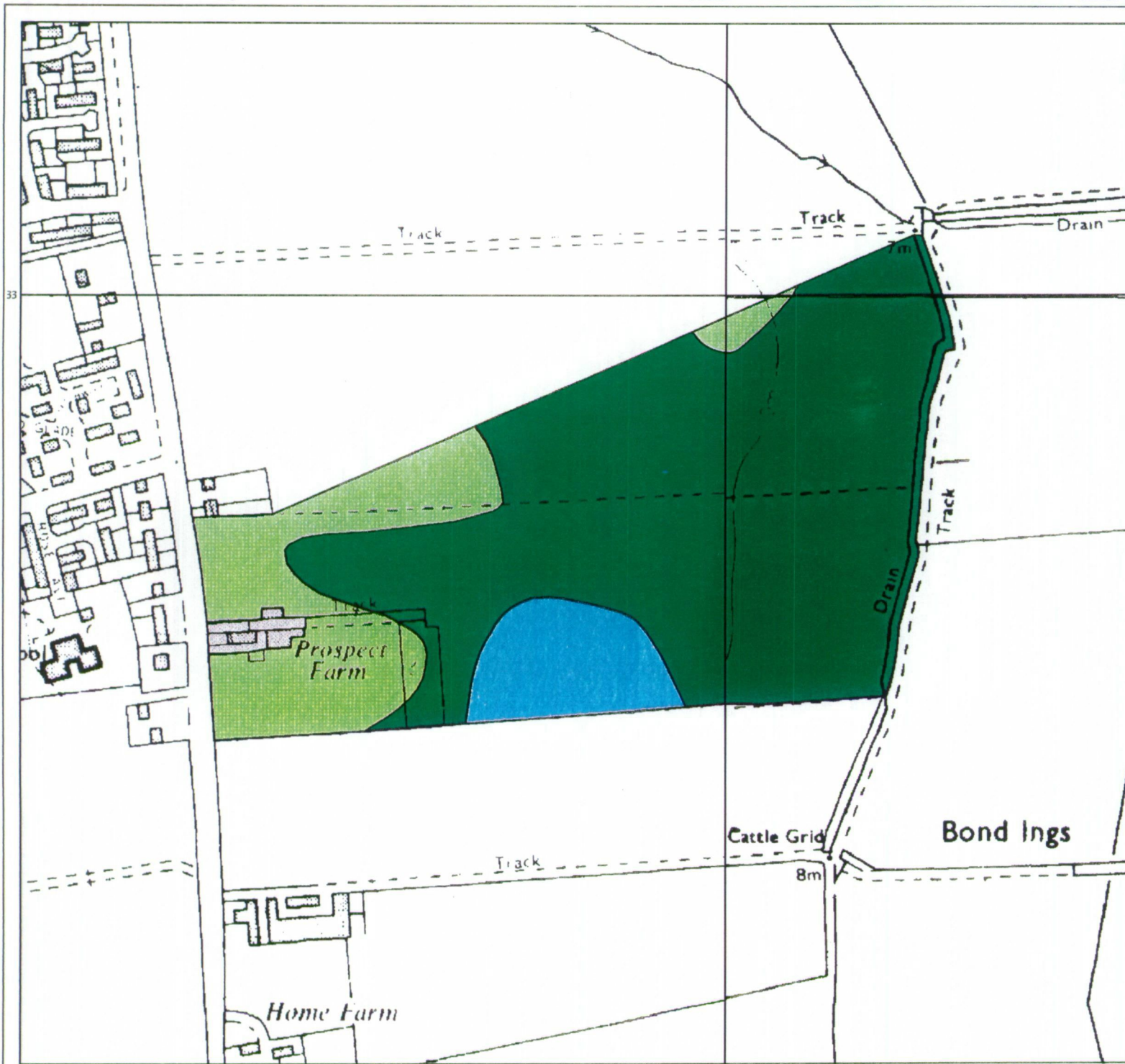

Legend

	Quality	Area (ha)
Grade 1	Excellent	Nil
Grade 2	Very Good	1.7
Grade 3a	Good	13.9
Grade 3b	Moderate	3.9
Grade 4	Poor	Nil
Grade 5	Very Poor	Nil
	Agricultural land not surveyed	Nil
	Other land	0.3
Boundary of survey area		
Total agricultural land area		19.5
Total survey area		19.8
* Not present within survey area		

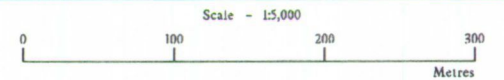



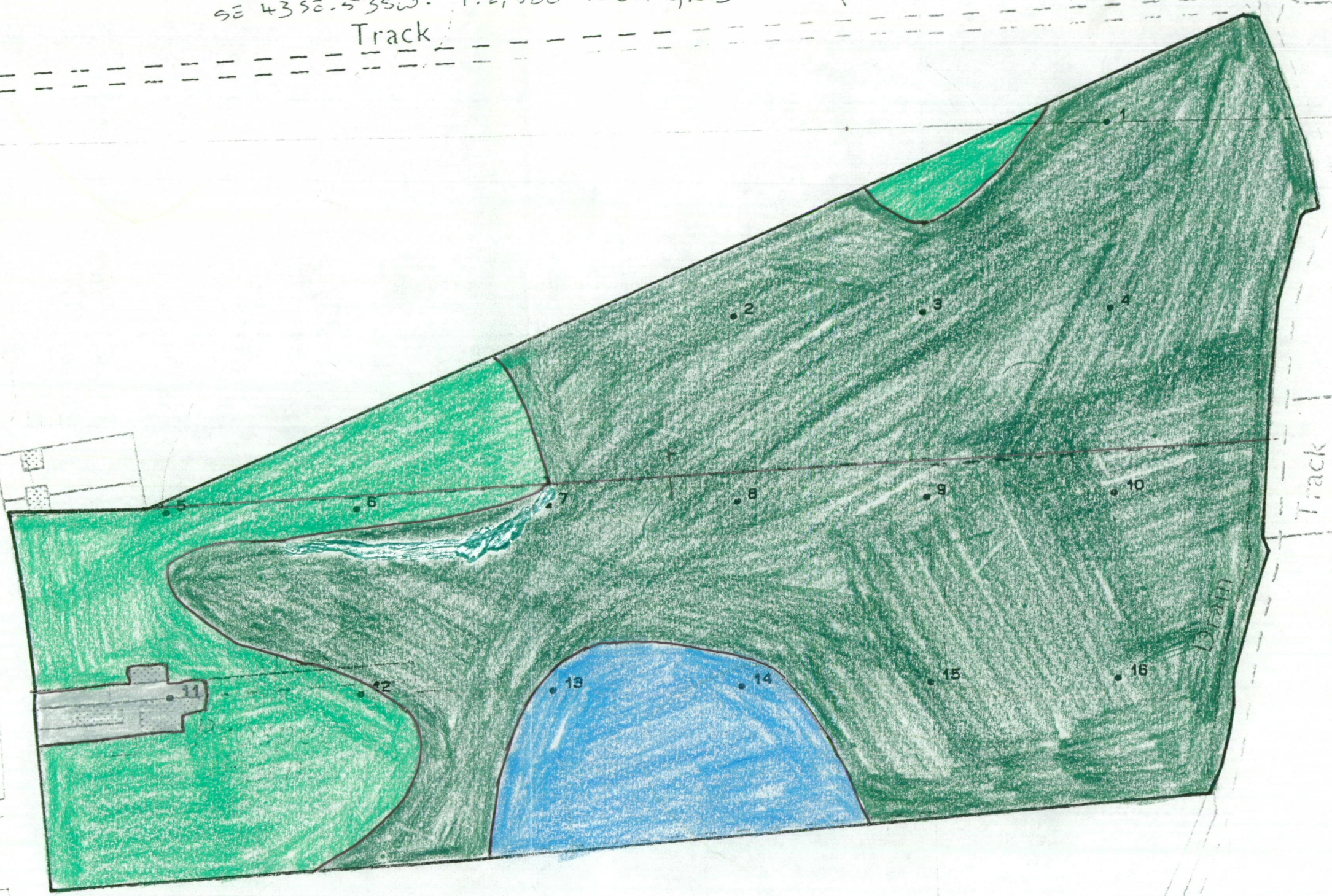
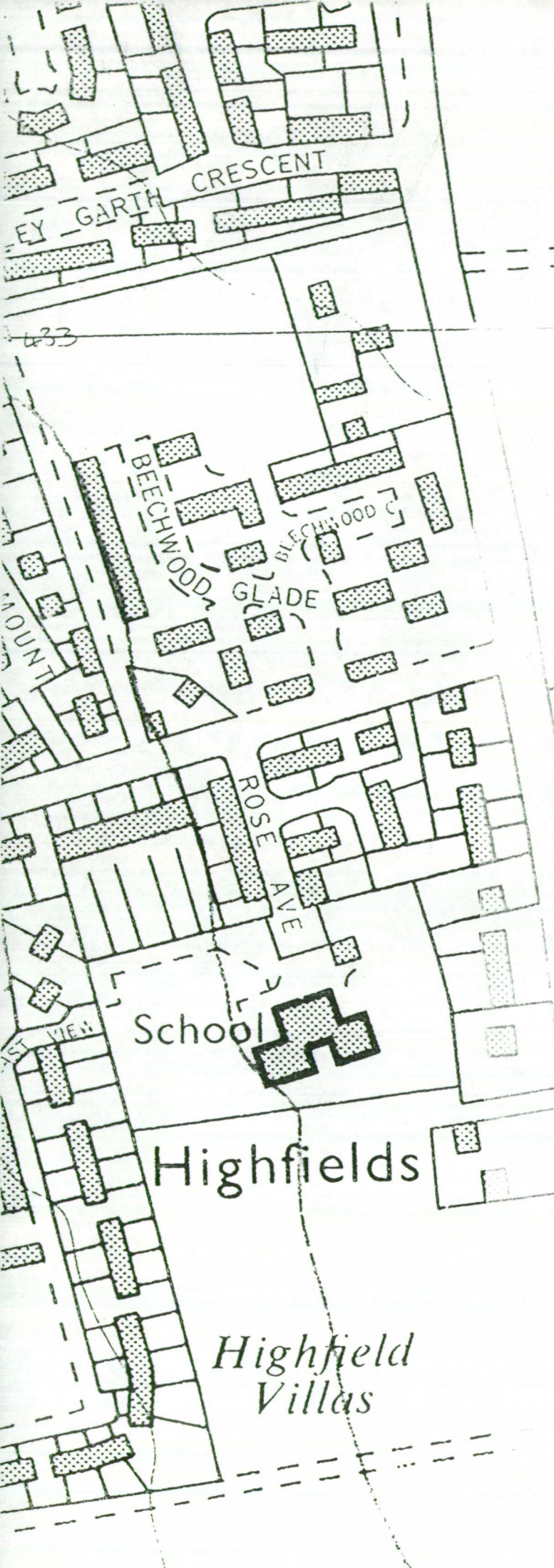

Further details contained in MAFF (1988) Agricultural Land Classification of England and Wales - Revised guidelines and criteria for grading the quality of agricultural land. Maff (publications), London SE99 7TP. The information is accurate at base map scale but any enlargement would be misleading. Reproduction in whole or in part by any means is prohibited without the prior permission of MAFF.

Surveyed and drawn by the Resource Planning Team, ADAS Statutory Unit, Leeds.
Based on the 1986 Ordnance Survey 1:10,000 map with the permission of the Controller of Her Majesty's Stationery Office. Unauthorised reproduction infringes Crown copyright and may lead to prosecution or civil proceedings. MAFF Licence No: GD272361
Source map(s): SE 43 SE, SE 53 SW
Reference no: 15/96 © Crown Copyright Reserved 1996

15/96 Selby LP. OS. site SHB IV
SE 43SE-53SW. 1:2,500 100M GRID
Track



- KEY
- Grade 2 
 - Subgrade 3a 
 - Subgrade 3b 
 - Other land 

Cattle Grid

8m

Bond Ir

450