

DARLINGTON LOCAL PLAN

Site 3, Neasham Road East

Agricultural Land Classification

| Agricultural Land | | |
|---|---------------------------|----------------------------|
| Agricultural Grades | Agricultural Land Quality | Area within the site (ha.) |
| GRADE 1 | Excellent | Nil |
| GRADE 2 | Very Good | Nil |
| GRADE 3 Sub Grade 3a Sub Grade 3b | Good Moderate | Nil 31.7 |
| GRADE 4 | Poor | Nil |
| GRADE 5 | Very Poor | Nil |

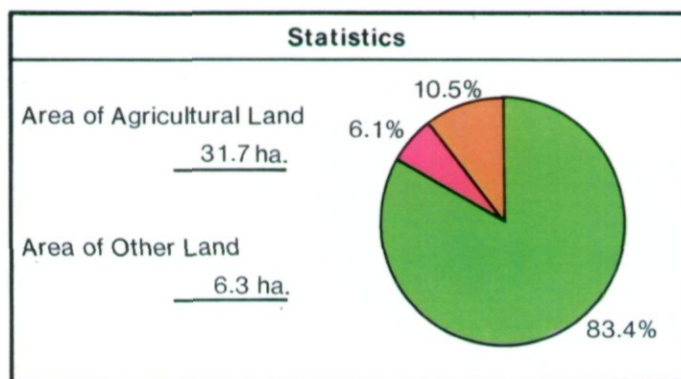

| Land in Other Categories | | |
|--|--|----------------------------|
| | | Area within the site (ha.) |
| Urban <i>Including housing, industry, commerce, derelict land, sports facilities, transport</i> | | 2.3 |
| Non-agricultural <i>Including golf courses, parks, sports fields, allotments, airfields</i> | | 4.0 |
| Woodland <i>Farm Woodland</i> | | Nil |
| Commercial Woodland | | Nil |
| Agricultural buildings <i>Including glasshouses</i> | | Nil |
| Open water | | Nil |
| Land not surveyed | | Nil |

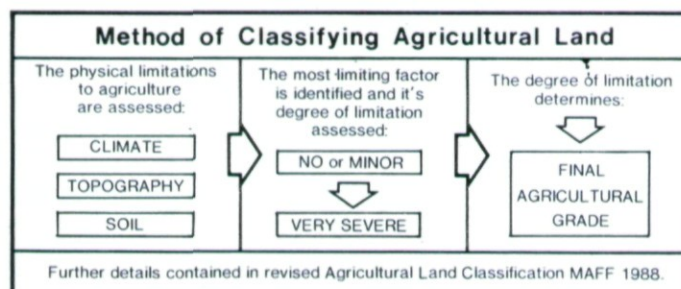

Information compiled by Resource Planning Team
ADAS Statutory Group Leeds.
Map produced by Resource Planning Cartographic Unit.
Project Number 72/93
Ordnance Survey maps reproduced with the permission of the Controller H.M.S.O.
© Crown Copyright Reserved 1993

SOURCE MAPS

1:10,000
NZ 21 SE NZ 31 SW

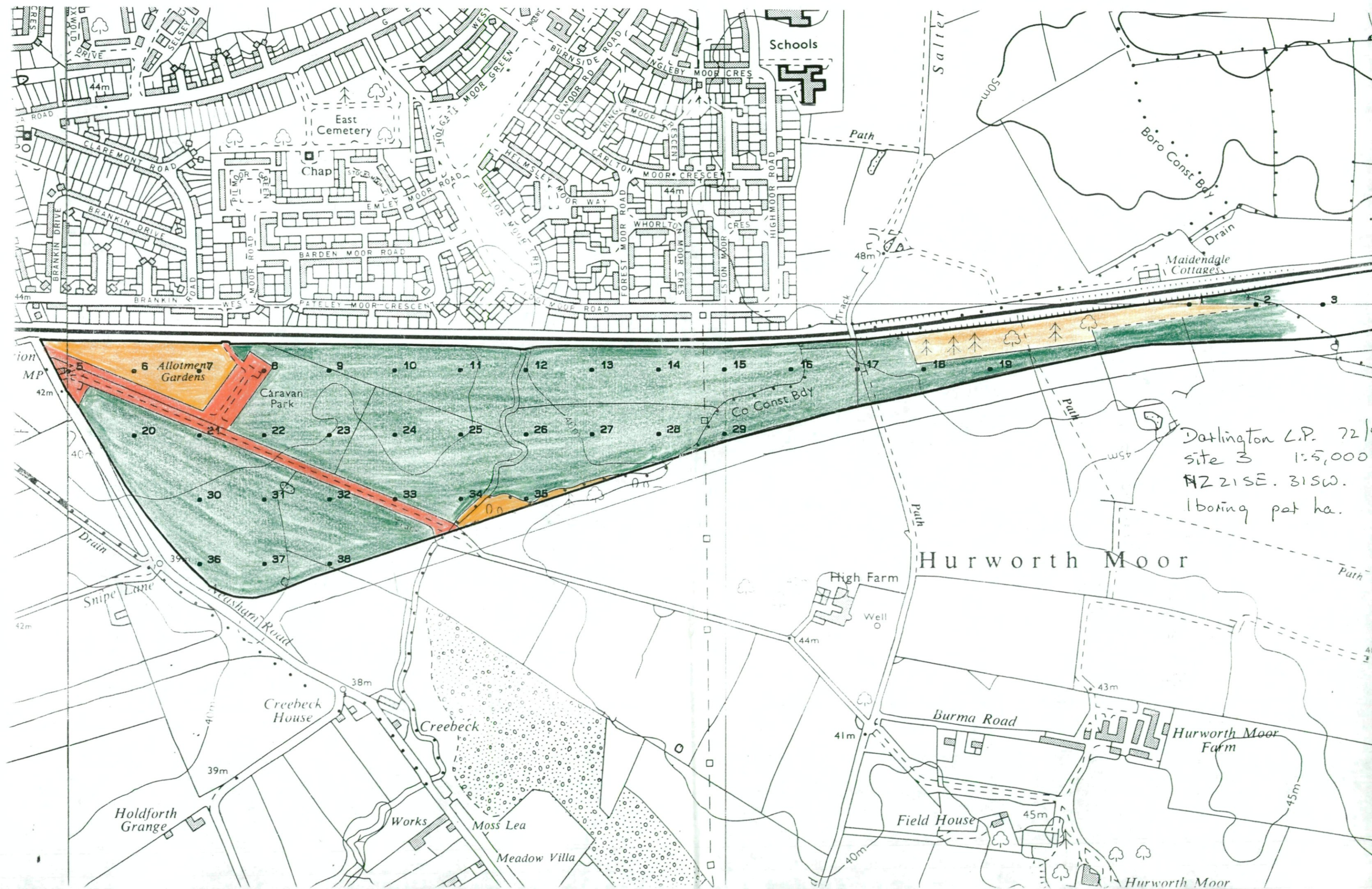

Darlington L.P. 72/
 site 3 1:5,000
 N221SE. 31SW.
 1 boring per ha.

Hurworth Moor

Hurworth Moor

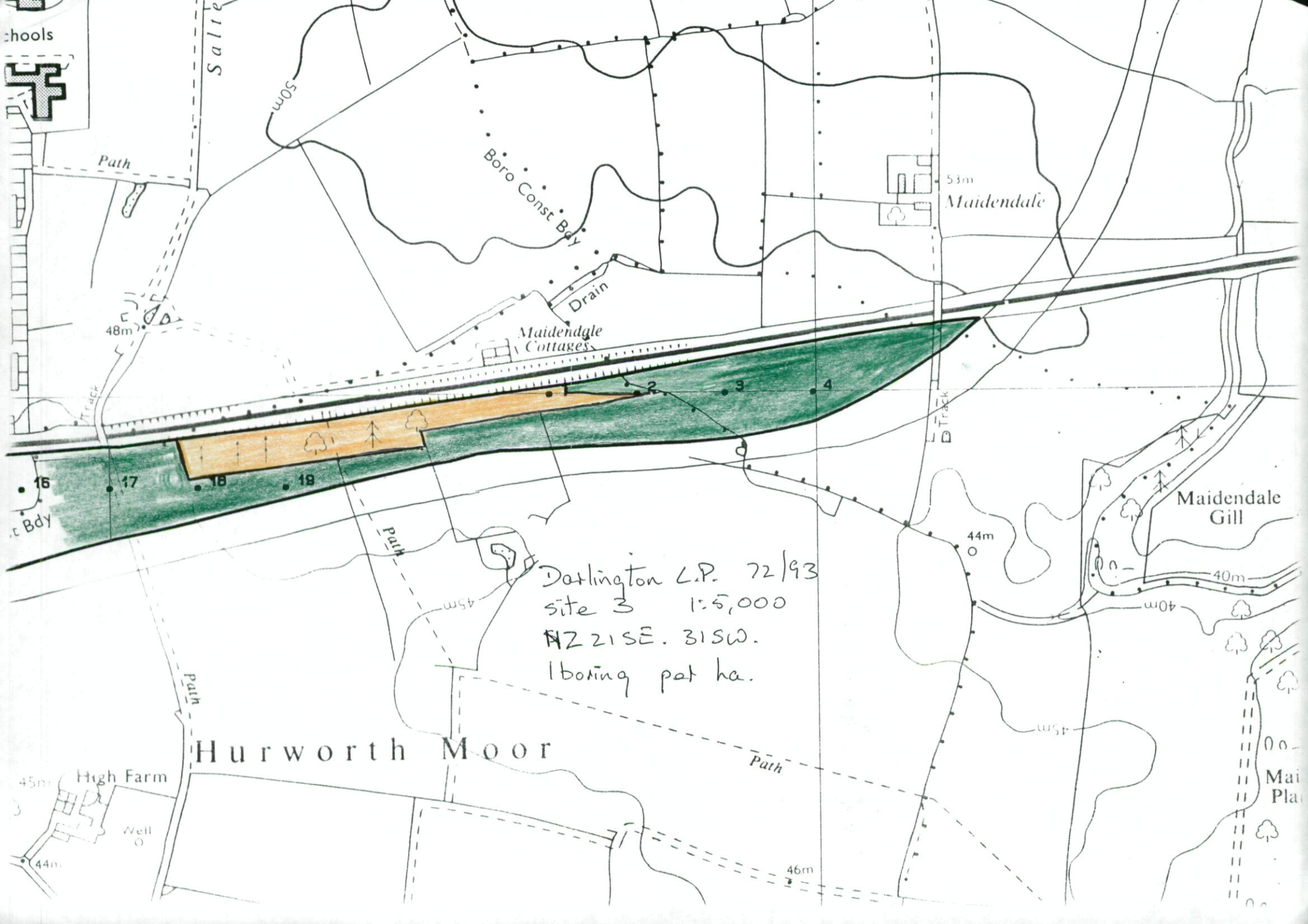

chools

Salter

50m

Boro Const Bdy

Path

53m

Maidendale

Drain

Maidendale Cottages

48m

Track

16

17

18

19

2

3

4

16 Bdy

Path

Maidendale Gill

Darlington L.P. 72/93
 site 3 1:5,000
 N21SE. 31SW.
 1 boxing pat ha.

44m

40m

40m

Path

Hurworth Moor

High Farm

Well

45m

44m

Path

46m

Mai Pla