

# SOUTH TYNESIDE UNITARY DEVELOPMENT PLAN

## Pikes Hole Farm (Site A)

### Agricultural Land Classification

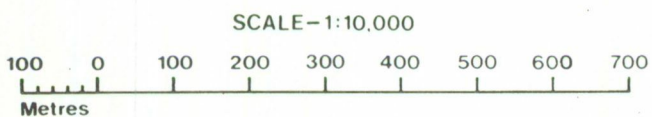

Agricultural Land		
Agricultural Grades	Agricultural Land Quality	Area within the site (ha.)
Grade 1	Excellent	Nil
Grade 2	Very Good	Nil
Grade 3	Good	7.08
	Moderate	129.35
Grade 4	Poor	Nil
Grade 5	Very Poor	Nil

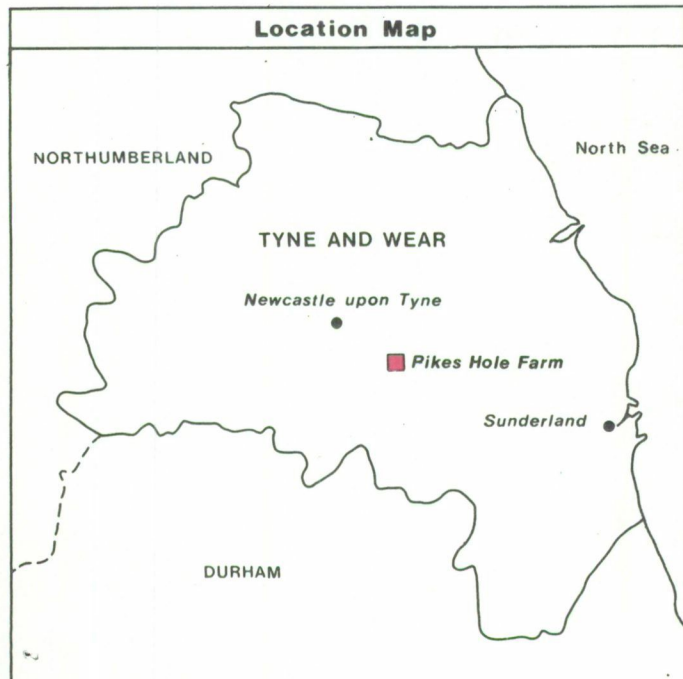
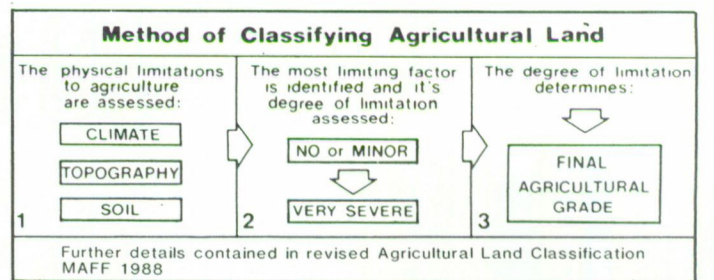

Land in Other Categories		Area within the site (ha.)
Urban <i>Including housing, industry, commerce, derelict land, sports facilities, transport.</i>		1.48
Non-agricultural <i>Including golf courses, parks, sports fields, allotments, airfields.</i>		3.34
Woodland <i>Farm woodland</i>		Nil
<i>Commercial woodland</i>		Nil
Agricultural buildings <i>Including glasshouses</i>		1.08
Open water		Nil
Land not surveyed		Nil

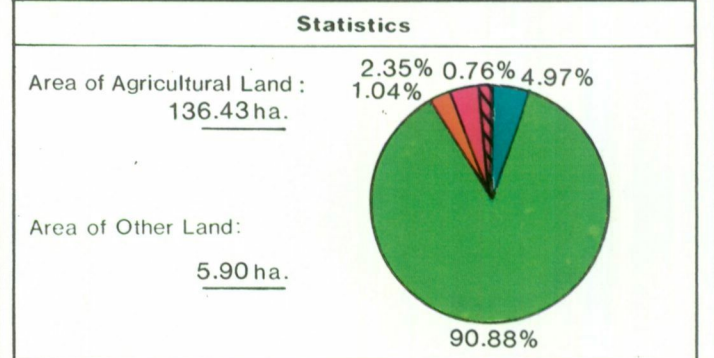

**MAFF** Ministry of Agriculture, Fisheries and Food.

Information compiled by Resource Planning Group, Farm and Countryside Service, Leeds R.O.  
Map produced by Resource Planning Cartographic Unit, Project Number 8/92  
Ordnance Survey maps reproduced with the permission of the Controller, H.M.S.O.  
© Crown Copyright Reserved 1992

**SOURCE MAPS**  
1:10,000  
NZ 36 SW

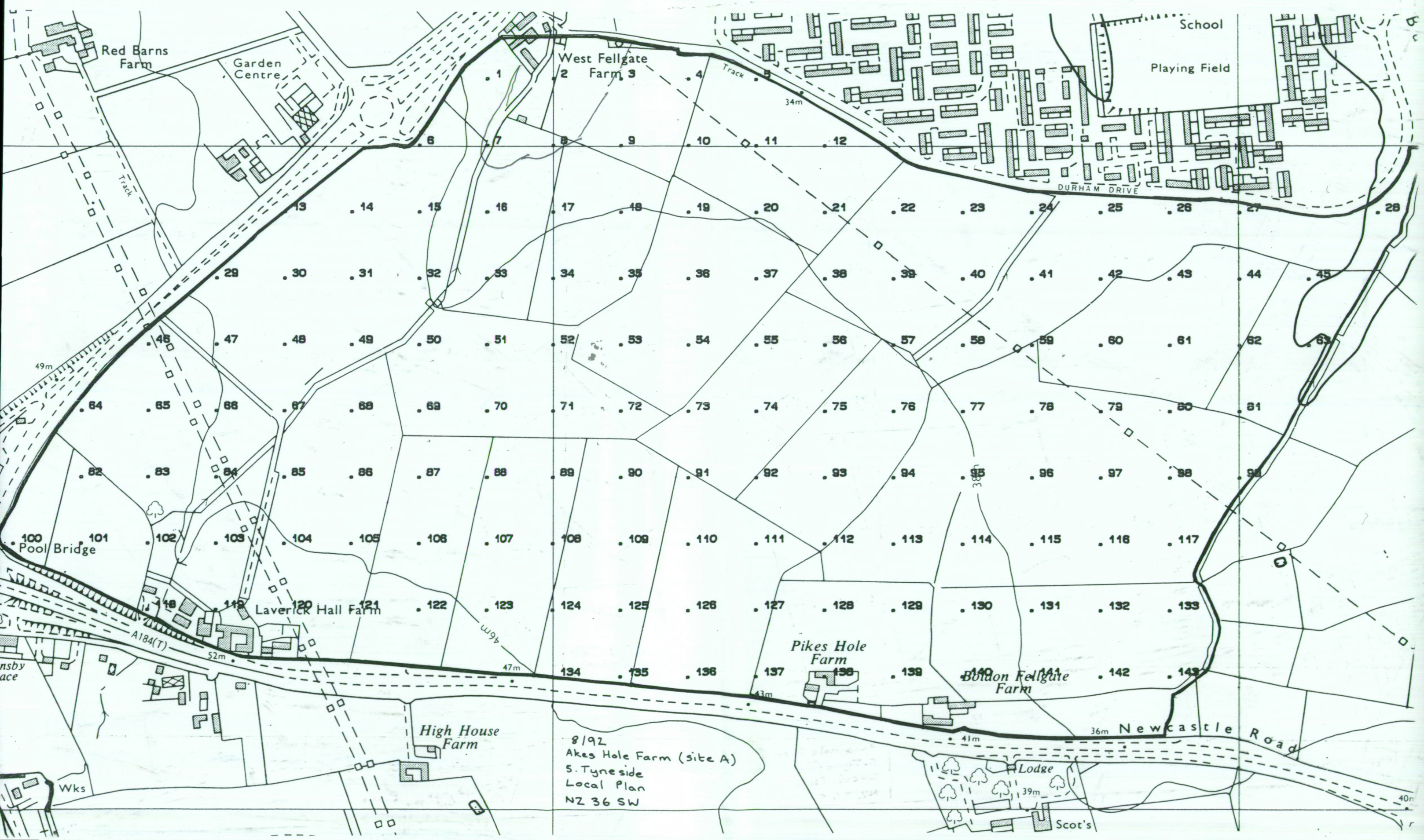

8192  
Akes Hole Farm (site A)  
S. Tyneside  
Local Plan  
NZ 36 SW