

Agricultural Land Classification

SELBY DISTRICT WIDE LOCAL PLAN

Site TAD /F, Tadcaster, N. Yorks.

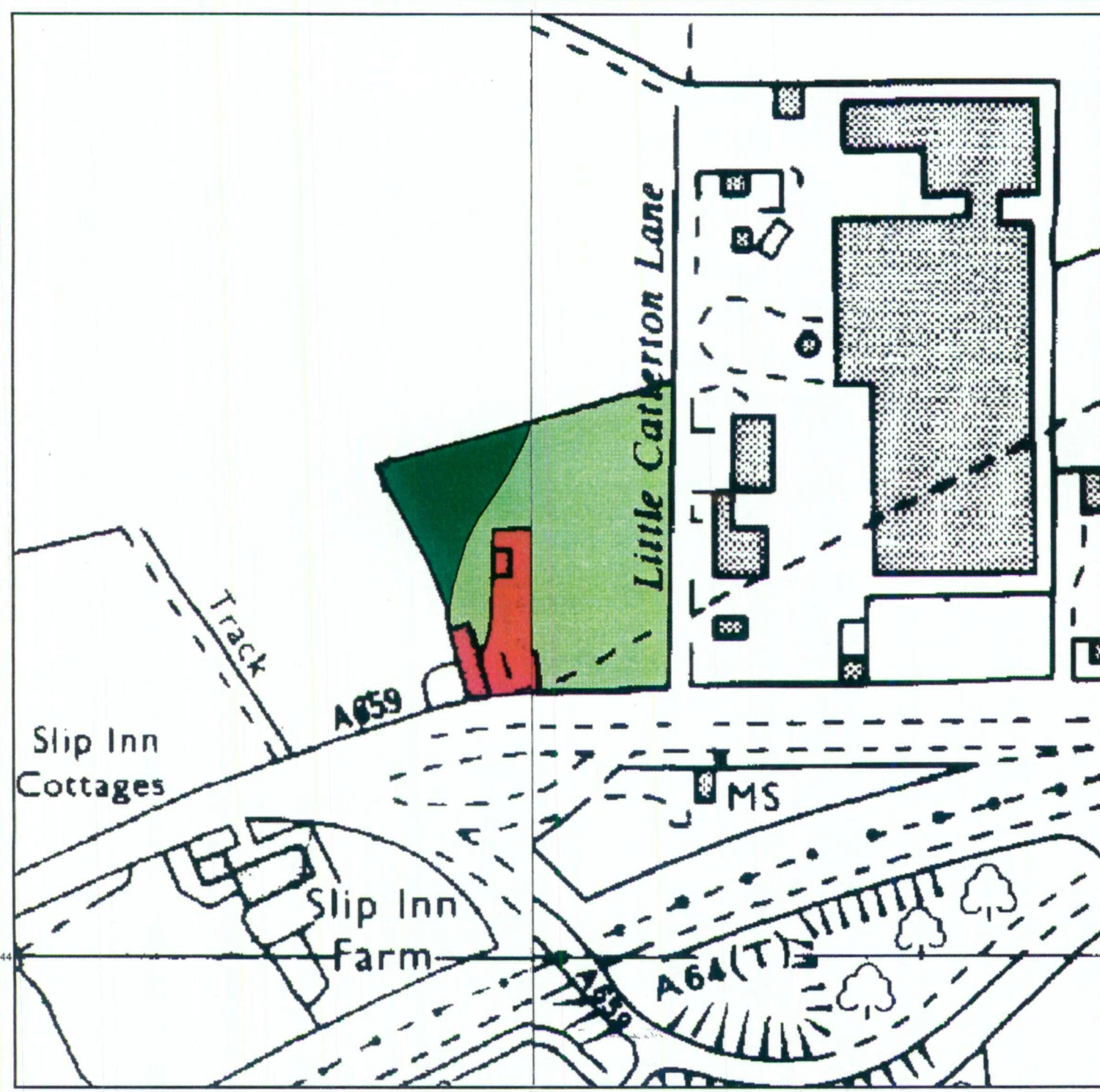

Agricultural Land

Grade	Quality	Area (ha)
1	Excellent	NIL
2	Very Good	NIL
3a	Good	0.2
3b	Moderate	0.9
4	Poor	NIL
5	Very Poor	NIL

Other Land Categories

Category	Area (ha)
Urban	0.2
Non-Agricultural	NIL
Woodland	NIL
Agricultural Buildings	NIL
Open Water	NIL
Not Surveyed	NIL

Total agricultural land area 1.1
Total survey area 1.3

* Grade/category not present within survey area

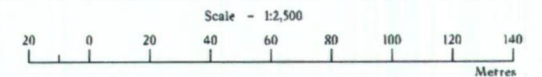

Further details contained in MAFF (1988) Agricultural Land Classification of England and Wales - Revised guidelines and criteria for grading the quality of agricultural land. MAFF (Publications), London SE99 7TP.

The information is accurate at the base map scale but any enlargement would be misleading.

Reproduction in whole or in part by any means is prohibited without the prior permission of MAFF.

Surveyed and drawn by the Resource Planning Team, ADAS Statutory Unit Leeds

Based on the 1983 Ordnance Survey 1:10,000 map with the permission of the Controller of Her Majesty's Stationery Office.



Source Map(s): SE 44 SE, SE 54 SW.

Reference no. 62/94

© Crown Copyright Reserved 1994.

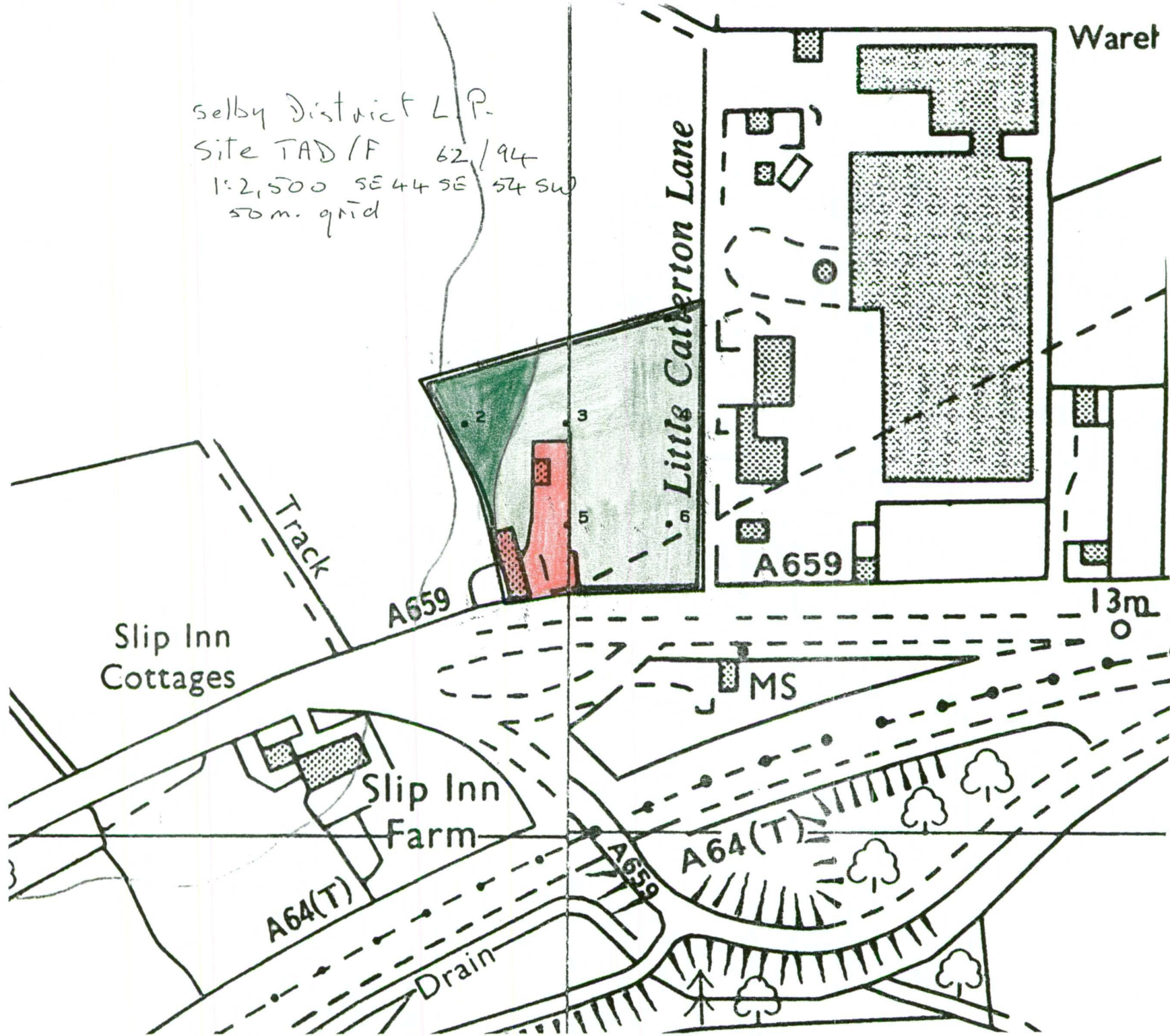
Selby District L.P.
Site TAD/F 62/94
1:2,500 SE 44 SE 54 SW
50 m. grid



-  - 3a
-  - 3b
-  - Urban