

Agricultural Land Classification

DEARNE LEA O.C.C.S.

Legend

	Quality	Area (ha)
Grade 1	Excellent	Nil
Grade 2	Very Good	Nil
Grade 3a	Good	Nil
Grade 3b	Moderate	13.1
Grade 4	Poor	5.8
Grade 5	Very Poor	Nil
	Agricultural land not surveyed	Nil
	Other land	1.2
Boundary of survey area		
Total agricultural land area		18.9
Total survey area		20.1
* Not present within survey area		

Scale - 1:5,000



Further details contained in MAFF (1988) Agricultural Land Classification of England and Wales - Revised guidelines and criteria for grading the quality of agricultural land. Maff (publications), London SE99 7TP. The information is accurate at base map scale but any enlargement would be misleading.

Reproduction in whole or in part by any means is prohibited without the prior permission of MAFF.

Surveyed and drawn by the Resource Planning Team, FRCA, Leeds.

Based on the 1983 Ordnance Survey 1:10,000 map with the permission of the Controller of Her Majesty's Stationery Office. Unauthorised reproduction infringes Crown copyright and may lead to prosecution or civil proceedings. MAFF Licence No: GD272361

Source map(s): SE 21 SE

Reference no: 20/97

© Crown Copyright Reserved 1997

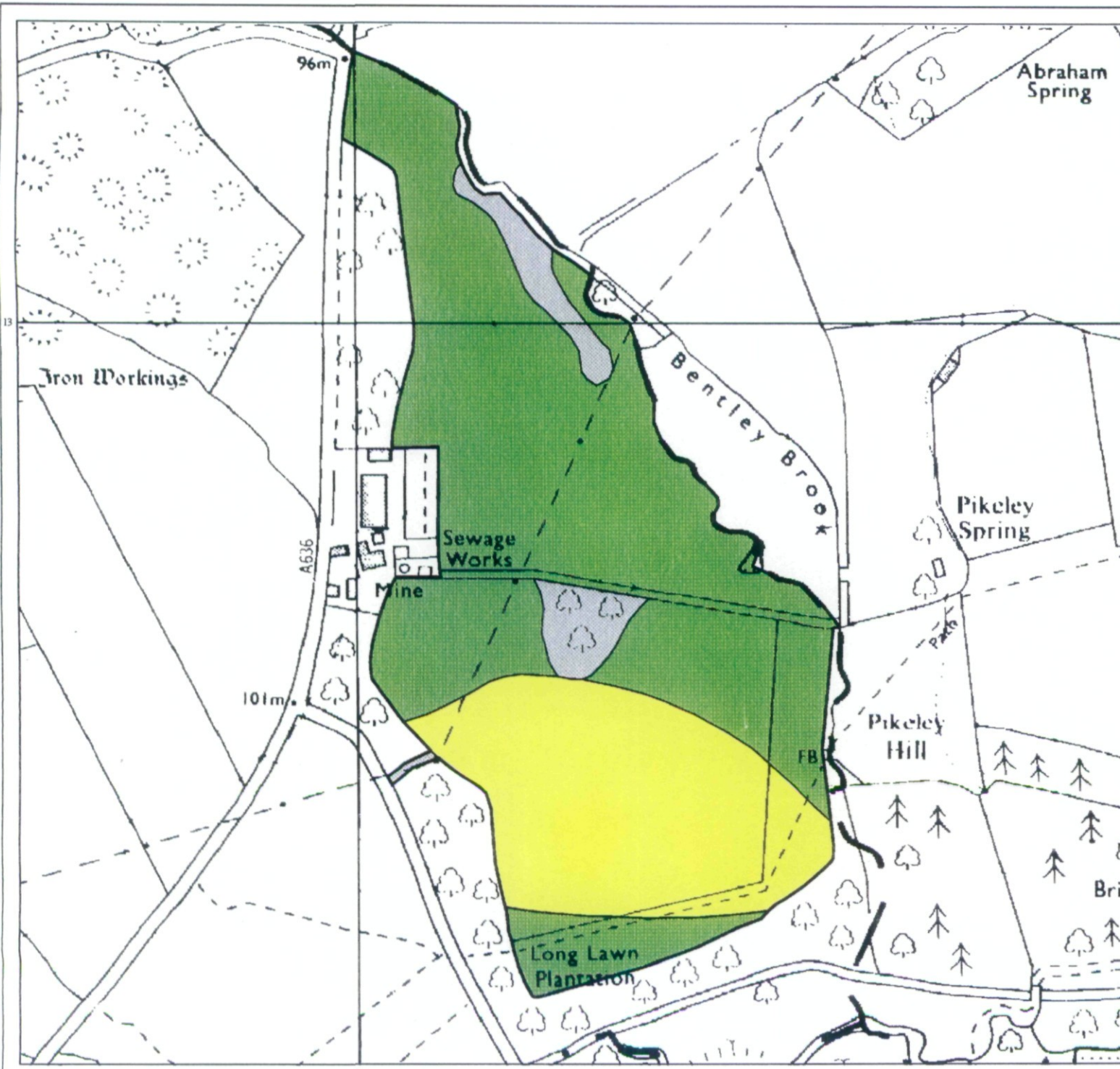

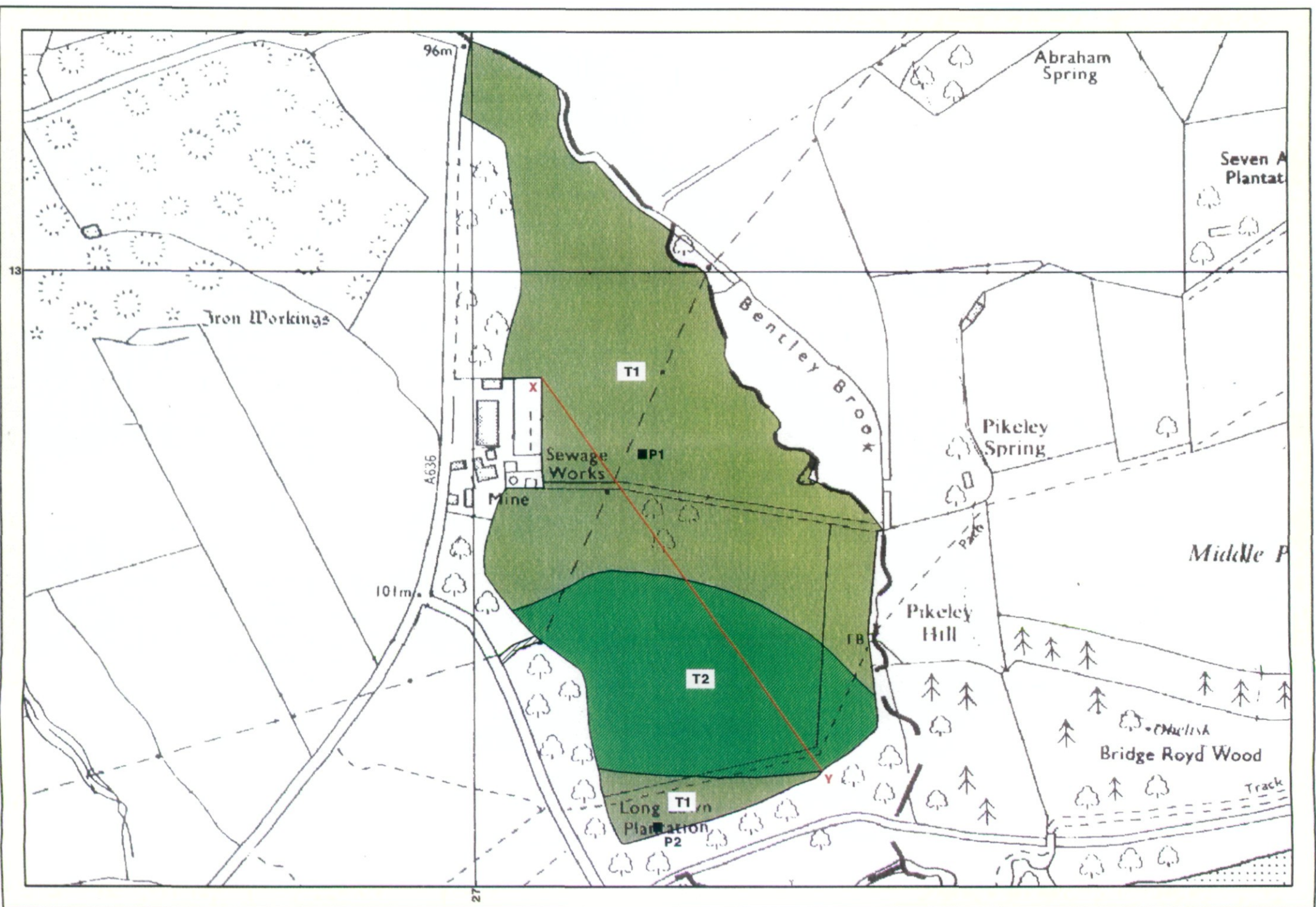

DEARNE LEA O.C.C.S.

Topsoil Resource Map

Unit	Soil Texture	Soil Thickness(cm.)			Area (ha)	Volume* (000m ³)
		Min	Median	Max		
T1	Medium	5	20	35	14.2	28.4
T2	Heavy	20	25	30	5.8	14.5

*Volume at Median Soil Thickness

No Topsoil Resources



Soil Pits



Scale - 1:5,000

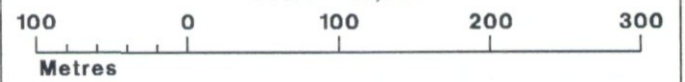

Ministry of Agriculture,
Fisheries and Food.

Based upon the 1983 1:10,000 Ordnance Survey maps SE 21 SE with the permission of the Controller of Her Majesty's Stationery Office.
Project Number: 20\97
Information compiled by ADAS Resource Planning Team, Leeds Statutory Centre.
Map produced by ADAS Resource Planning Team Cartographic Unit, Leeds Statutory Centre
Unauthorised reproduction infringes Crown Copyright and may lead to civil proceedings.
© Crown copyright. MAFF Licence GD272361.

Diagrammatic Section across Site

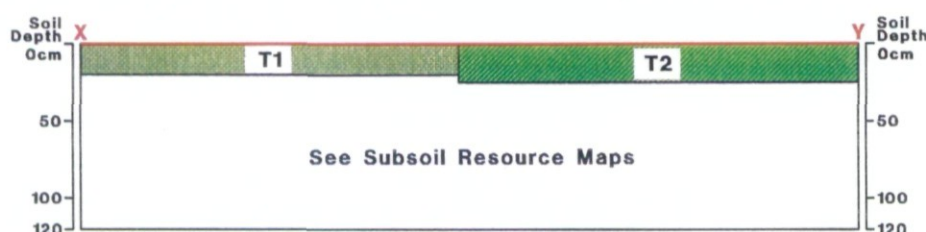



DEARNE LEA O.C.C.S.

Upper Subsoil Resource Map

Unit	Soil Texture	Mean Soil Thickness(cm.)	Area (ha)	Volume* (000m ³)
U1	Medium \ Heavy	16	18.7	29.9

No Subsoil Resources Colliery Overburden 

Soil Pits 

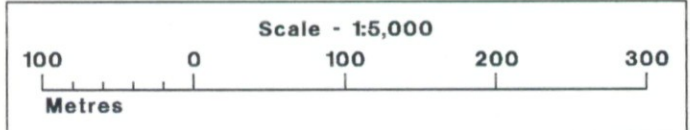

Ministry of Agriculture,
Fisheries and Food.

Based upon the 1983 1:10,000 Ordnance Survey maps SE 21 SE with the permission of the Controller of Her Majesty's Stationary Office.
Project Number: 20\97
Information compiled by ADAS Resource Planning Team, Leeds Statutory Centre.
Map produced by ADAS Resource Planning Team Cartographic Unit, Leeds Statutory Centre
Unauthorised reproduction infringes Crown Copyright and may lead to civil proceedings.
© Crown copyright. MAFF Licence GD272361.

Diagrammatic Section across Site

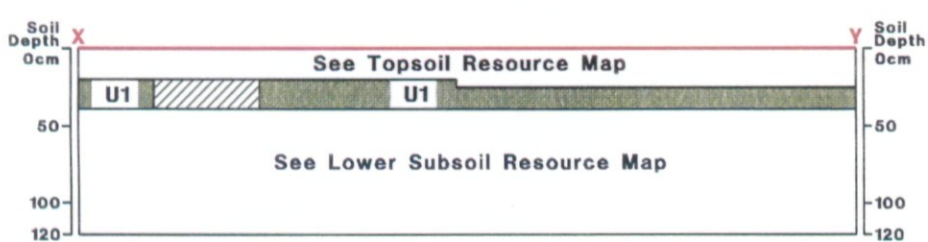

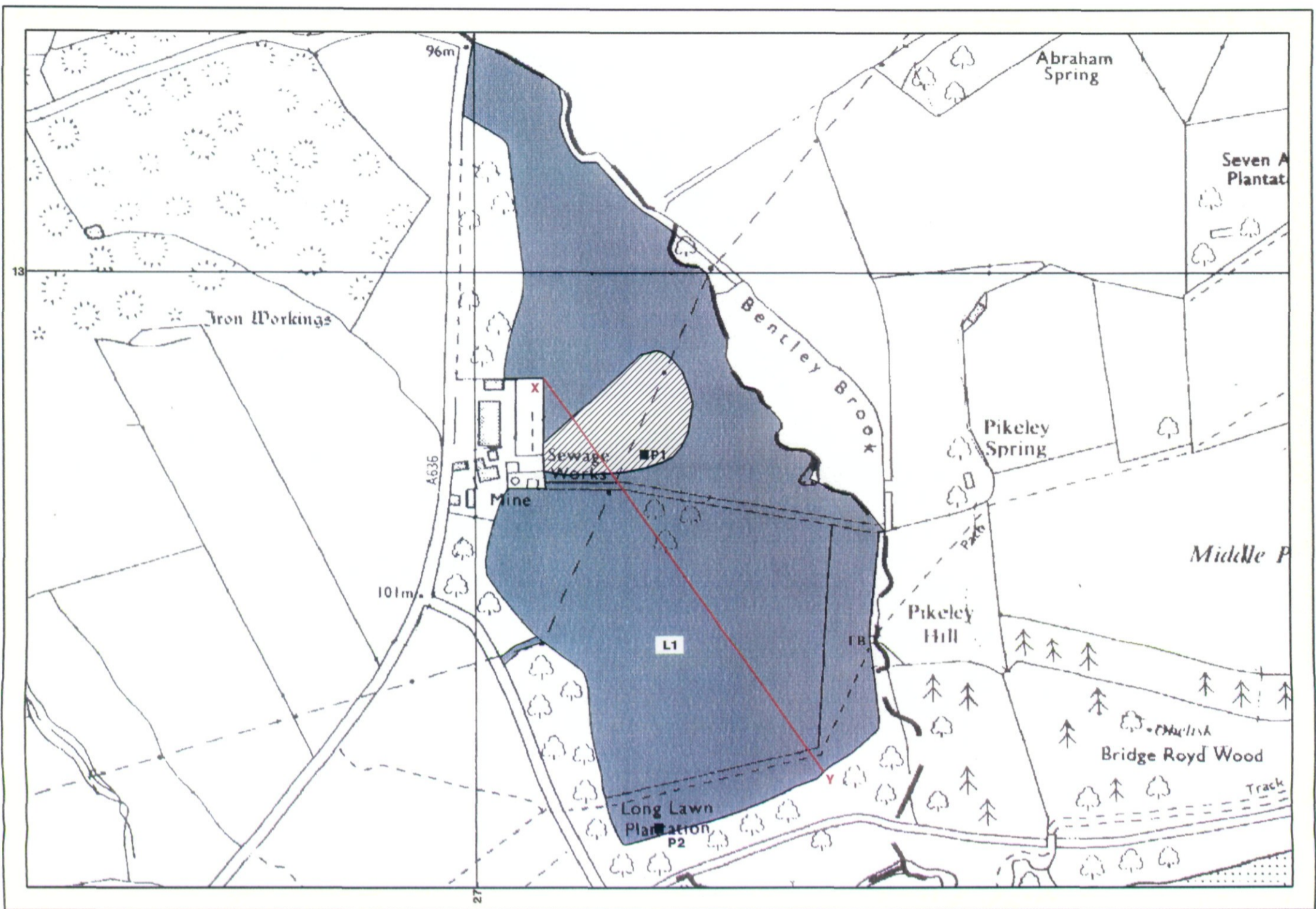

DEARNE LEA O.C.C.S.

Lower Subsoil Resource Map

Unit	Soil Texture	Mean Soil Thickness(cm.)	Area (ha)	Volume* (000m ³)
L1	Heavy	71	18.7	132.8

No Subsoil Resources Colliery Overburden	
Sandstone	
Soil Pits	■ P1

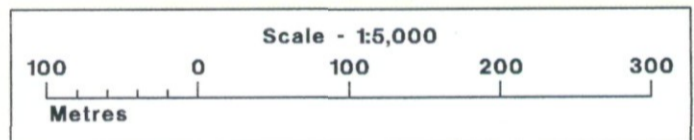

Ministry of Agriculture,
Fisheries and Food.

Based upon the 1983 1:10,000 Ordnance Survey maps SE 21 SE with the permission of the Controller of Her Majesty's Stationery Office.
Project Number: 20\97
Information compiled by ADAS Resource Planning Team, Leeds Statutory Centre.
Map produced by ADAS Resource Planning Team Cartographic Unit, Leeds Statutory Centre
Unauthorised reproduction infringes Crown Copyright and may lead to civil proceedings.
© Crown copyright. MAFF Licence GD272361.

Diagrammatic Section across Site

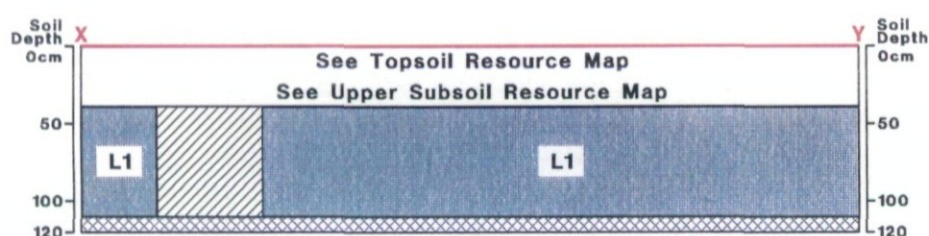

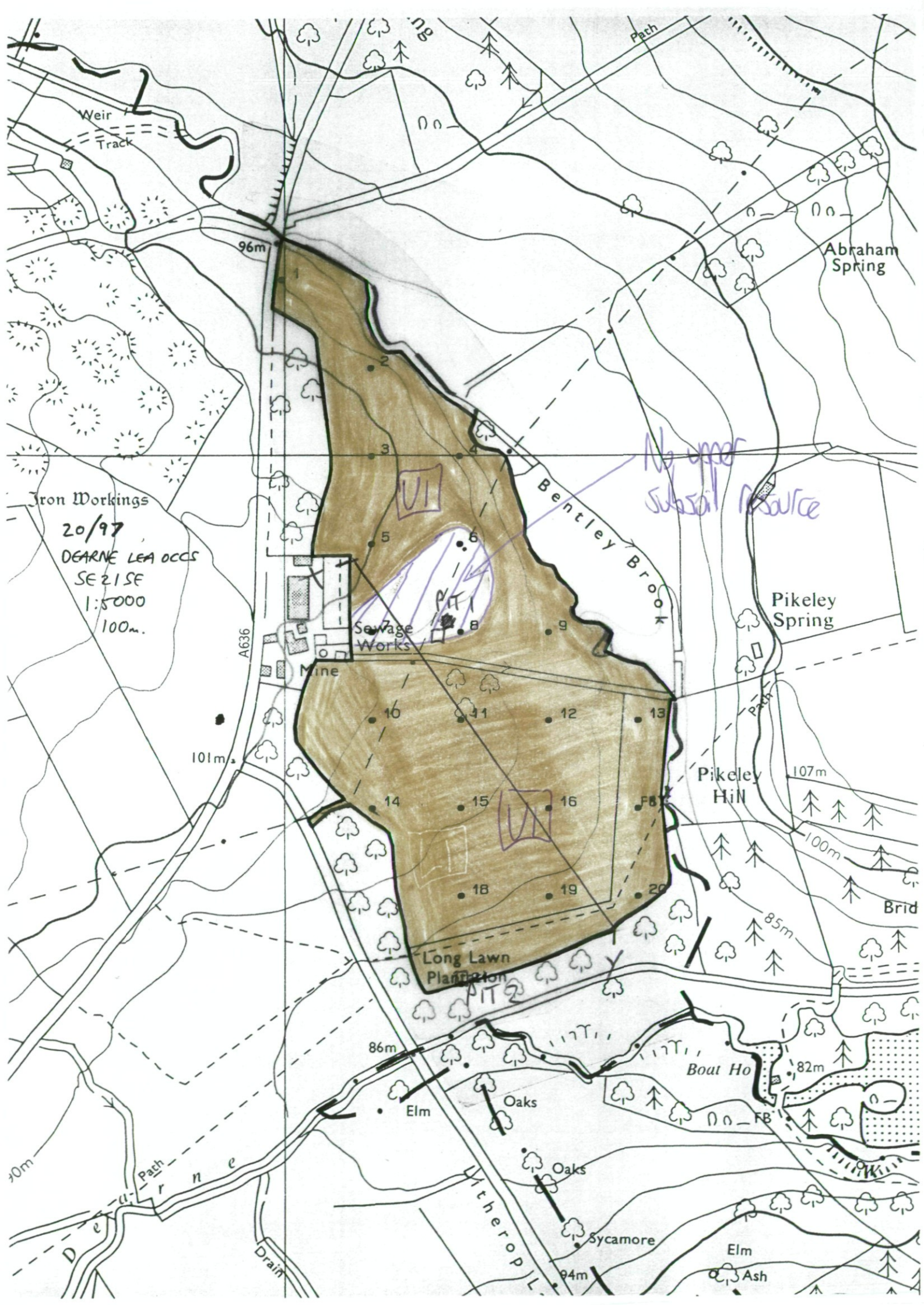

No upper
Subsoil Resource

Iron Workings
20/97
DEARNE LEA OCCS
SE 21 SE
1:5000
100m.

Sewage Works

Mine

Long Lawn
Plantation

PIT 2

86m

Elm

Oaks

Oaks

Sycamore

Elm

Ash

Abraham Spring

Pikeley Spring

Pikeley Hill

107m

100m

85m

82m

Bentley Brook

Boat Ho

FB

FB

96m

101m

A636

Drain

Pach

Drain

Wetherop L.

94m

70m

Drain

Brid